





Part Number:
1990281, 1990274, 1990276

Models:
Himalayan 411
Scram 411
Scram 440

- 

WARNING: Royal Enfield genuine accessories are designed to fit only the specific Royal Enfield motorcycle(s) that are specified above. They should not be fitted to any other type of motorcycle. Pay particular attention to the warnings and cautions contained in this instruction, failure to do so may result in an incorrect installation of the accessory which could result in an unsafe riding condition and possible accident. If in any doubt always seek help from your authorised Royal Enfield dealer.
- 

WARNING: Before starting any accessory kit installation ensure the motorcycle is supported in a stable condition. Failure to support the motorcycle correctly could lead to motorcycle damage or personal injury.
- 

WARNING: All fixings must be tightened to the torque values specified in this instruction. Failure to tighten fixings to the correct torque could result in an unsafe riding condition and possible accident
- 

CAUTION: Care should be taken when fitting any accessory kit. Incorrect handling of kit components or the use of incorrect tools could lead to component or motorcycle damage.
- NOTE:** The content of this instruction is subject to change at any time without notice or liability. Royal Enfield reserves the right to revise the information presented at any time.

Parts Supplied: 1990274, 1990276



Item	Description	Qty
1	Left hand pannier	1
2	Right hand pannier	1

Parts Supplied: 1990281

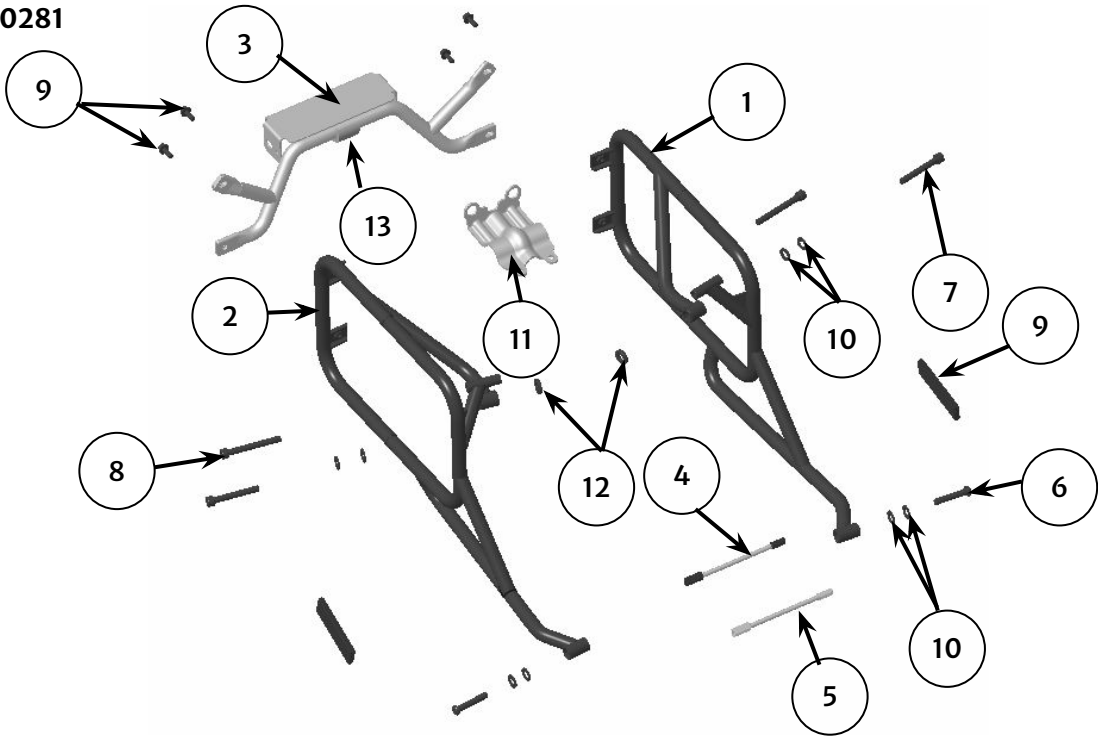

Item	Description	Qty
1	Left hand pannier rail	1
2	Right hand pannier rail	1
3	Connector bar	1
4	Extension harness (red connectors)	1
5	Extension harness (green connectors)	1
6	Fixing, M8 x 45mm	2
7	Fixing, M8 x 60mm	2
8	Fixing, M8 x 70mm	2
9	Fixing, M6x16mm	4
10	Washer, M8	8
11	Tail light bracket	2
12	Spacer	2
13	Rubber Mount	1

Installing the Pannier Rails

1 Remove the rider and pillion seats and disconnect the battery as described in the Owner's Manual.

2 Remove the rear mudguard assembly (1) by first removing the five fixings located on the underside of the rear mudguard (2), and then the two fixings located beneath the seat area (3) along with the number plate hanger. Retain the fixings for reuse and carefully place the rear mudguard assembly on the rear tyre.



4mm hexagonal bit and ratchet



5mm hexagonal bit and ratchet
10mm socket and ratchet

3 Carefully lower the infill panel from the underside of the rear mudguard and disconnect the right hand indicator harness (green) (1) and left hand indicator harness (red) (2) from the main wiring harness.

4 Remove the rear indicators (1). Retain the fixings (2) and nuts (3) for reuse.



6mm hexagonal bit and ratchet
12mm spanner

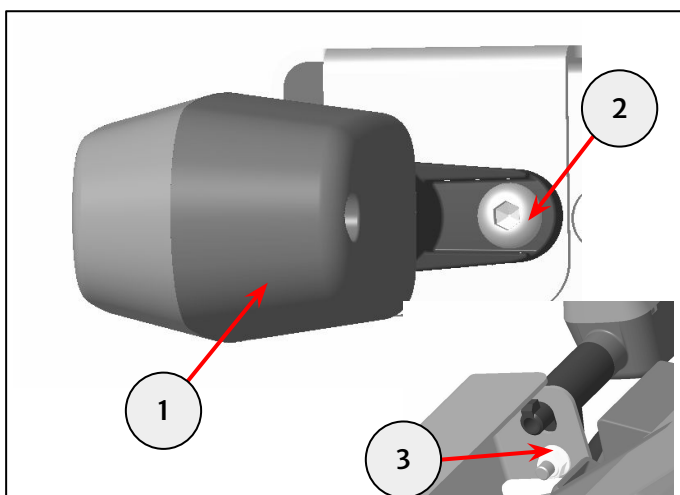
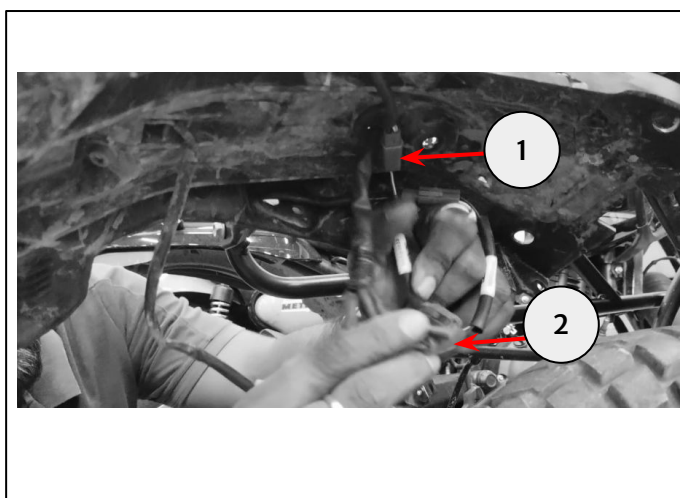
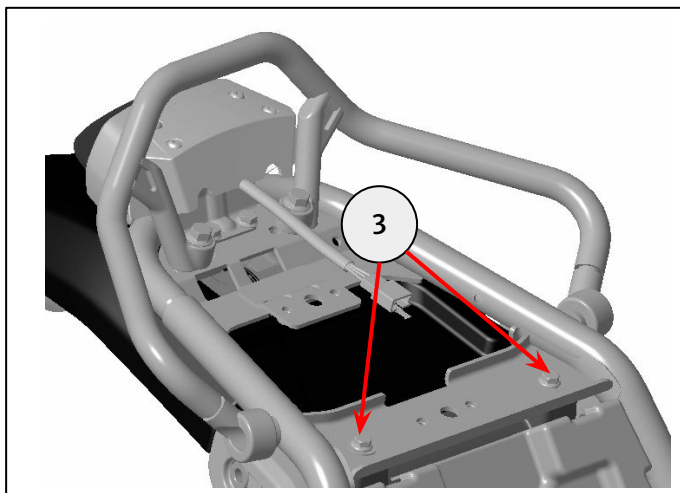
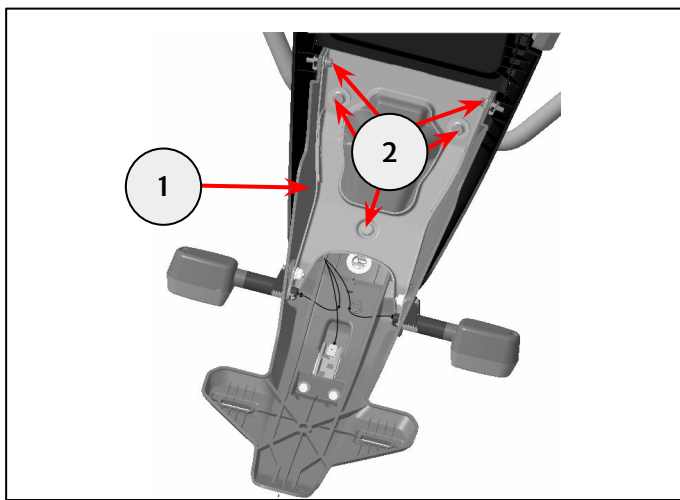

5 Remove the front luggage rack fixings (1) from both sides. Retain the fixings for reuse if the motorcycle is to be returned to its original condition.

Remove the rear saddle bag mounting fixings (2) from both sides. Retain the fixings for reuse.



6mm hexagonal bit and ratchet

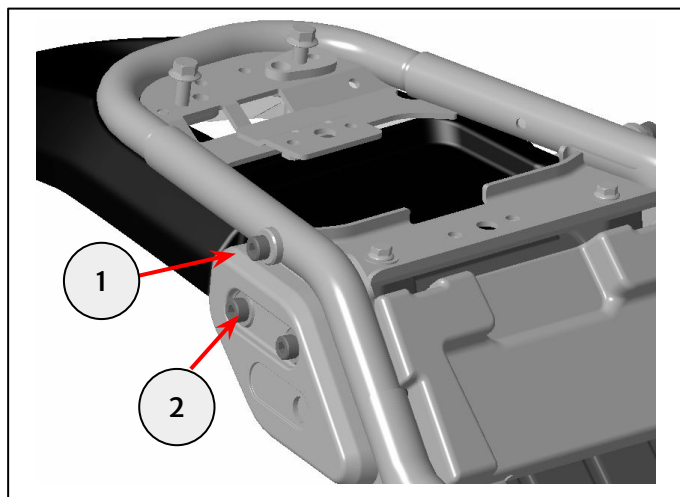

6 Loosen the grab rail (1) rear fixings (2). Do not remove the fixings.



13mm Bi-hexagonal socket and ratchet

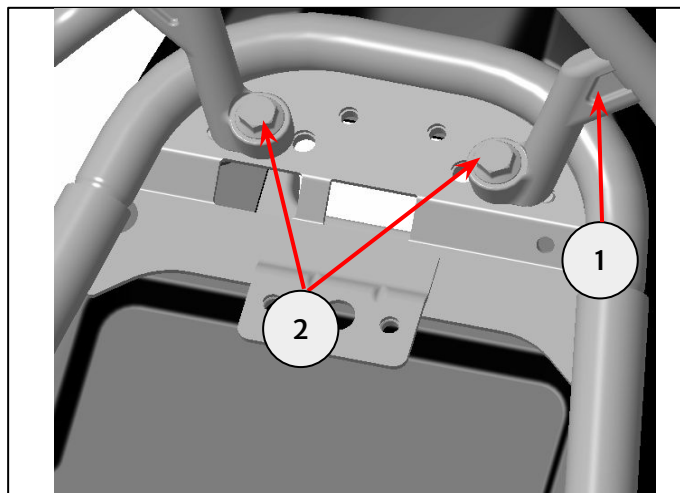

7 Position the right hand pannier rail (1) onto the motorcycle ensuring the top rear mounting (2) is correctly located in the luggage rack mounting recess (3) as shown.

Align the pannier rail front mounting (4) with the fixing position on the motorcycle frame (5) and loosely fit an M8x45mm fixing (6) and two M8 washers (7) from the kit.

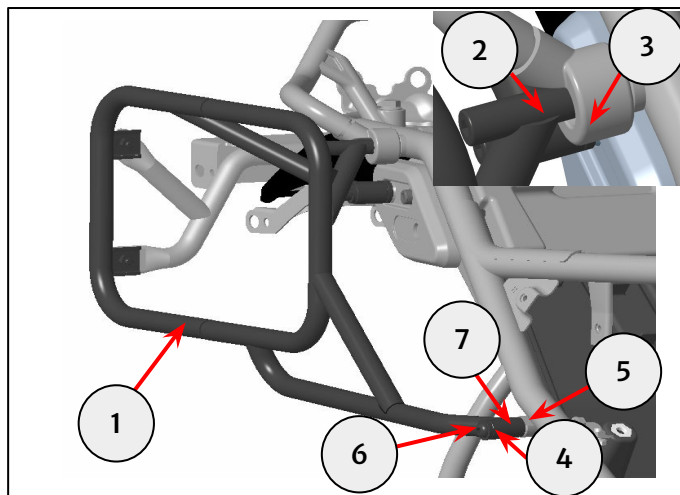

5mm hexagonal bit and ratchet

8 Fit an M8x70mm fixing (1) from the kit through the mount position shown (2). Fit an M8x60mm fixing (3), two M8 washers (4) and spacer (6) through the mount position shown (5). Assemble the fixing removed in step 5 (7) into the saddle mounting and tighten to 22Nm.

Do not fully tighten any pannier rail fixings at this stage. Repeat the steps 7 and 8 for the left hand pannier rail.

Note: It is mandatory to fit the spacer (6) in Scram 411 & 440 vehicles to ensure correct pannier fitment. Spacer fitment is not required for Himalayan vehicles.

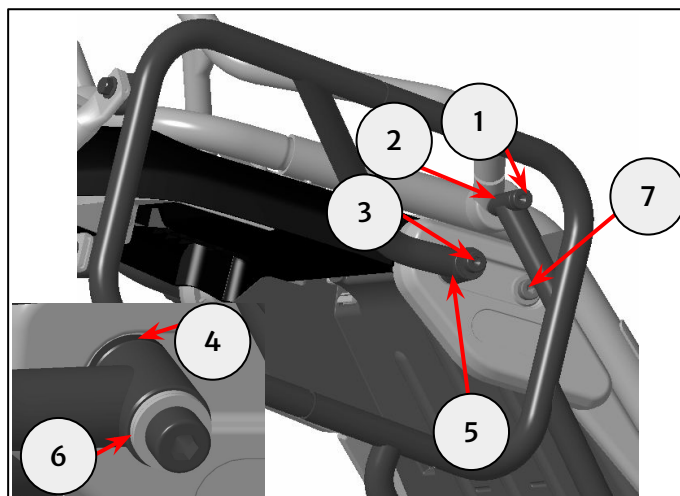

6mm hexagonal bit and torque wrench

9 Disconnect the rear light harness connector from the main wiring harness (3). Remove the two rear light mounting bracket (1) M6 x 16mm fixings (2). Retain the fixings for reuse.



8mm Bi-Hexagonal socket with ratchet
(For fixing 2)

Note: Rear light relocation (Step 9 to 16) is required for Europe/India vehicles not required for US vehicles.

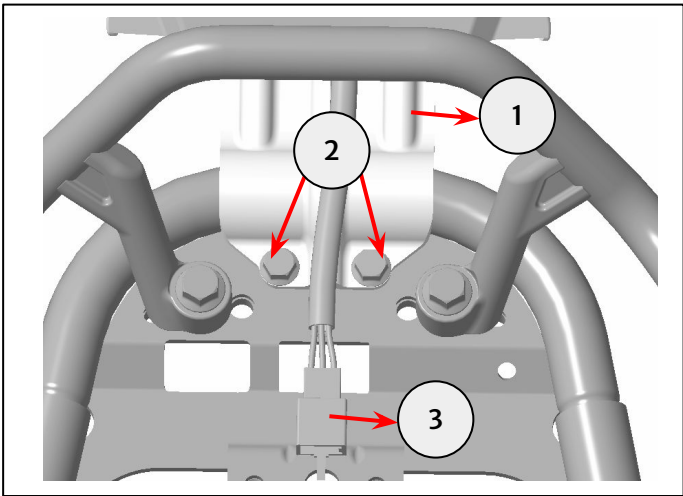

10 Remove the two lower M5x14mm rear light the fixings (1). Retain the fixings for reuse.



3mm hexagonal bit and ratchet

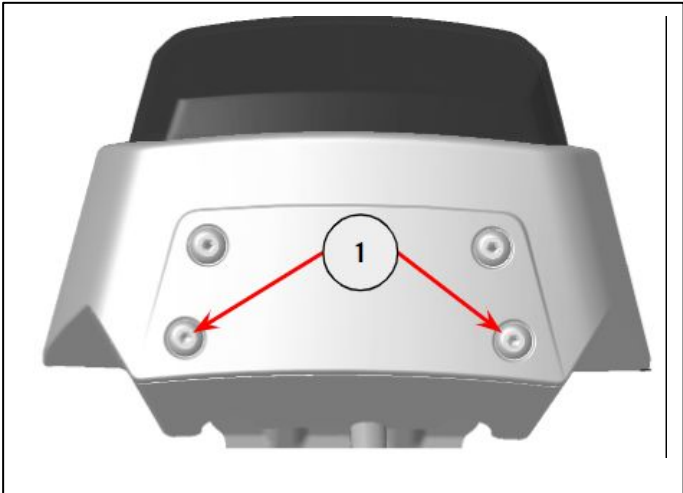

11 Carefully release the retaining clips (1) securing the front cover (2) of the rear light housing. Retain the front cover for reuse.

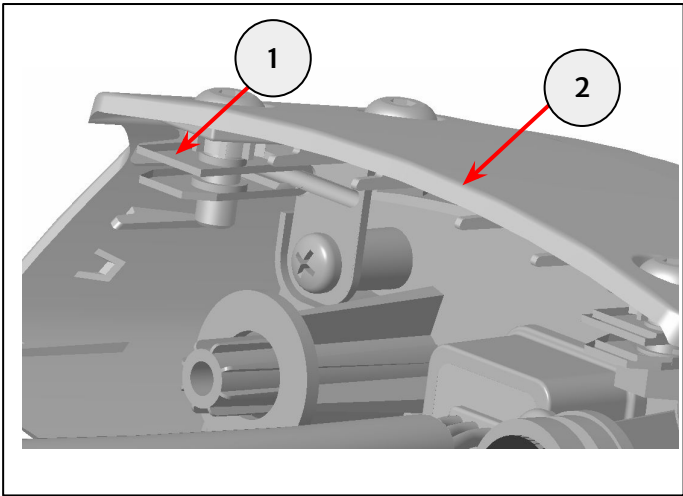

12 Remove the two self tapping fixings (1) and washers (2) from the rear light housing. Retain the fixings and washers for reuse. Remove the rear light mounting bracket (3) from the rear light housing.



Pozi-drive (PZ2) with ratchet

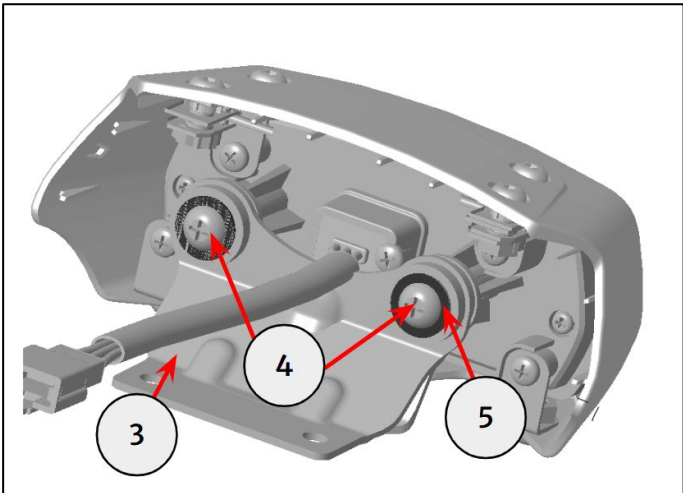

13 Remove the grommets (1) from the original rear light mounting bracket and fit them in to the rear light mounting bracket (2) from the kit as shown. Retain the original rear light mounting bracket for reuse if the accessory panniers are removed.

Note: Longer rear light mounting bracket for Himalayan, Scram 411(1) and shorter one for Scram 440(2)

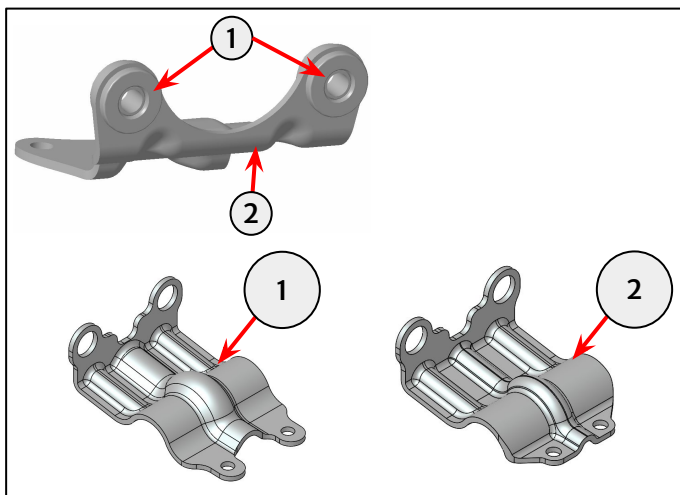

14 Fit the original larger washers (1) on to the rear light housing mounting flanges (2). Fit the rear light mounting bracket (3) on to the rear light housing in the orientation shown. Fit the original self tapping fixings (4) and smaller washers (5). Tighten the fixings to 2Nm.

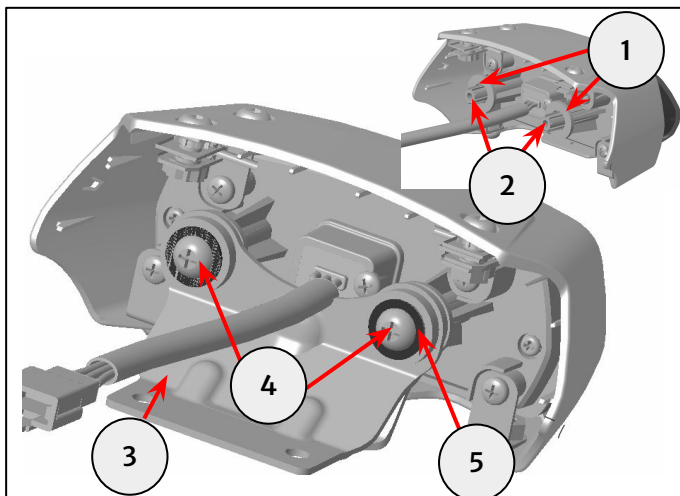

15 Refit the rear light housing front cover (1) and clip in to position. Refit the two original M5 x 14mm fixings. Tighten the fixings to 2Nm.

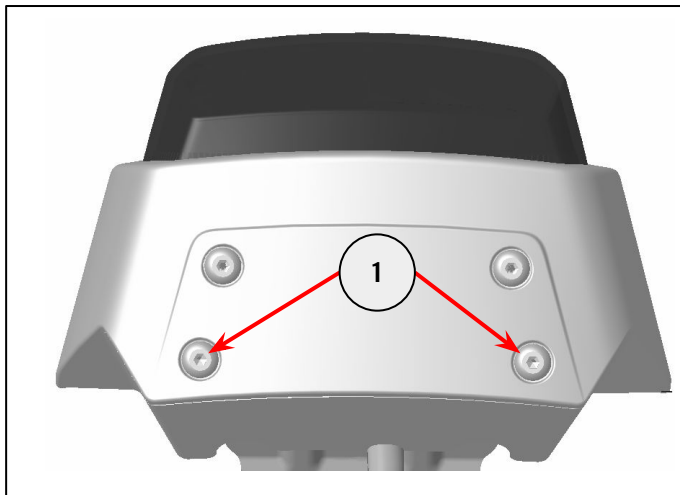

16 Refit the rear light assembly ensuring the rear light harness (1) is correctly located under the rear light mounting bracket (2), as shown. Fit the original M6x16mm fixings (3) and tighten to 10 Nm. Reconnect the rear light harness connector (4) to the main wiring harness (5).

Note: Fit rear light mounting bracket for Himalayan and Scram 411 vehicles. Refer step 13 for the type of relocation bracket

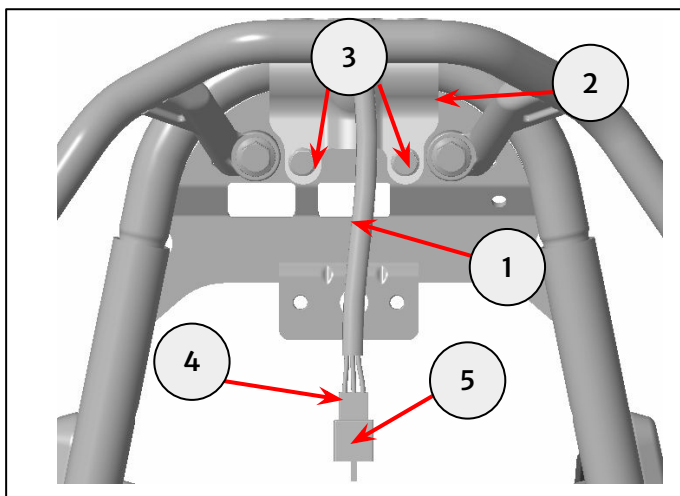

17 Strap the wiring harness routing as shown. Ensure that the excess of the wiring harness routing cable is folded and tape it. Use cable strap from the dealer end.

Note: Wiring harness routing and cable strap are mandatory for Scram 411 and 440 vehicles.

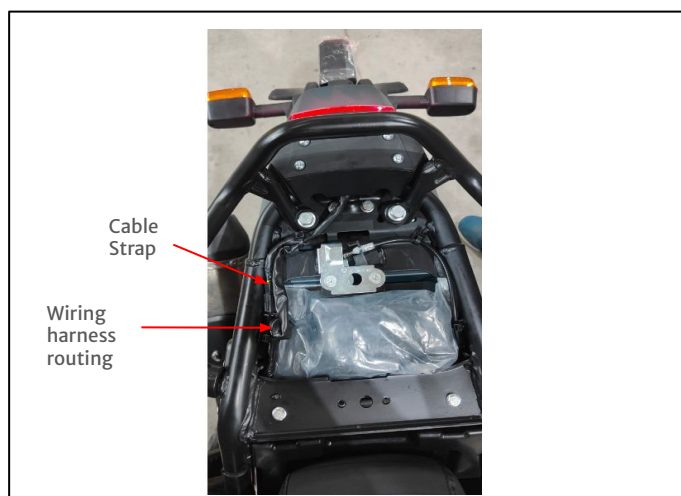

18 Assemble the rubber mount (1) into the centre of the connector tube assembly (2) as per the shown image.

Note: Rubber mount assembly is mandatory only for Scram 411 and 440 vehicles.

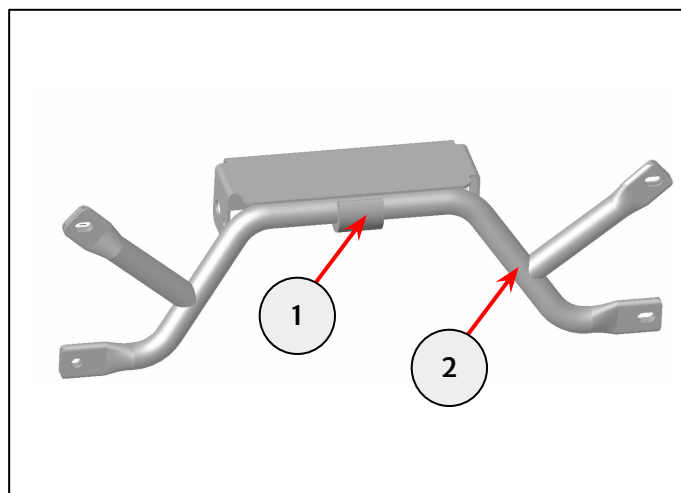

19 Align the rear connector bar (1) with the fixing positions on the RH (2) and LH (3) pannier rails. Fit the M6x15mm fixings (4) from the kit to secure the connector bar to the pannier rails. Do not fully tighten the fixings at this stage.

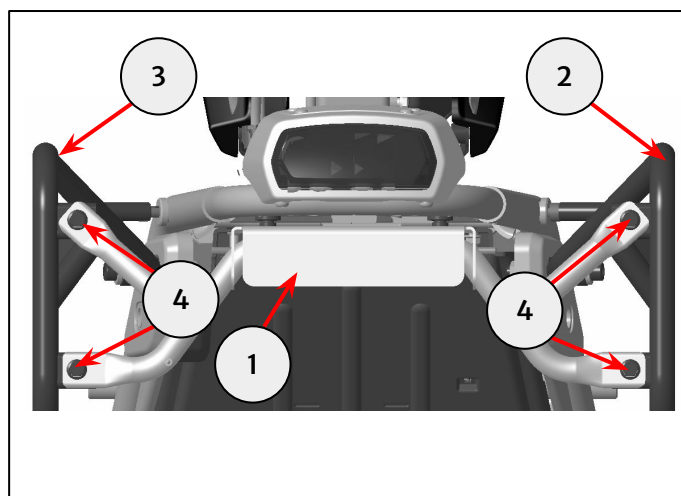

20 Looking from the rear of the motorcycle ensure the LH (1) and RH (2) pannier rails are centralised on the motorcycle, as shown.

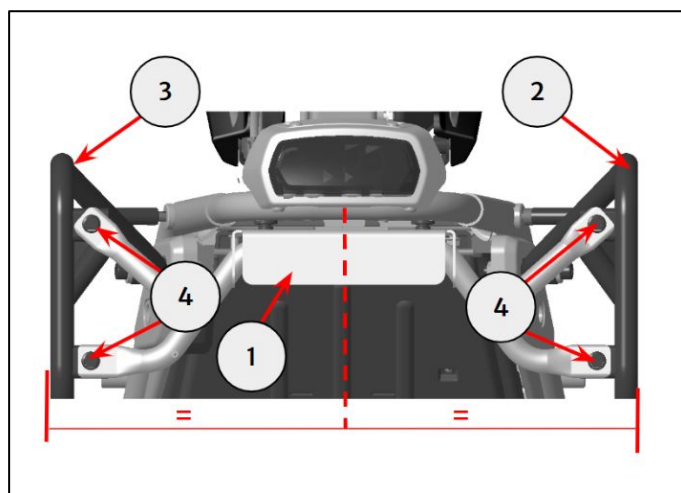

21 Ensure the rubber mount (1) fitment should be center of the connector tube assembly.

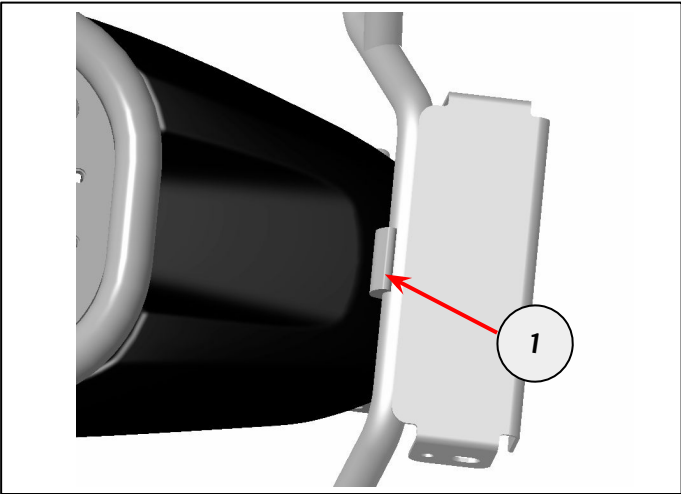

22 Tighten the pannier rail front fixings (1) to 22Nm.



6mm hexagonal bit and torque wrench



5mm hexagonal bit and torque wrench

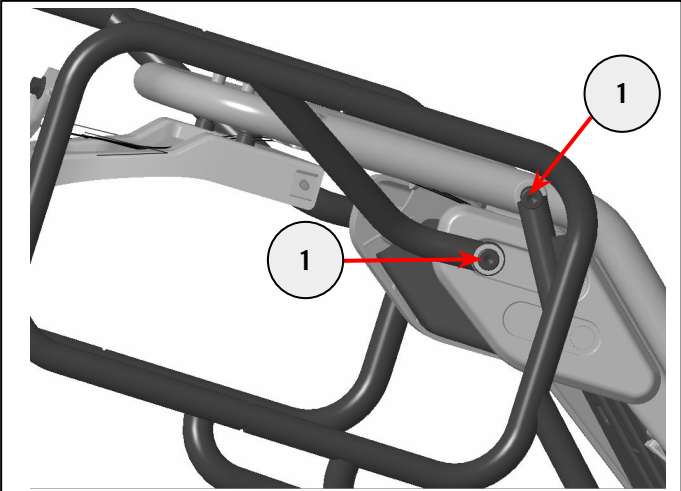

23 Tighten the rear connector bar fixings (1) to 10 Nm.



10mm Bi-hexagonal socket and torque wrench

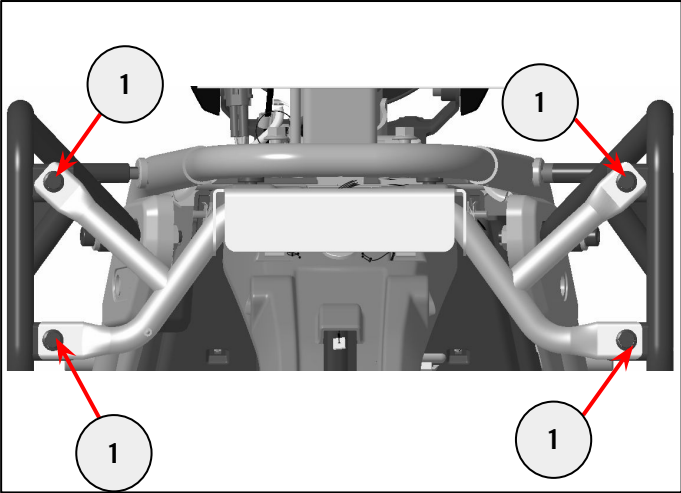

24 Tighten the grab rail (1) rear fixings (2) to 25 Nm.



13mm Bi-hexagonal socket and torque wrench

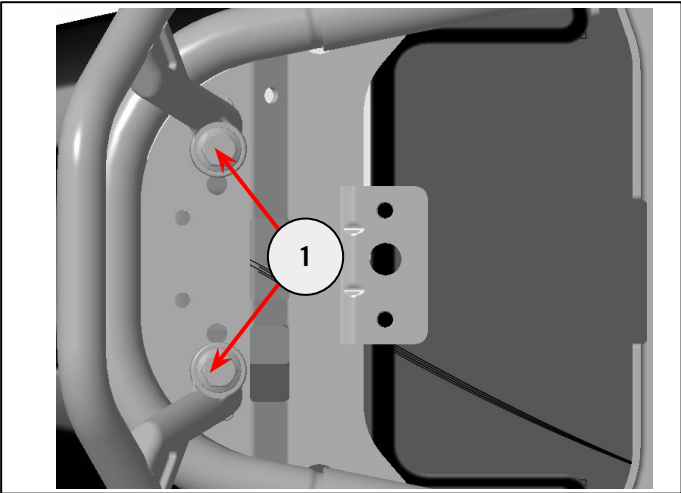

25 Route the RH indicator harness (1) through the indicator mounting hole in the RHS of the connector bar (2), as shown.

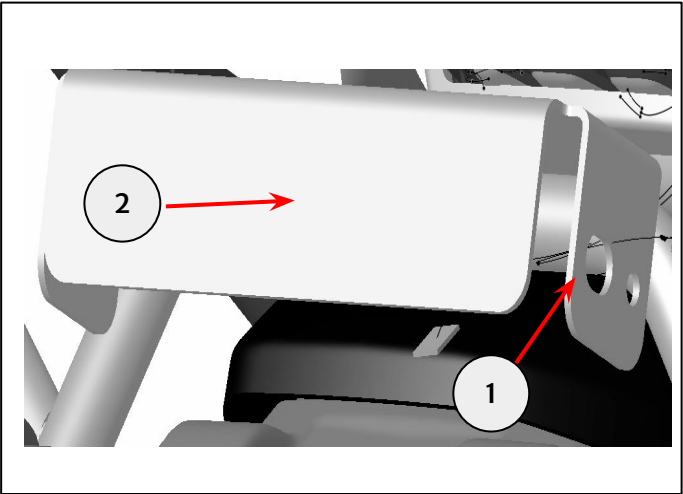

26 Fit the RH indicator (1) to the RHS of the connector bar (2) and secure with the original fixing (3) and nut (4). Tighten the nut to 5 Nm.

4mm hexagonal bit and torque wrench

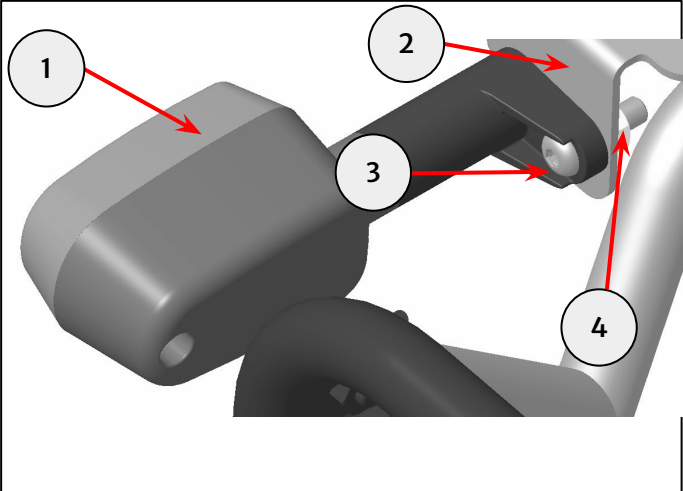

Repeat steps 22 and 23 for the LH indicator.

27 Connect the indicator extension harnesses (1), from the kit to the main wiring harness (2) along with the number plate hanger (3)

NOTE: The extension harness with the GREEN connectors must be connected to the main harness GREEN connector and the extension harness with the RED connectors must be connected to the main harness RED connector.

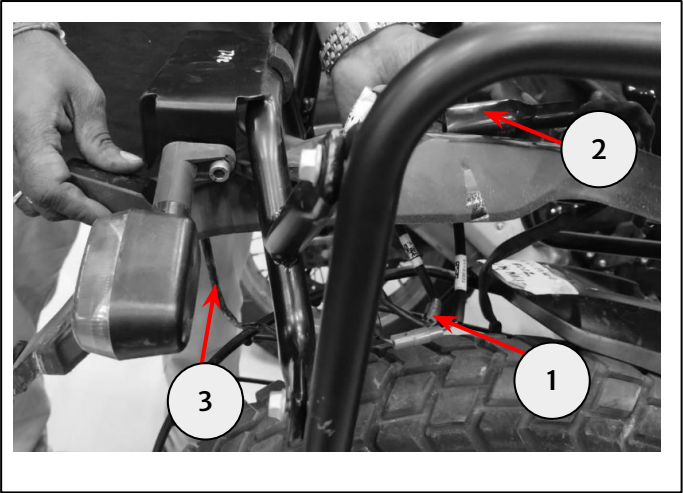

28 Connect the indicator harness extensions to the left hand indicator harness (1) and right hand indicator harness (2).

NOTE: The extension harness with the GREEN connector must be connected to the right hand indicator harness and the extension harness with the RED connector must be connected to the left hand indicator harness.

CAUTION: Ensure the re-routed indicator wiring harnesses are not trapped between the infill panel and rear mudguard. A wiring harness which becomes trapped during installation can result in equipment malfunction.

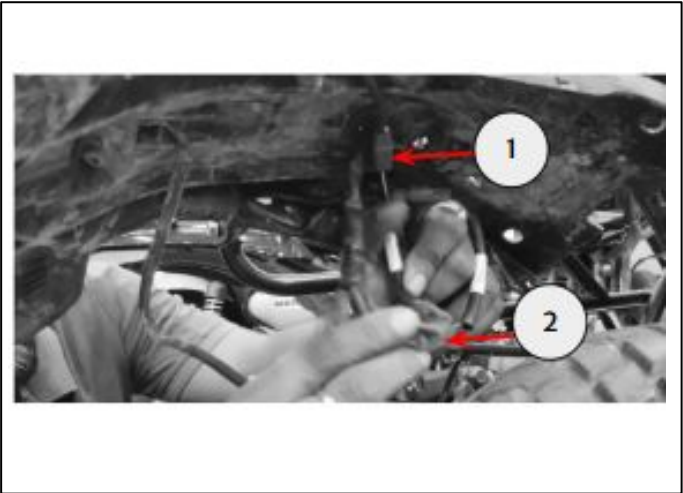

29 Refit the rear mudguard assembly (1) by first assembling the two fixings located below the seat (2), followed by the five fixings located on the underside of the rear mudguard (3).

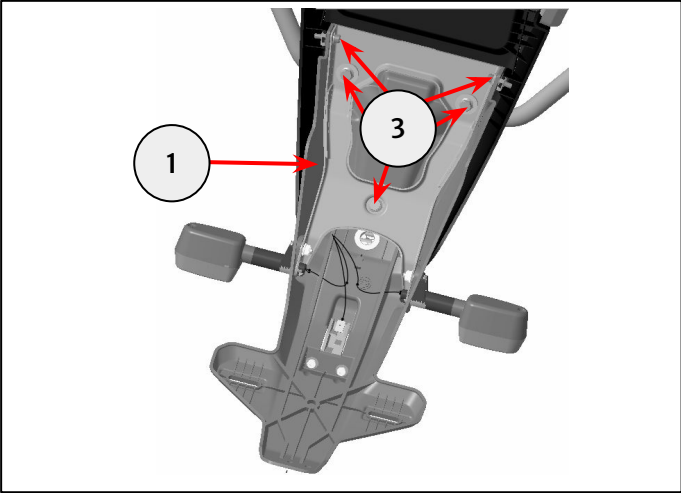
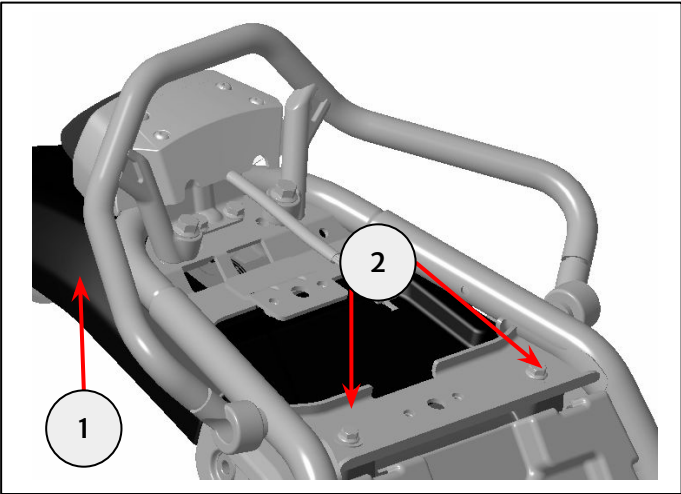

30 Reconnect the battery and check that the indicators function properly.

Refit the seat as described in the Owner's Manual.

Installation of Panniers

1 Collect the left hand pannier from the kit. From inside the pannier (1), loosen the upper mount fixings by hand (2).

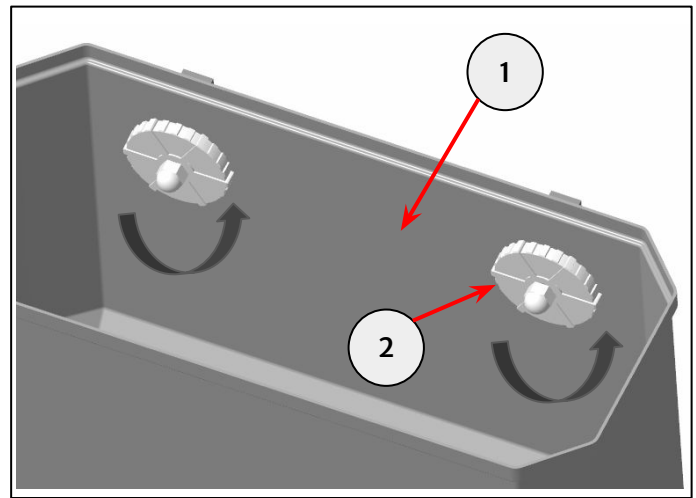

2 Adjust the position of the upper mount retaining bars (1) until they are facing towards the bottom of the pannier (2) as shown.

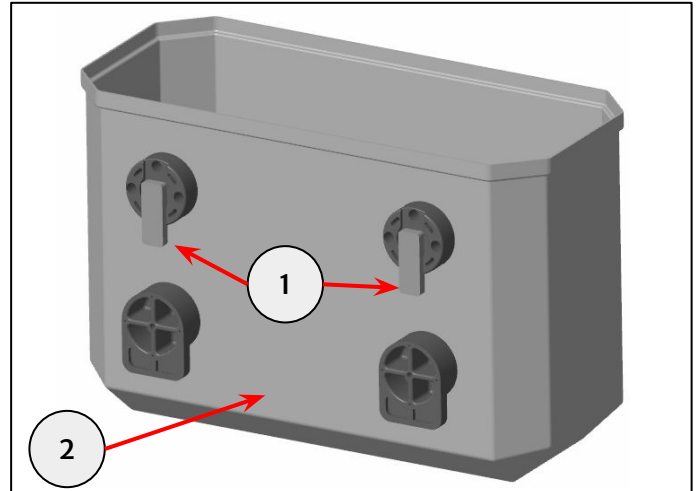

3 Position the pannier on the left hand pannier rail (1) ensuring the lower pannier mounts (2) are located inside the pannier rail (1). Push the lower pannier mounts (2) onto the pannier rail (1) as shown.

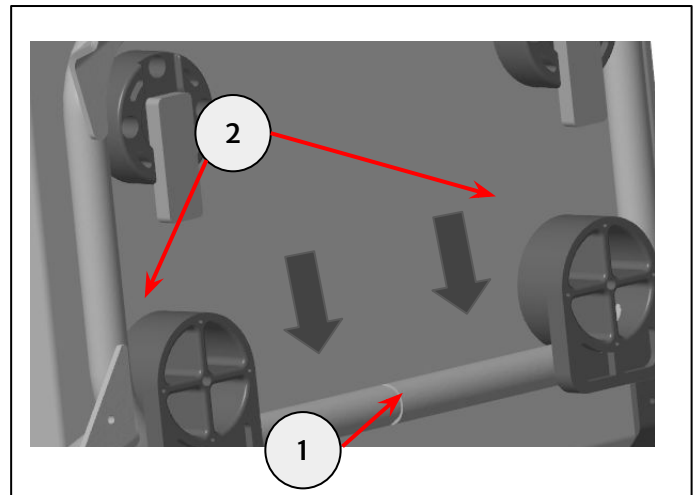

4 Position the pannier upper mounts (1) inside the pannier rail (2). Adjust the position of the pannier upper mount retaining bars (3) until they are across the pannier rail (2).

From inside the pannier, tighten the upper mount fixings (4) to secure the pannier to the pannier rail by hand.

Repeat steps 12 to 15 for the right hand pannier.



CAUTION: Ensure there is sufficient clearance between the pannier rail and upper mount retaining bars to prevent damage to the pannier rail when adjusting the position of the upper mount retaining bars.

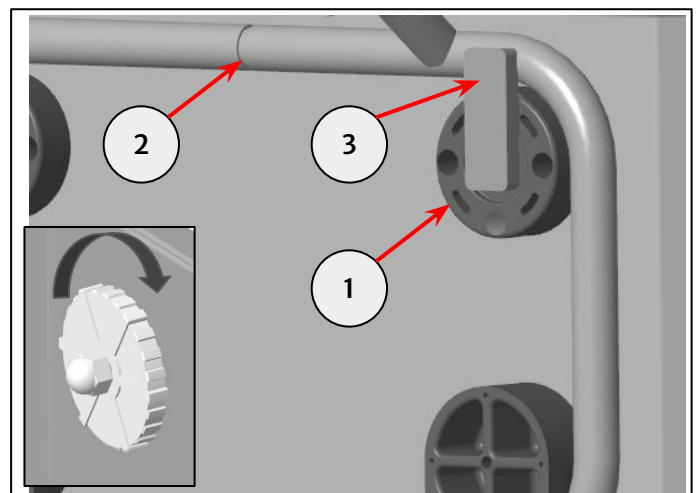

Pannier Operation

5 To open a pannier. Insert the key (1) into the pannier lock and turn the key to the un-locked position, as shown. Remove the key. Lift the lock section (2) of the latch to release the latch (3) from the pannier lid (4).

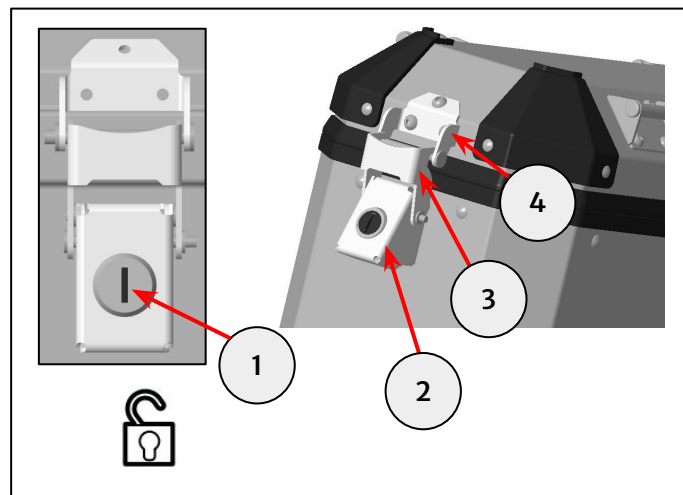

6 To secure a pannier lid in the closed position, ensure the latch (1) is located on the pannier lid (2) and press the lock section (3) of the latch down to secure the pannier lid.

Insert the key (4) into the pannier lock and turn the key to the locked position, as shown. Remove the key.

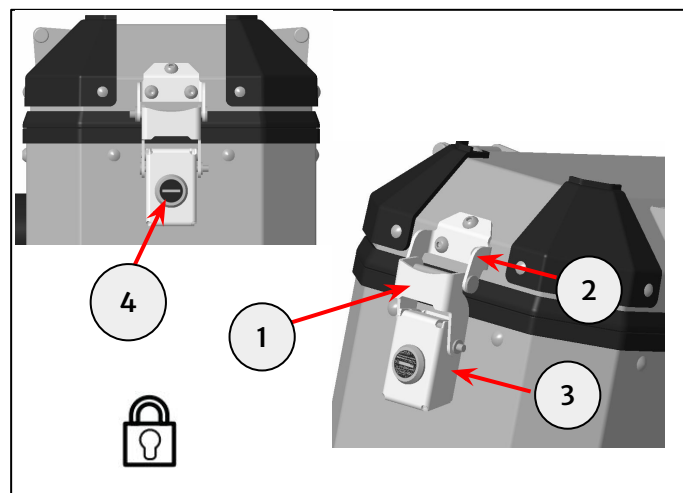

Reflector Fitment

7 Using the wipe provided in the kit, clean the area below the logo on each pannier. Allow to fully dry.

8 Peel the backing paper from the reflector (1) and stick to the pannier and press firmly, ensuring the pad is centrally located on the pannier.

When fitting self-adhesive parts care must be taken to make sure positioning is correct and accurate. Once the adhesive has been attached to the mounting surface, there is no satisfactory method of removal or re-positioning if incorrectly aligned. Initial bonding is instant, full bonding is achieved after 72 hours at room temperature.

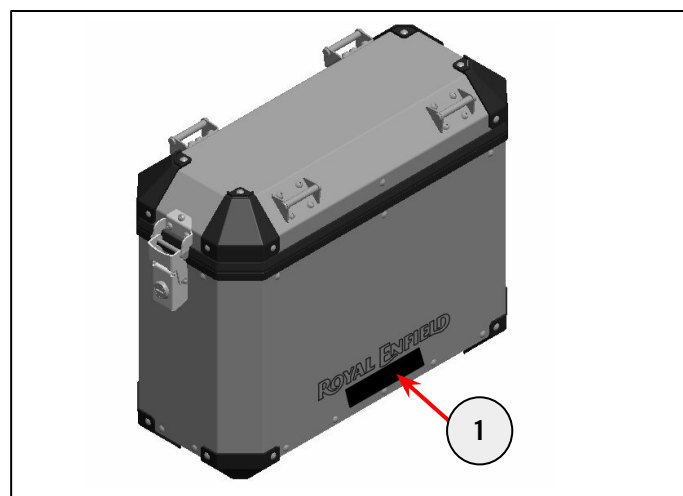

WARNING: After fitting any genuine Royal Enfield accessory always ride the motorcycle with caution and allow time to become familiar with any change in the motorcycle handling characteristics. Failure to become familiar with any change in the motorcycle handling characteristics may cause the motorcycle to become unstable and result in an accident.