

**Part Number:**  
KXA00147, KXA00659

**Models:**  
Original Classic 350 & Bullet 350  
BSVI Classic 350, Bullet 350 & Goan  
Classic 350 Models



**WARNING:** Royal Enfield genuine accessories are designed to fit only the specific Royal Enfield motorcycle(s) that are specified above. They should not be fitted to any other type of motorcycle. Pay particular attention to the warnings and cautions contained in this instruction, failure to do so may result in an incorrect installation of the accessory which could result in an unsafe riding condition and possible accident. If in any doubt always seek help from your authorised Royal Enfield dealer.



**WARNING:** Before starting any accessory kit installation ensure the motorcycle is supported in a stable condition. Failure to support the motorcycle correctly could lead to motorcycle damage or personal injury.



**WARNING:** All fixings must be tightened to the torque values specified in this instruction. Failure to tighten fixings to the correct torque could result in an unsafe riding condition and possible accident



**CAUTION:** Care should be taken when fitting any accessory kit. Incorrect handling of kit components or the use of incorrect tools could lead to component or motorcycle damage.

**NOTE:** The content of this instruction is subject to change at any time without notice or liability. Royal Enfield reserves the right to revise the information presented at any time.

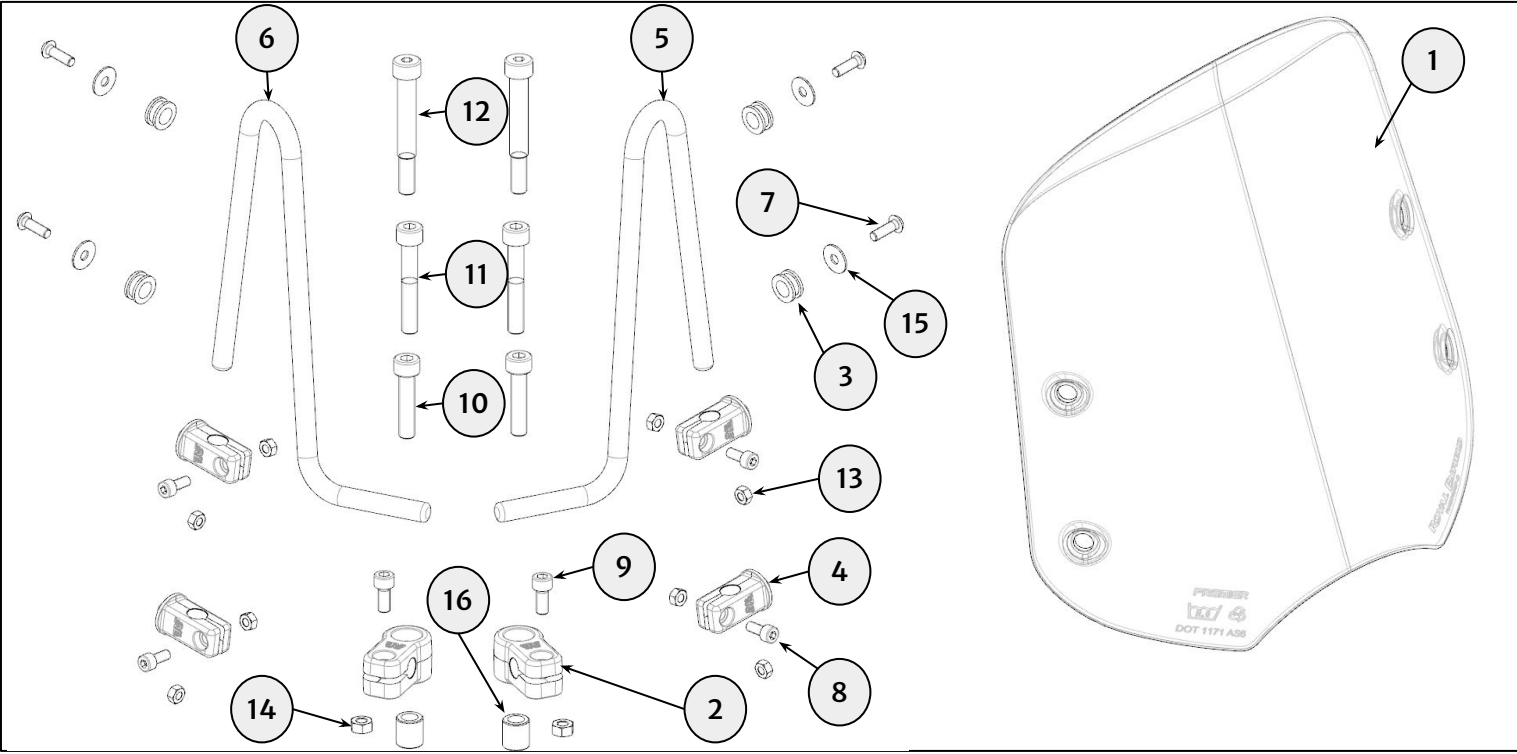

Item	Description	Qty
1	Touring Windshield	1
2	Lower Mount	2
3	Rubber Grommet	4
4	Screen Mount Clamp	4
5	Windshield Mounting Bar, Right Hand Side	1
6	Windshield Mounting Bar, Left Hand Side	1
7	Fixing, M5 X 16mm	4
8	Fixing, M5 X 12mm	4
9	Fixing, M6 X 14mm	2
10	Fixing, M8 x 35mm	2
11	Fixing, M8 X 45mm	2
12	Fixing, M8 x 50 mm (KXA00659 only)	2
13	Nut, M5	8
14	Nut, M6	2
15	Washer, M5	4
16	Spacer (KXA00659 only)	2

**1** Push fit the four rubber grommets (1) into the touring windshield (2).

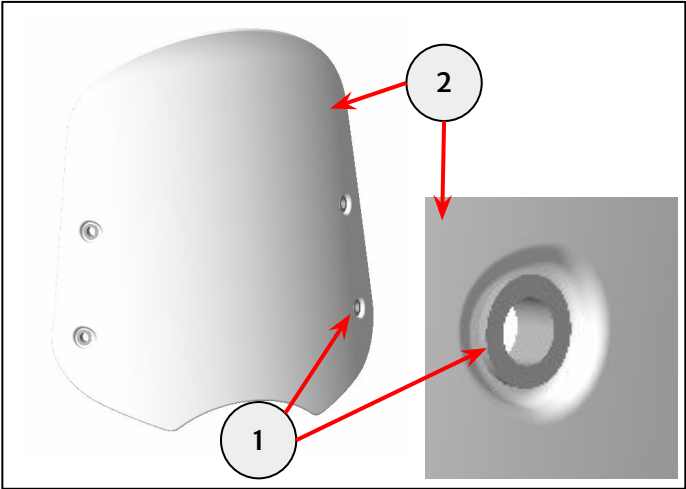

**2** Assemble the Screen Mount Clamp (1) with a Fixing, M5 X 12mm (2) and Nut, M5 (3).  
Do not fully tighten the fixing at this stage.

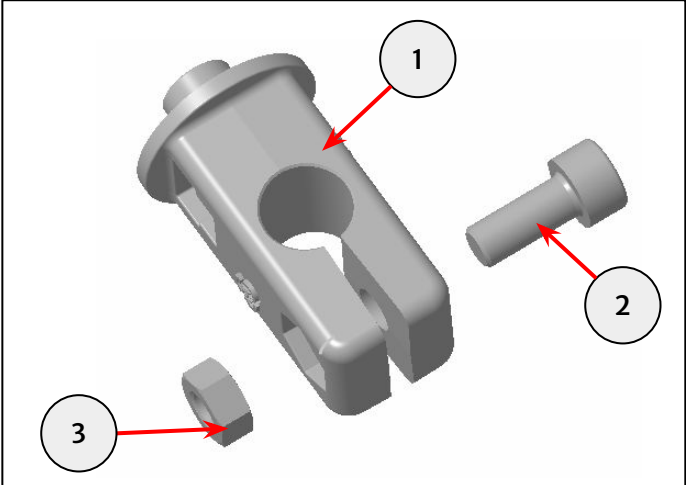

4mm hexagonal bit with ratchet

Repeat step 2 on all screen mount clamps.

**3** Push fit an M5 Nut (1) into the side pocket (2) of the four screen mount clamps (3) and loosely assemble to the Touring Windshield (4) through the Rubber Grommets (5), using Fixing, M5 X 16mm (6) and Washer, M5 (7). The winged R branding should be visible from the side of the screen.

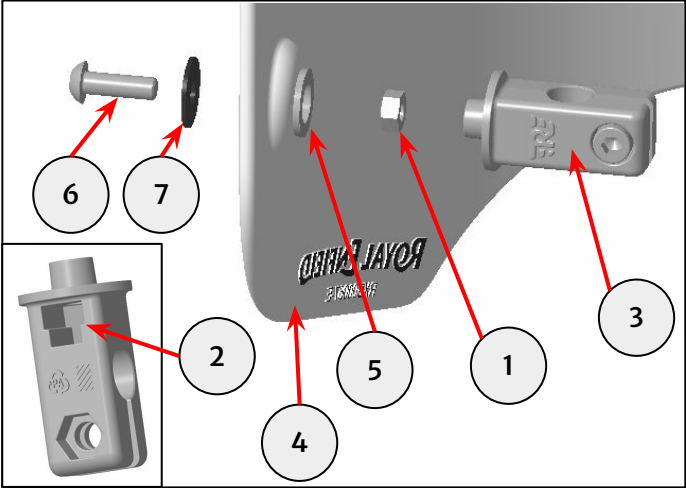

4mm hexagonal bit with ratchet

**4** Identify the Left Hand and Right Hand Windshield Mounting Bars

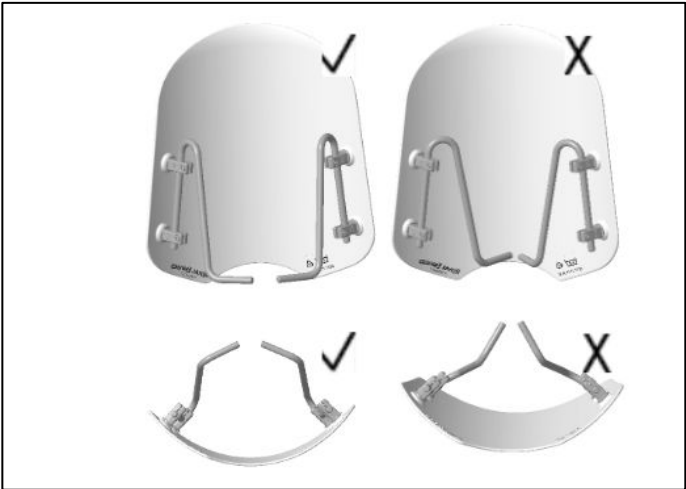

**5** Assemble the two lower mounts (1) with the M6 X 14mm fixings (2) and M6 nuts (3) from the kit.  
Do not fully tighten the fixings at this stage



5mm hexagonal bit with torque wrench

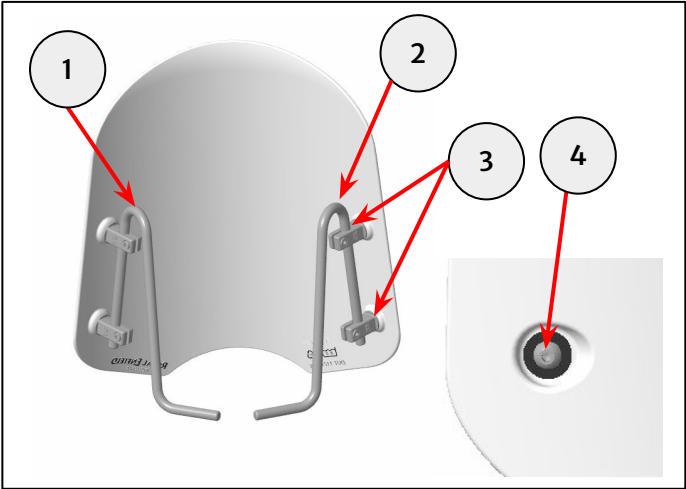

**6** Slide the Windshield Mounting Bars (1 & 2) into the screen mount clamps (3) and tighten the four M5 X 16mm fixings (4) to 3Nm.



5mm hexagonal bit with ratchet

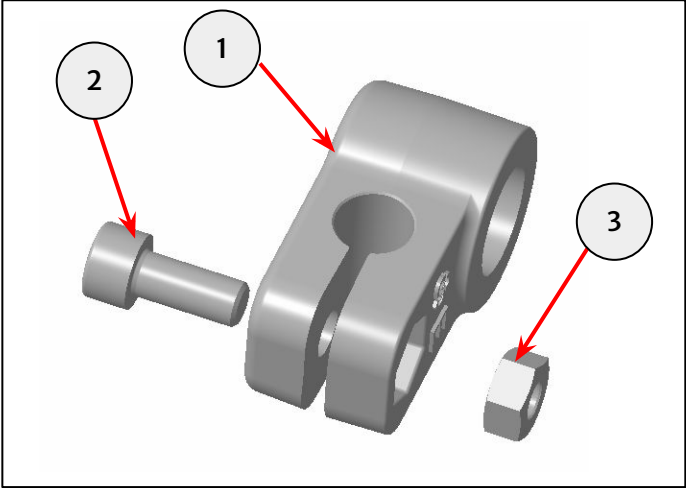

For Classic & Bullet models:

7 Loosen the two lower handlebar clamp fixings (1).

 **CAUTION:** Loosening the handlebar clamp will allow the handlebars to drop onto the fuel tank or nacelle. Ensure adequate protection is in place to prevent damage.



For BSVI models:  
13mm socket with ratchet



For other models:  
14mm socket with ratchet

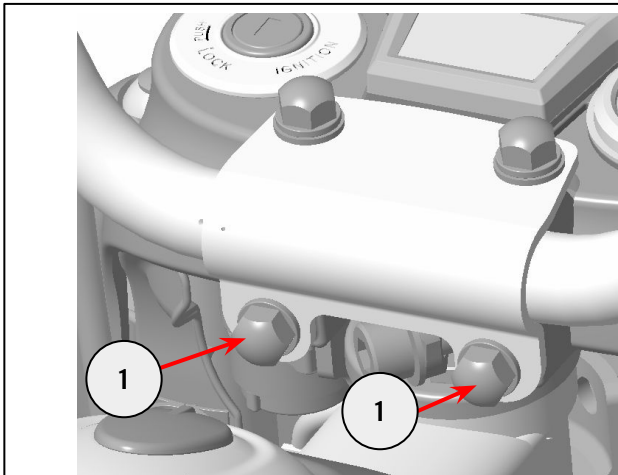

8 Loosen and remove the two upper handlebar clamp fixings (1). Retain the fixings for reuse if the motorcycle is to be returned to its original condition.



For BSVI models:  
13mm socket with ratchet



For other models:  
14mm socket with ratchet

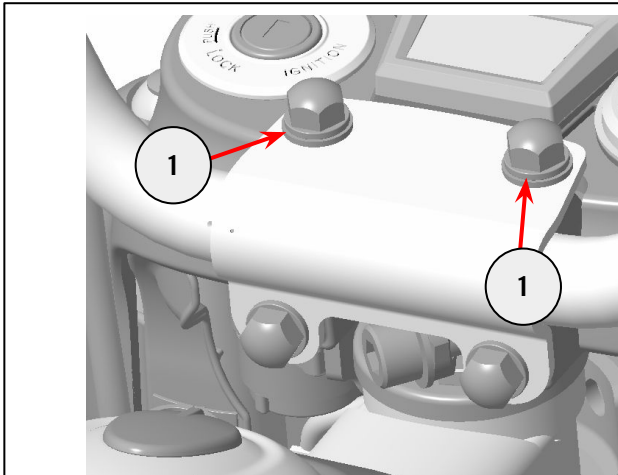

9 Fit the two lower mounts (1) to the top of the handlebar clamp. Do not fully tighten the fixings at this stage. For BSVI models use the two M8 X 35mm fixings (2) from the kit.



6mm socket with ratchet

For other models use the two M8 X 45mm fixings (3) from the kit.



5mm socket with ratchet

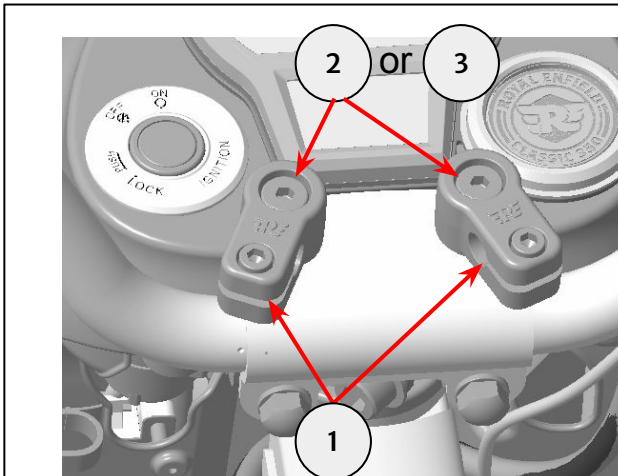

## For Goan Classic model:

**10** Take note of the Handlebar alignment mark (1). Support the handlebars and remove the front two handlebar clamp fixings (2). Retain the fixings for reuse if the motorcycle is to be returned to its original condition.



6mm hexagonal bit with ratchet



**CAUTION:** Loosening the handlebar clamp will allow the handlebars to drop onto the fuel tank or nacelle. Ensure adequate protection is in place to prevent damage.

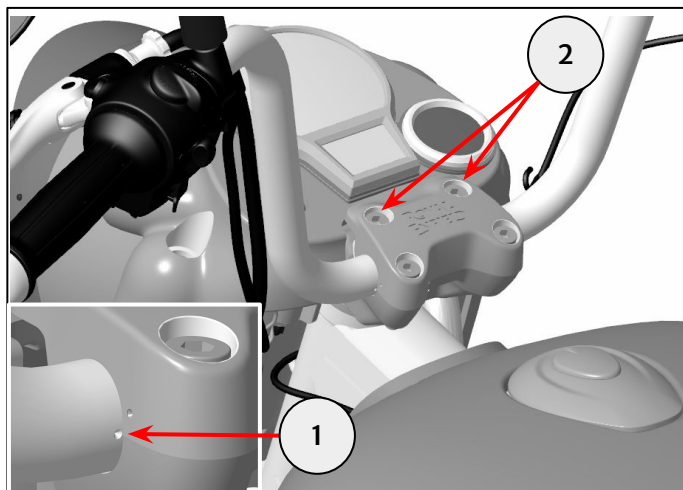

**11** Insert the two spacers (1) from the kit into the front handlebar clamp recesses.

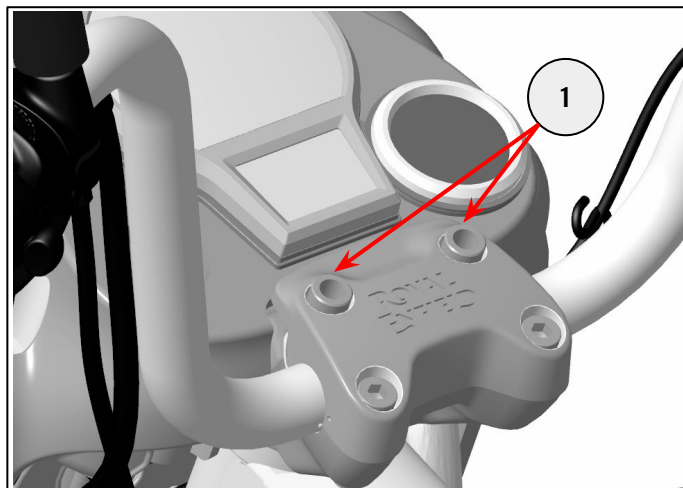

**12** Fit the two lower mounts (1) to the top of the handlebar clamp using the two M8 x 50mm fixings from the kit (2). Do not fully tighten the fixings at this stage.



6mm hexagonal bit with ratchet

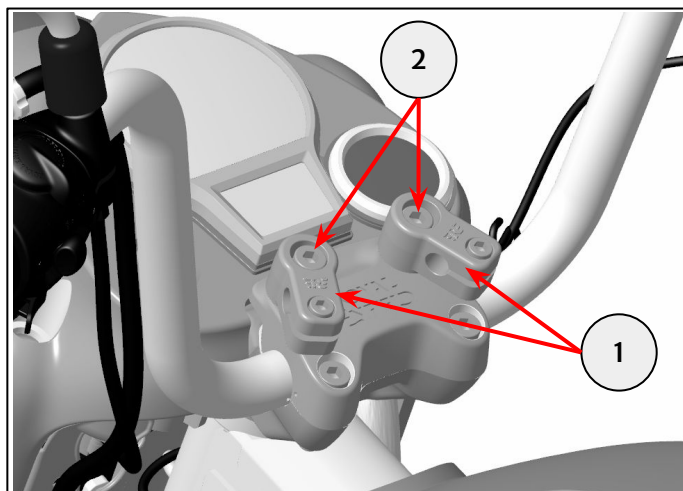

**13** Slide the Windshield Mounting Bars (1 & 2) into the Lower Mounts (3) and gently rest the screen on the Nacelle.

 **CAUTION:** At this stage the screen will be unstable. Please handle with care.

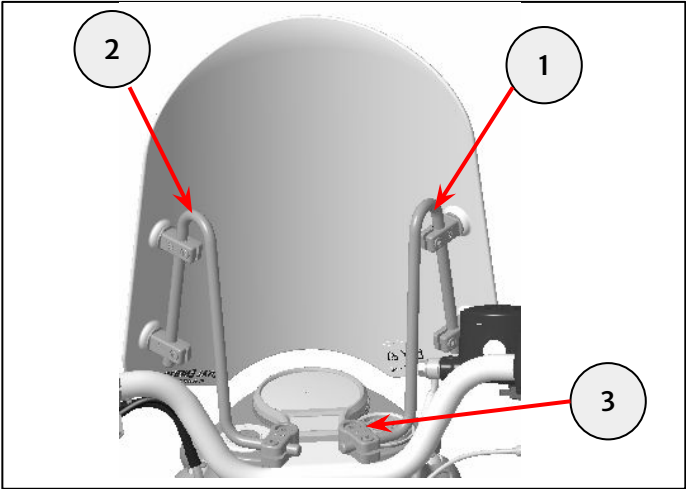

**14** Position the screen at the desired height, recommended 10mm from lowest mount to end of bar. Then tighten the four M5 X 12mm fixings (1) to **3Nm**.



4mm hexagonal bit with torque wrench

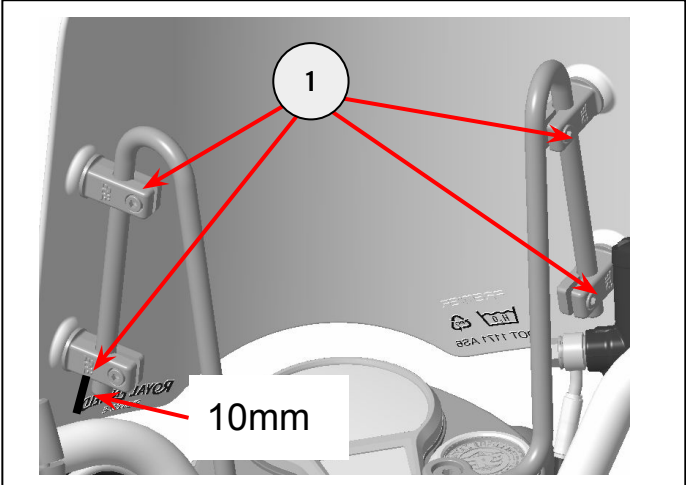

**15** Ensure the mounting bar knurling is central in the lower clamp mount, adjust the screen to the desired height (recommended 10mm from the centre of the nacelle) and tighten the two M6 X 14mm fixings (1) to **3Nm**.

**For Goan Classic go to step 21**



5mm hexagonal bit with torque wrench

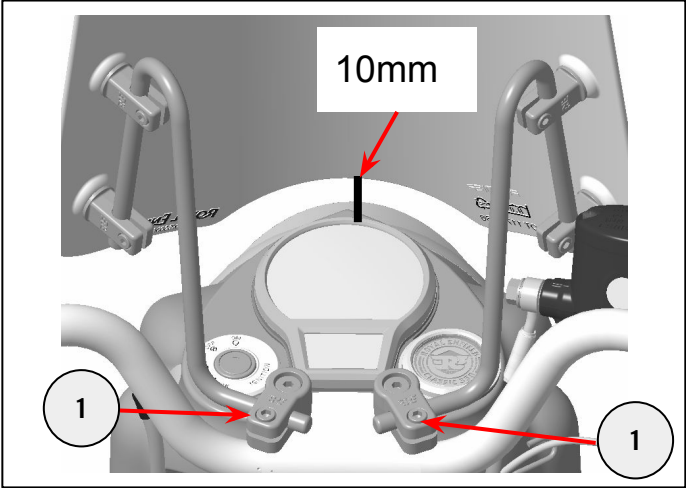

**16** Centralise the screen on the bike and tighten the handlebar clamp fixings (1) or (2) to **20 Nm**.



For BSVI models  
6mm hexagonal bit with torque wrench



For other models  
5mm hexagonal bit with torque wrench

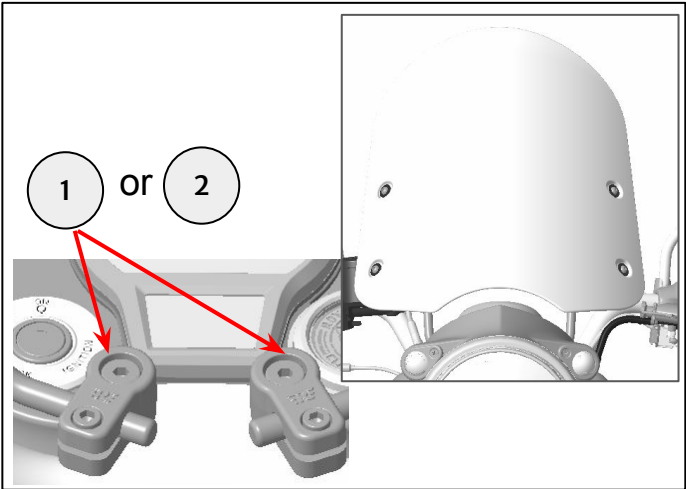



**17** Align the handlebar pip with the handlebar clamp pip (1) and tighten the lower handlebar clamp fixings (2) to **20 Nm**.  
For BSVI models:



13mm socket with torque wrench

For other models.



14mm socket with torque wrench

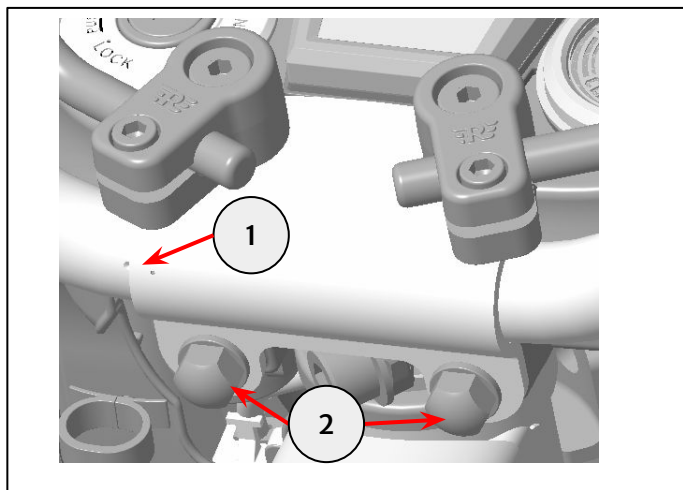

**18 For Goan Classic:**

Align the handlebar alignment mark as before  
Tighten the rear handlebar fixings (1) to **25 Nm**.

**Note** – The handlebars will not be secure at this stage.



6mm hexagonal bit with torque wrench

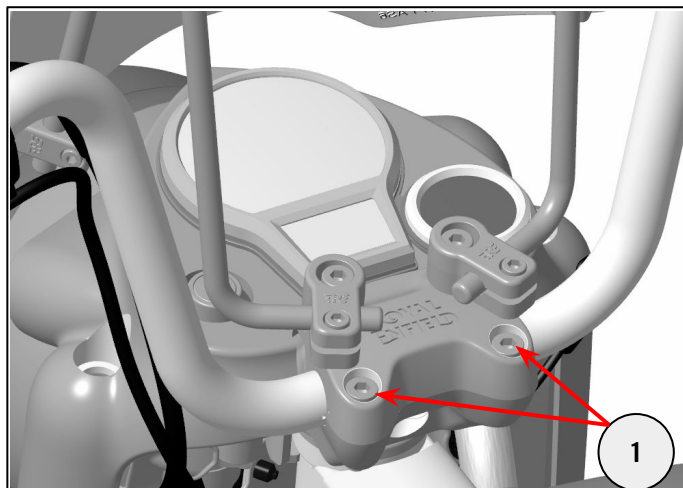

**19 For Goan Classic:**

Centralise the screen on the bike  
Check that the handlebar alignment mark is in the correct position (1)  
Tighten the front handlebar fixings (2) to **25 Nm**.



6mm hexagonal bit with torque wrench

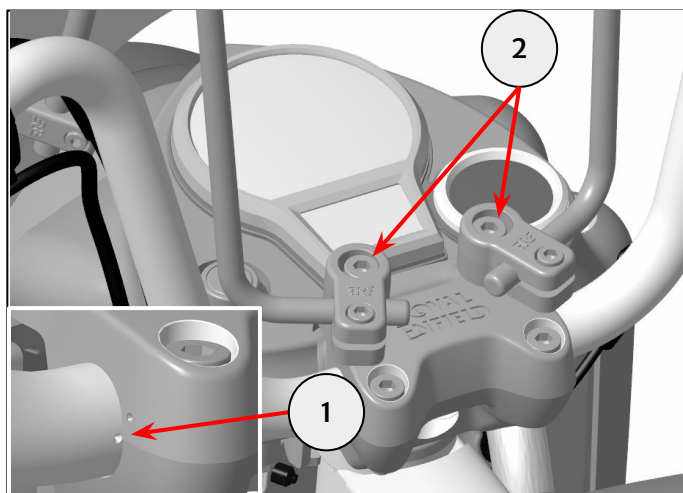

**WARNING:** After fitting any genuine Royal Enfield accessory always ride the motorcycle with caution and allow time to become familiar with any change in the motorcycle handling characteristics. Failure to become familiar with any change in the motorcycle handling characteristics may cause the motorcycle to become unstable and result in an accident.