



Part Number:
KXA00129 and KXA00149

Models:
BSVI Hunter
With VIN starting ME3J3D5FEN1

 **WARNING:** Royal Enfield genuine accessories are designed to fit only the specific Royal Enfield motorcycle(s) that are specified above. They should not be fitted to any other type of motorcycle. Pay particular attention to the warnings and cautions contained in this instruction, failure to do so may result in an incorrect installation of the accessory which could result in an unsafe riding condition and possible accident. If in any doubt always seek help from your authorised Royal Enfield dealer.

 **WARNING:** Before starting any accessory kit installation ensure the motorcycle is supported in a stable condition. Failure to support the motorcycle correctly could lead to motorcycle damage or personal injury.

 **WARNING:** All fixings must be tightened to the torque values specified in this instruction. Failure to tighten fixings to the correct torque could result in an unsafe riding condition and possible accident

 **CAUTION:** Care should be taken when fitting any accessory kit. Incorrect handling of kit components or the use of incorrect tools could lead to component or motorcycle damage.

NOTE: The content of this instruction is subject to change at any time without notice or liability. Royal Enfield reserves the right to revise the information presented at any time.

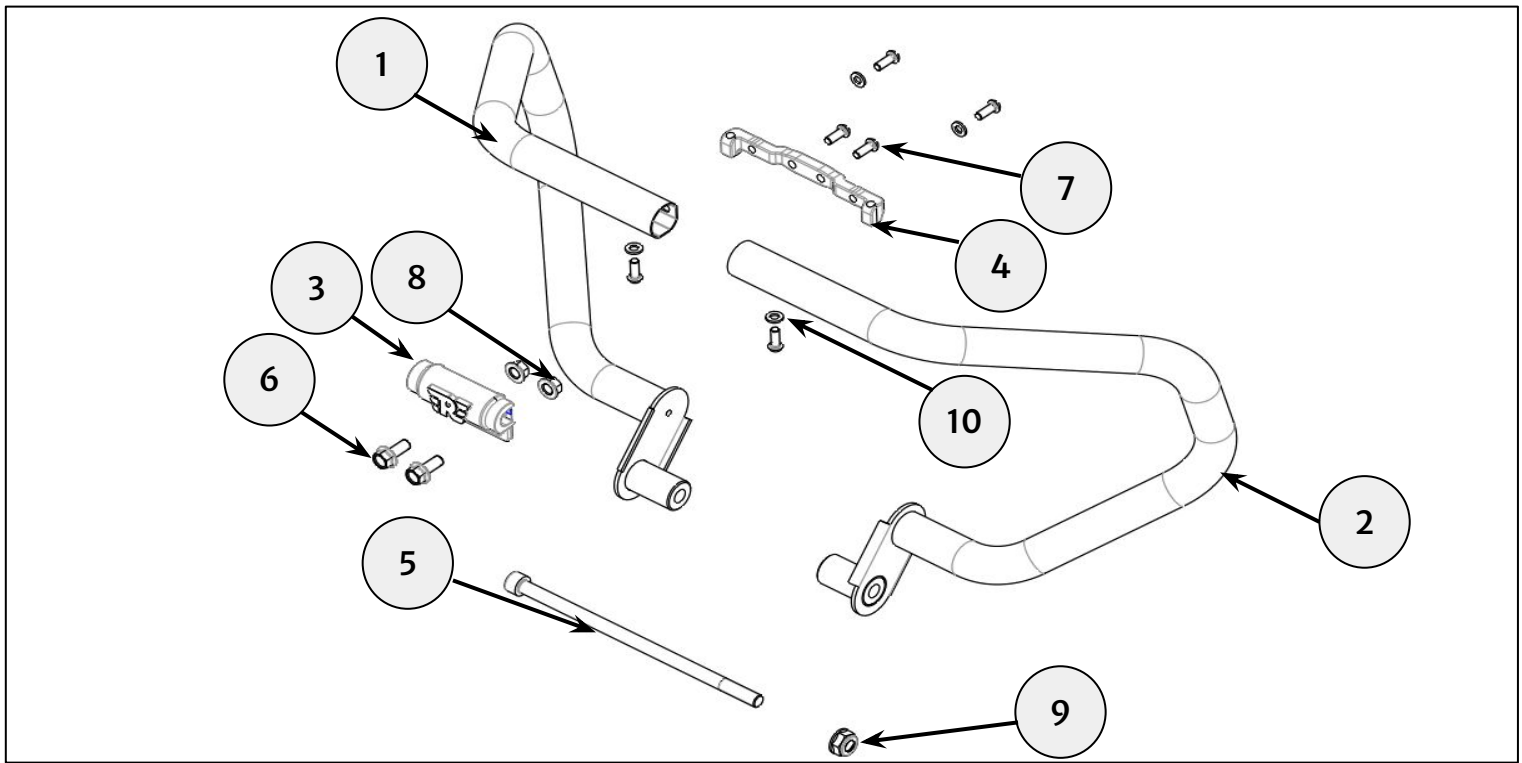

Item	Description	Qty
1	Engine Guard Assembly, Right hand	1
2	Engine Guard Assembly, Left hand	1
3	Engine Guard Top Mount	1
4	Brace Bar	1
5	Fixing, M10 x 215	1
6	Fixing, M8 x 20	2
7	Fixing, M6 x 16	6
8	Nut, M8	2
9	Nut, M10	1
10	Washer, M6	4

1 Assemble brace bar (1) and engine guard top mount (2) using M6 x 16mm fixings (3), tighten to **8Nm**. Ensure orientation of forged brace.

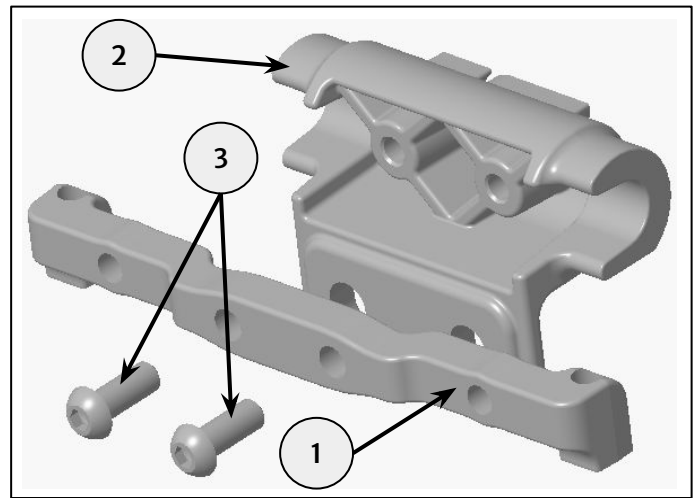
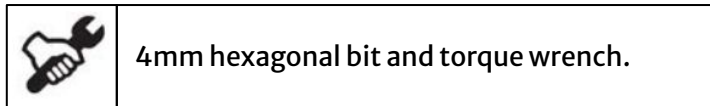

2 Disconnect O2 sensor connector (1) from Vehicle. Remove Exhaust pipe assembly from silencer by removing fixings (2), fixing (3) and nut (4). Retain for reuse. Now could able to slightly rotate the Exhaust pipe to accommodate engine guard assembly process.

Note: Please use TDL No: T4200777 for exhaust pipe removal and assembly sequence and torque details.

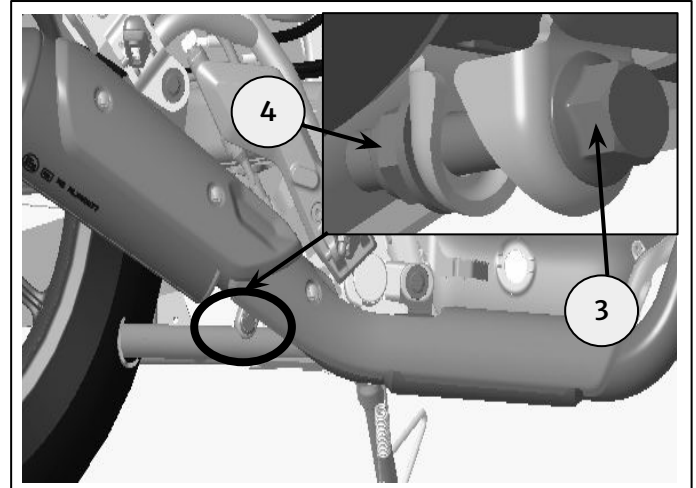
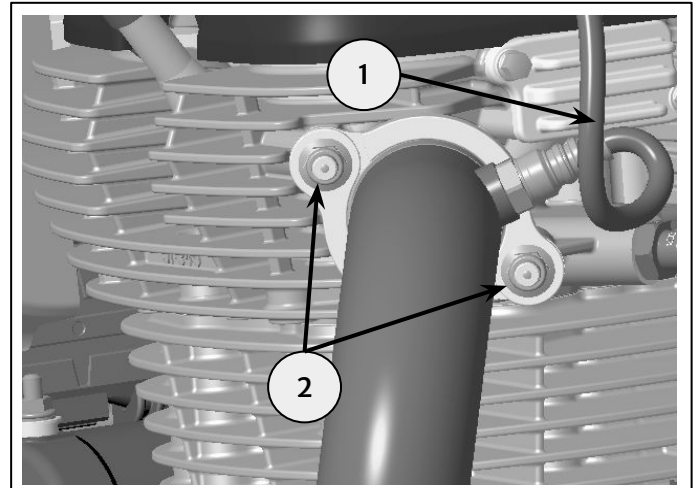
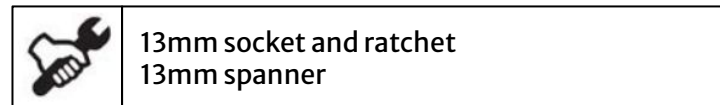

3 Remove clutch cable wire guide (2) by removing fixing (1) and nut (2).

Note: Reuse the clutch wire guide and fasteners when engine guard is not used.

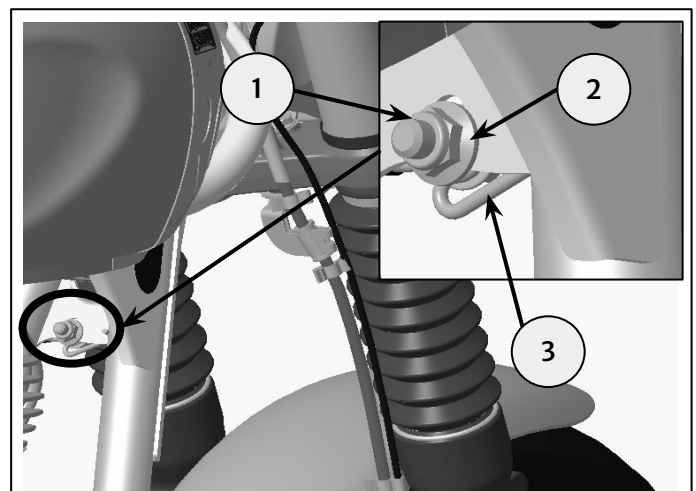
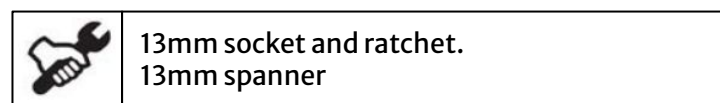

4 From step 1 use Top mount assembly (2) and from kit use engine guard assembly, Left Hand (1). From kit use M6 x 16mm fixings (3) and washers (4) to clamp Top mount assembly (2) to engine guard assembly, Left Hand (1) as shown. Tighten to **8Nm**.

Do not assemble engine guard, Right Hand (2) at this stage.



4mm hexagonal bit and torque wrench.

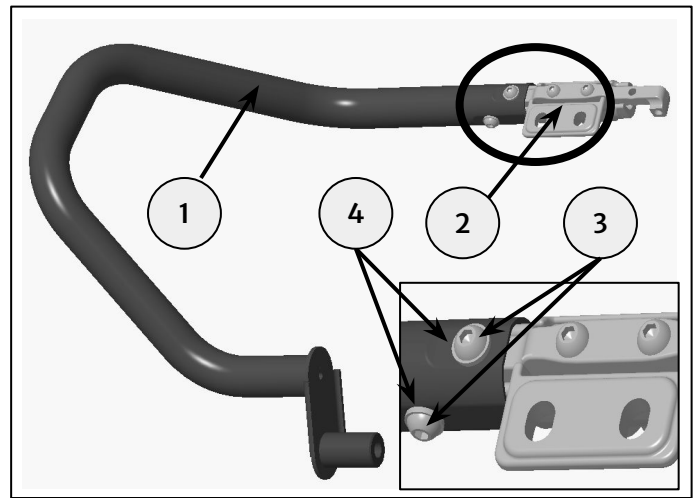

5 Remove dust cap (1) on both sides to remove fixing (2), Washer and nut (2) from the vehicle cradle assembly as shown. Discard fixing, washer and nut.



13mm socket and ratchet.

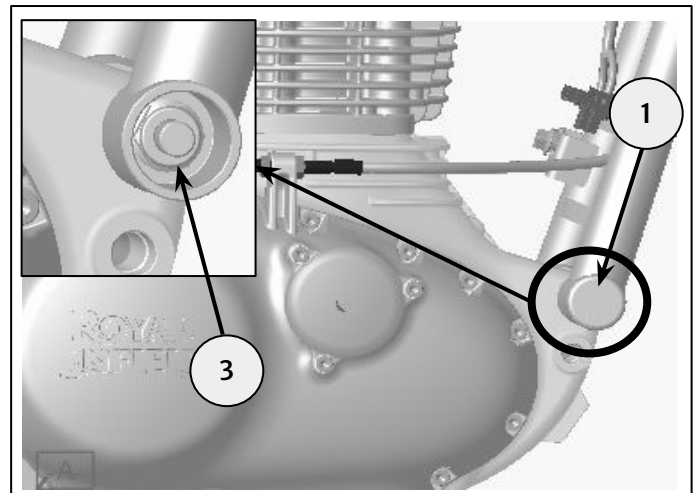
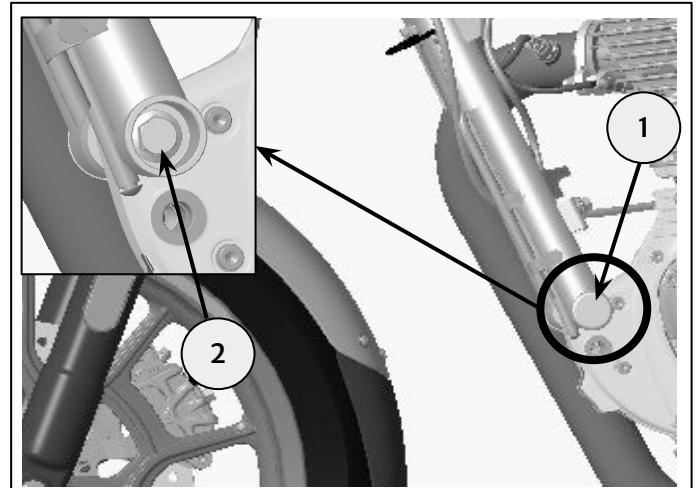

6 Insert Engine guard, Right Hand (1) to the vehicle cradle assembly (2) approximately position as shown.

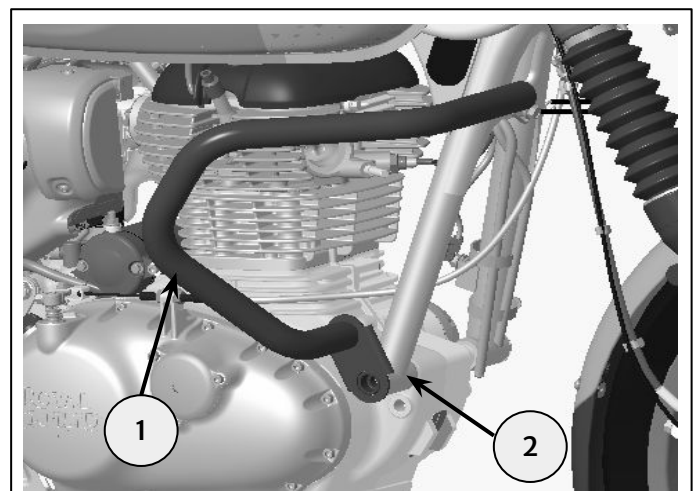

7 Insert pre assembled Engine guard, Left Hand assembly (2) from step 4 with the vehicle cradle assembly (3) and Engine guard, Right hand (1). Rotate and position to accommodate insertion of washers(4) and M6 x 16mm fixings (5) from kit, as shown. Tighten fixings to **8Nm**

Ensure clutch cable(6) is routed behind the engine guard assembly.



4mm hexagonal bit and torque wrench.

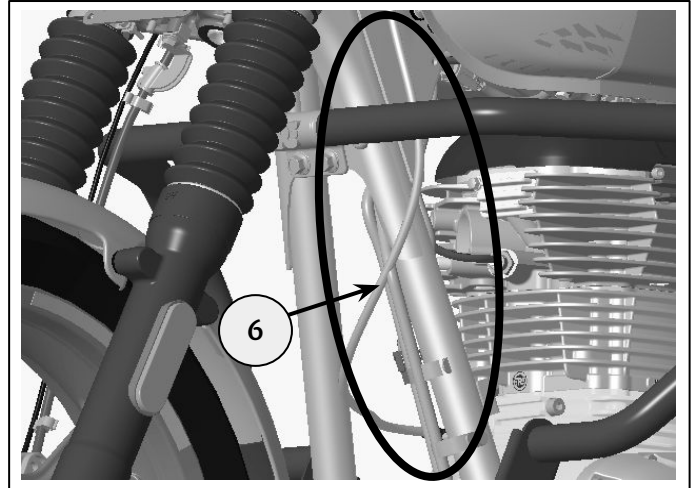
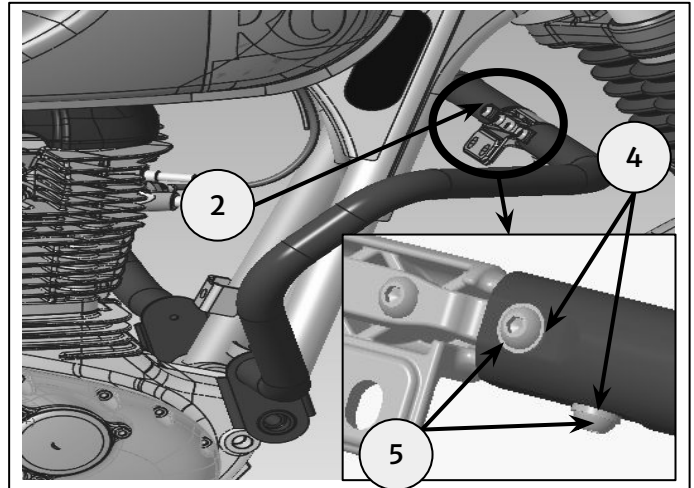
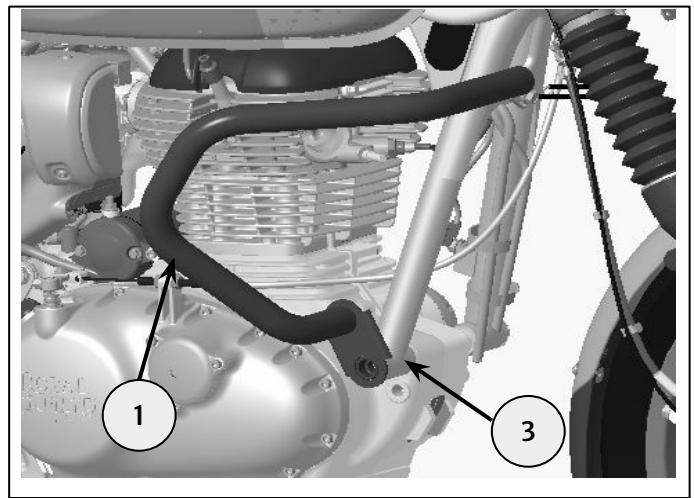

8 Use M10 x 215mm fixing (1) and M10 nut (2) from kit to mount engine guard assembly bottom side with vehicle cradle assembly. Do not fully tighten at this stage.

Note: Insert fixing from Right hand side, which will seat to flush.



8mm hexagonal bit and ratchet
17 mm spanner

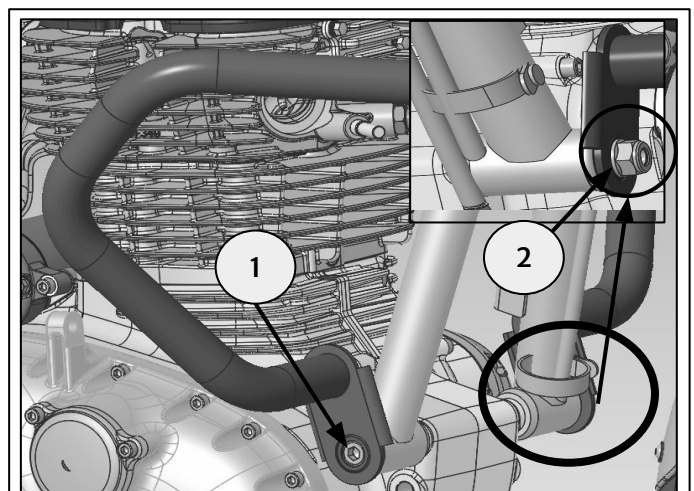

9 Position engine guard assembly top side with vehicle cradle assembly as shown. Use fixings (1) and nuts (2) from the kit and tighten to **25Nm**.



13mm socket and torque wrench.
13mm spanner.

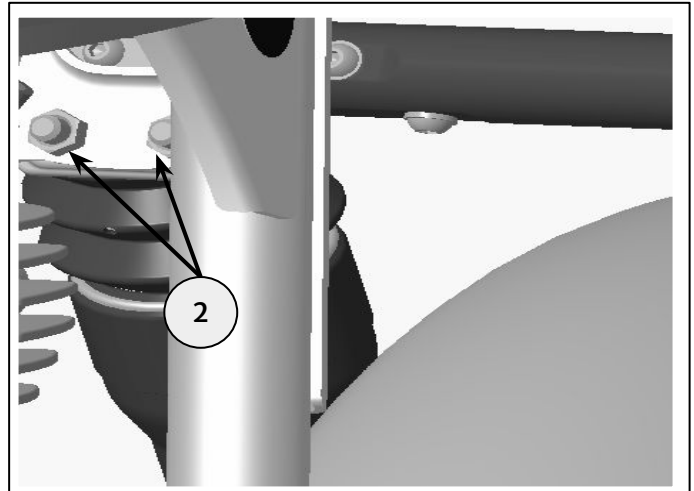
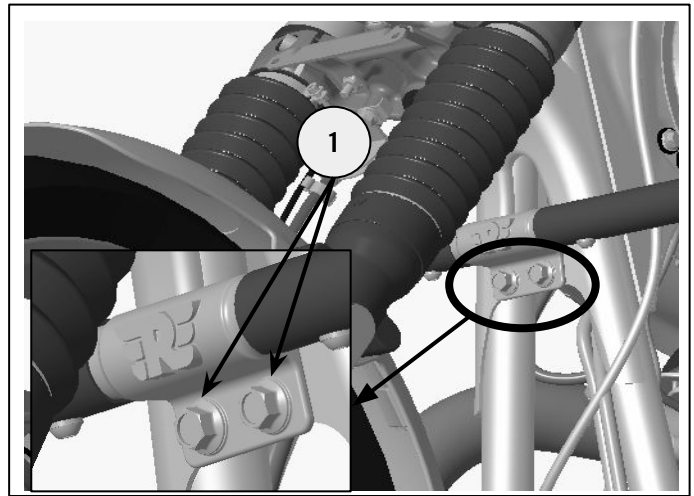

10 Tighten engine guard bottom mount fixing (1) and nut (2) to **55Nm**.

Note: After installation, Clutch cable free play should be checked and adjusted as per Royal Enfield standard T4200580



8mm hexagonal bit and torque wrench.
17 mm spanner.

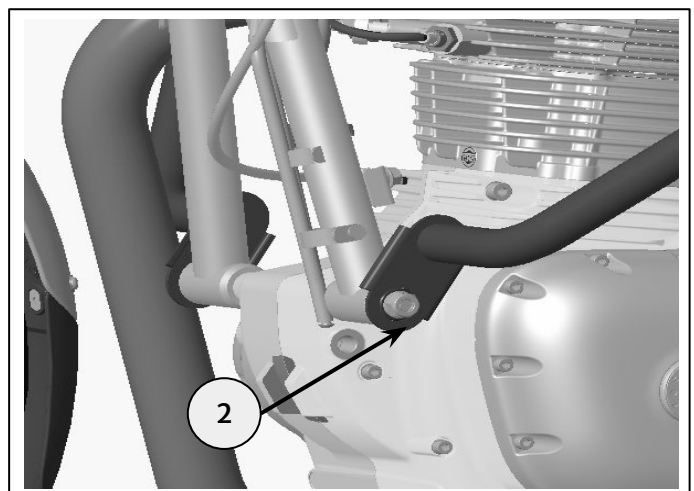
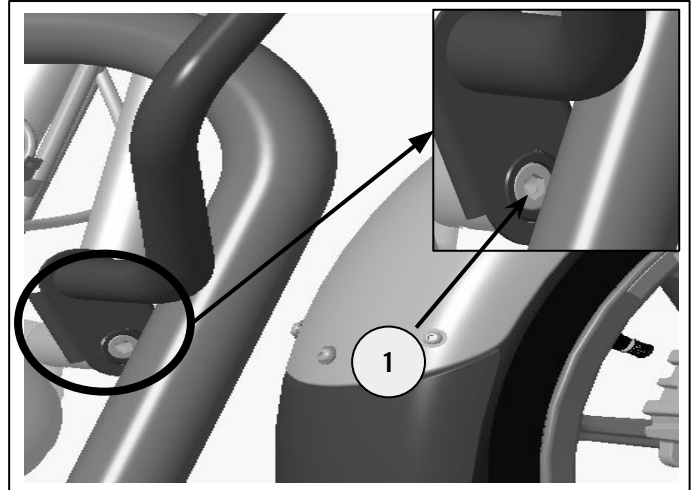

11 Position Exhaust pipe assembly to Engine head and silencer assembly as shown, Reuse the fixings (2) ,(3), and nut(4) retained in step 2. Connect the O2 sensor cable (1) to vehicle .

Note: Please use TDL No: **T4200777** for exhaust pipe removal and assembly sequence and torque details.
582638 - "Gasket to be replaced while disturbing the exhaust assembly" . Spares available through official RE dealers.

Note: After Exhaust pipe assembly ensure clearance between engine guard surrounding parts .

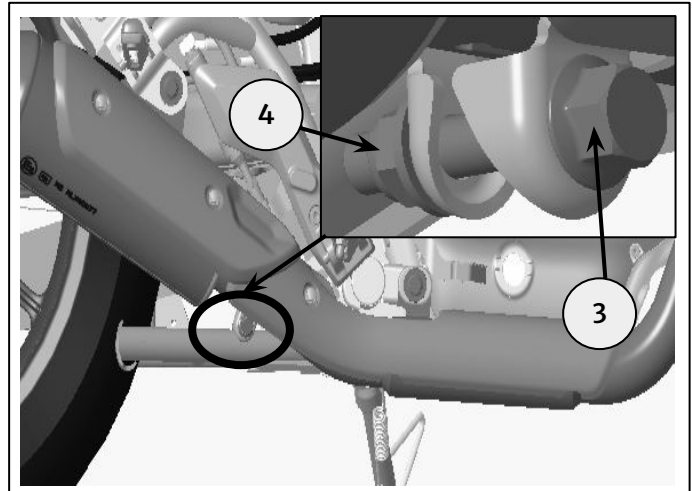
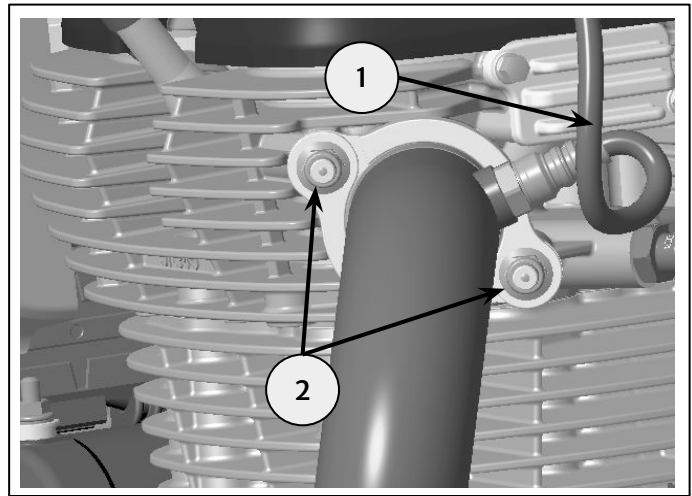

WARNING: After fitting any genuine Royal Enfield accessory always ride the motorcycle with caution and allow time to become familiar with any change in the motorcycle handling characteristics. Failure to become familiar with any change in the motorcycle handling characteristics may cause the motorcycle to become unstable and result in an accident.