

Part Number:
1990401 and KXA00125

Models:
BSVI Meteor With VIN starting ME3J3A5FAL3
BSVI Hunter With VIN starting ME3J3D5FEN1

WARNING: Royal Enfield genuine accessories are designed to fit only the specific Royal Enfield motorcycle(s) that are specified above. They should not be fitted to any other type of motorcycle. Pay particular attention to the warnings and cautions contained in this instruction, failure to do so may result in an incorrect installation of the accessory which could result in an unsafe riding condition and possible accident. If in any doubt always seek help from your authorised Royal Enfield dealer.

WARNING: Before starting any accessory kit installation ensure the motorcycle is supported in a stable condition. Failure to support the motorcycle correctly could lead to motorcycle damage or personal injury.

WARNING: All fixings must be tightened to the torque values specified in this instruction. Failure to tighten fixings to the correct torque could result in an unsafe riding condition and possible accident

CAUTION: Care should be taken when fitting any accessory kit. Incorrect handling of kit components or the use of incorrect tools could lead to component or motorcycle damage.

NOTE: The content of this instruction is subject to change at any time without notice or liability. Royal Enfield reserves the right to revise the information presented at any time.

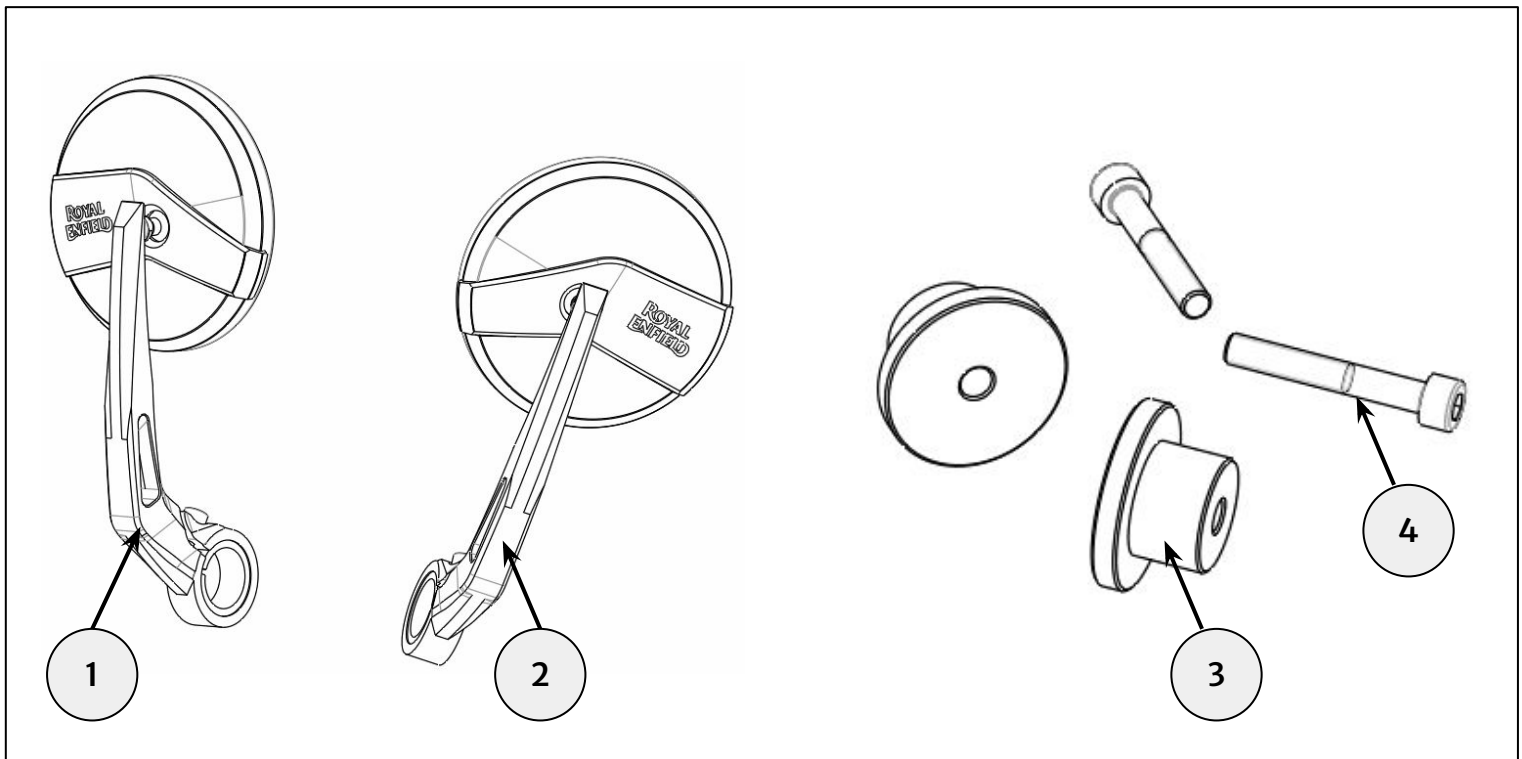

Item	Description	Qty
1	Bar End Mirror, Right hand	1
2	Bar End Mirror, Left hand	1
3	Bar End Mirror Mounting Spacer	2
4	Fixing, M6 X 40mm	2

1 Remove existing OE mirror (1) from the vehicle. Retain it to reuse back, when planned to remove the Bar end mirror mounting (KXL00156).



14mm socket and ratchet.

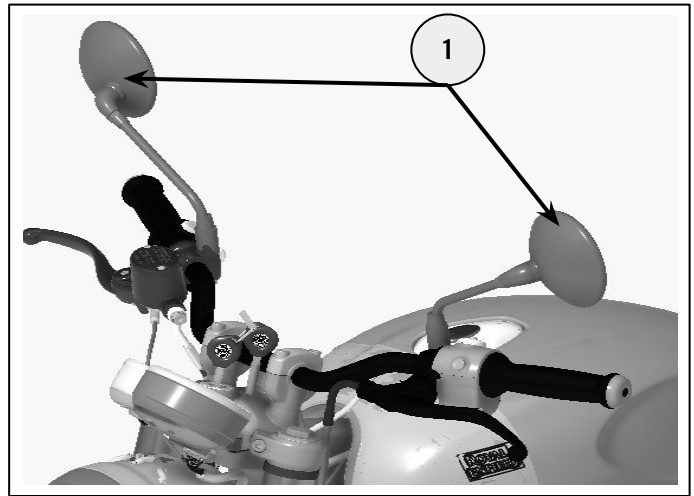

2 Slightly loosen the fixing (1) in the Bar End Mirror, Right Hand.



5mm hexagonal bit and ratchet.

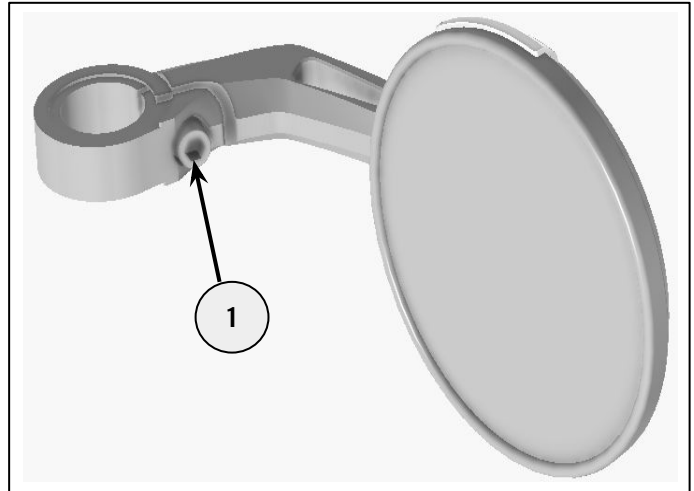

3 Push fit Bar End Mount Spacer (1) into the Bar End Mirror as shown with flange head positioned away from the logo.

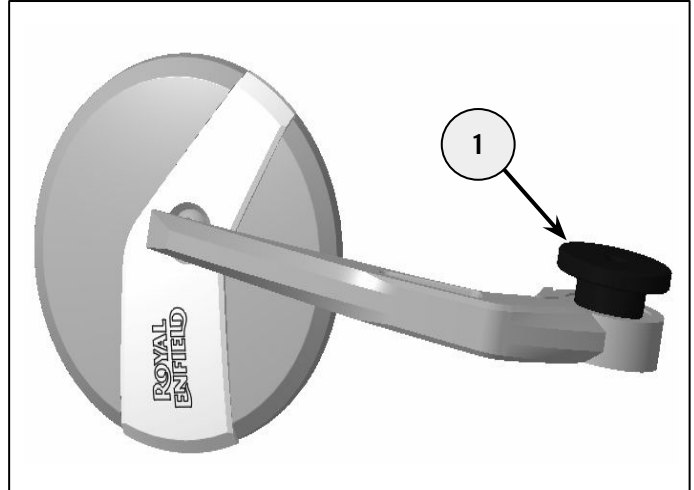

4 Tighten fixing (1) to 8Nm.



5mm hexagonal bit with torque wrench.

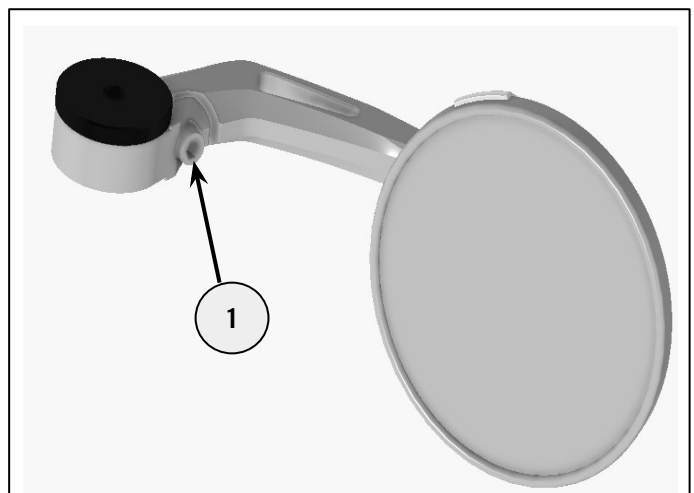

5 Remove the Bar End Weight (1) and fixing (2) Discard the fixing and retain the Bar end weight for reuse.



5mm hexagonal bit and ratchet.

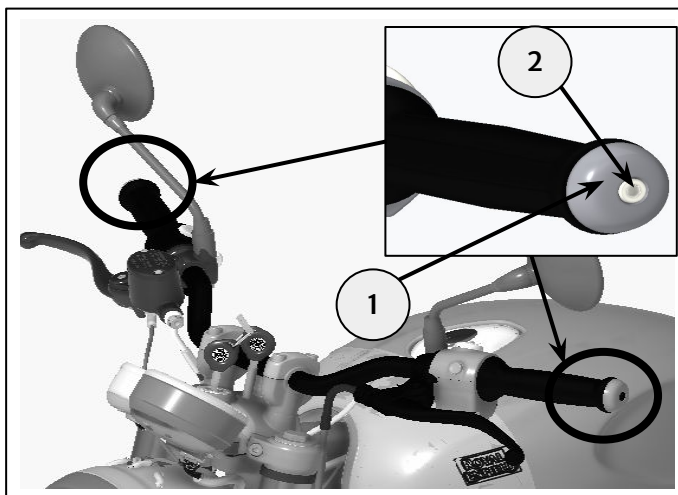

6 Place the Bar End Mirror, Right Hand (1) to the right end of the handlebar with the large spacer surface (2) in contact with the handlebar. Mount the bar end weight (3) as shown using M6 X 40mm fixing (4). Tighten the fixing to **10Nm**.

Remove protective film from mirror, adjust and set the mirror angle to comfortable viewing position.



5mm hexagonal bit with ratchet.

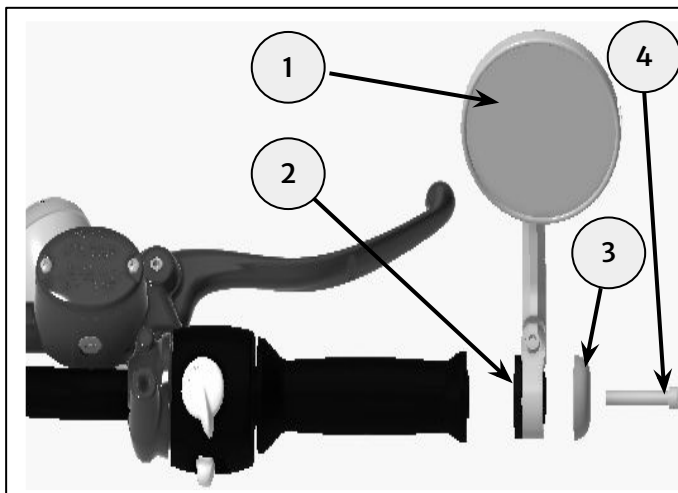

7 Repeat steps 2-6 on the other side using Bar end mirror, Left hand.



Note : Do not fit both bar end mirrors and regular mirrors simultaneously.

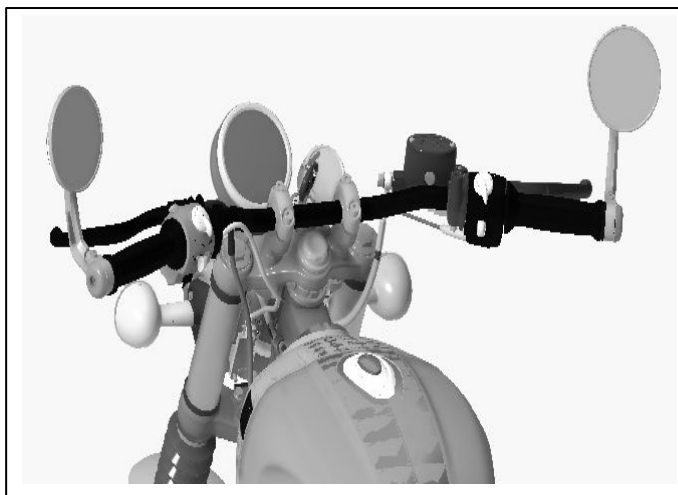

WARNING: After fitting any genuine Royal Enfield accessory always ride the motorcycle with caution and allow time to become familiar with any change in the motorcycle handling characteristics. Failure to become familiar with any change in the motorcycle handling characteristics may cause the motorcycle to become unstable and result in an accident.