

**Part Number:**  
KXA00444

**Models:**  
Himalayan (452cc only)  
Guerrilla

**WARNING:** Royal Enfield genuine accessories are designed to fit only the specific Royal Enfield motorcycle(s) that are specified above. They should not be fitted to any other type of motorcycle. Pay particular attention to the warnings and cautions contained in this instruction, failure to do so may result in an incorrect installation of the accessory which could result in an unsafe riding condition and possible accident. If in any doubt always seek help from your authorised Royal Enfield dealer.

**WARNING:** Before starting any accessory kit installation ensure the motorcycle is supported in a stable condition. Failure to support the motorcycle correctly could lead to motorcycle damage or personal injury.

**WARNING:** All fixings must be tightened to the torque values specified in this instruction. Failure to tighten fixings to the correct torque could result in an unsafe riding condition and possible accident

**CAUTION:** Care should be taken when fitting any accessory kit. Incorrect handling of kit components or the use of incorrect tools could lead to component or motorcycle damage.

**NOTE:** The content of this instruction is subject to change at any time without notice or liability. Royal Enfield reserves the right to revise the information presented at any time.

Parts Supplied: KXA00444

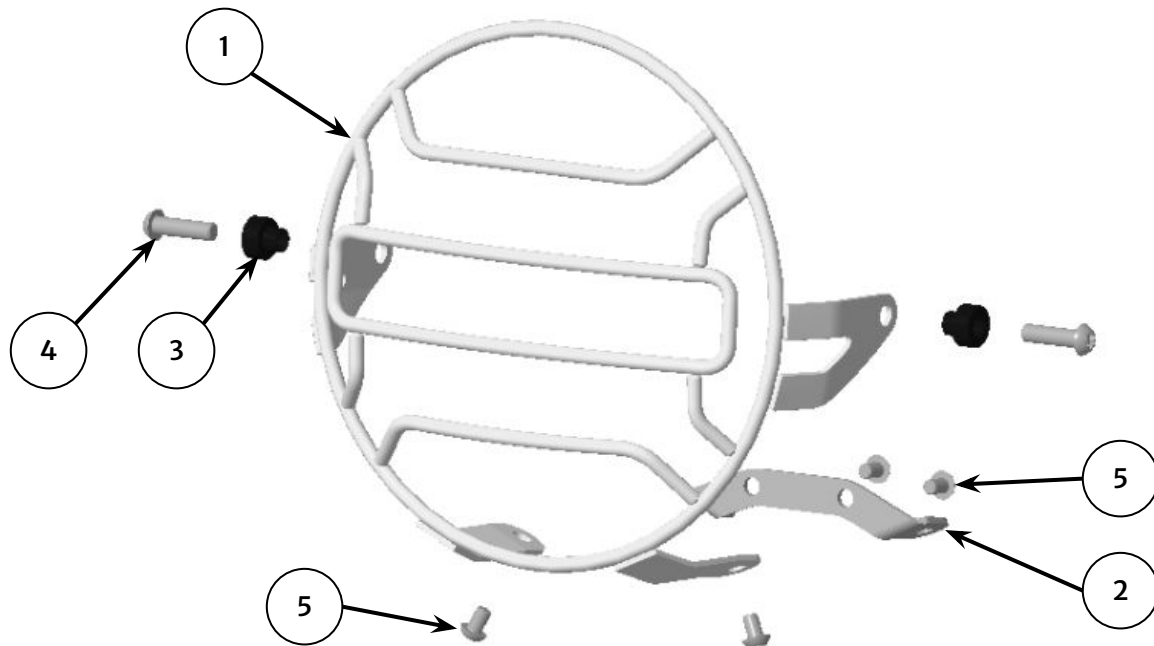

Item	Description	Qty
1	Headlight grill	1
2	Mounting bracket	1
3	Spacer	2
4	Fixing, M6 x 22mm	2
5	Fixing, M5 x 8mm	4

## For Himalayan (452cc) models only:

For Guerrilla models, proceed to step 20:

**1** Remove the seats and disconnect the battery as described in the Owner's Manual.

Disconnect the electrical connector from the headlight (1).

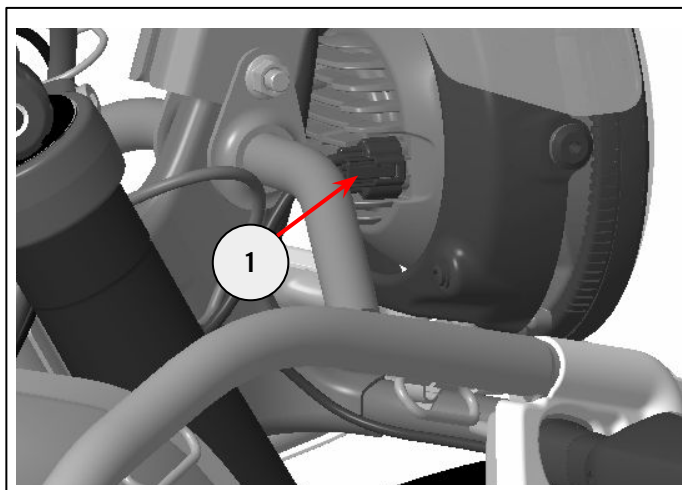

**2** Remove the front mudguard (1) and number plate (if fitted) (2).

Retain the mudguard, number plate and fixings for reuse.



4mm hexagonal bit and ratchet  
Phillips screwdriver

**Note:** Proceed to step 3 if a number plate is fitted.  
Proceed to step 4 if a number plate is not fitted.

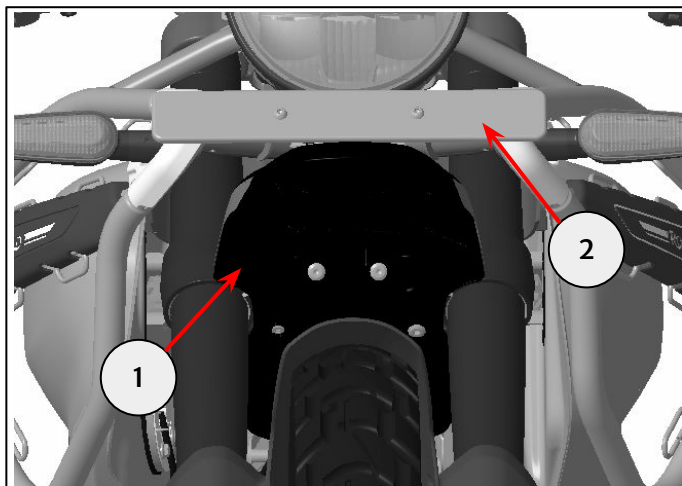

**3** Remove the two fixings (1) securing the number plate bracket (2) and spacers (3) and retain for reuse.



5mm hexagonal bit and ratchet

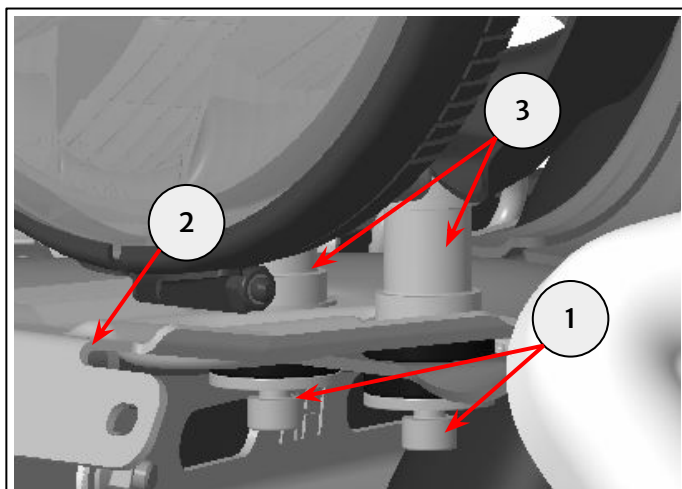

**4** Remove the two fixings on the underside of the headlight unit (1) and retain for reuse.



5mm hexagonal bit and ratchet

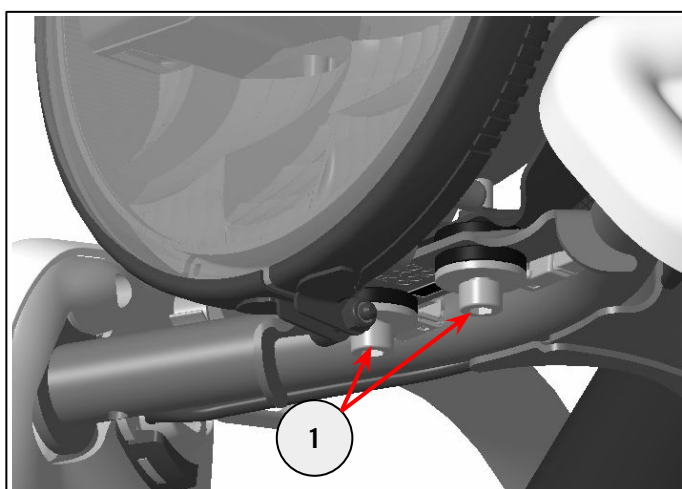

**5** Remove the four fixings (1) securing the screen (2). Retain the fixings and screen for reuse.

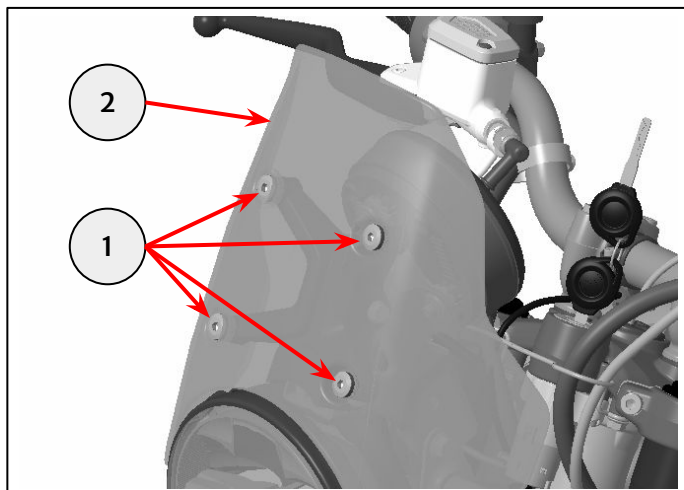
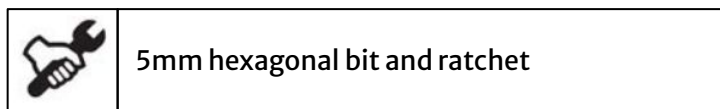

**6** Remove the fixings (1) securing the screen mount (2) and retain for reuse.

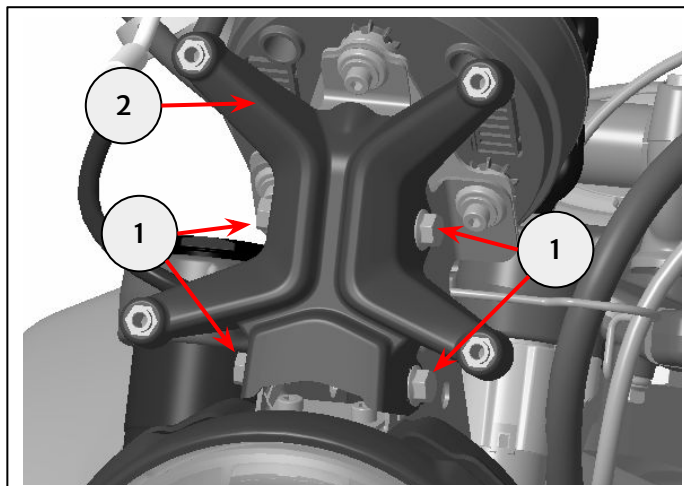
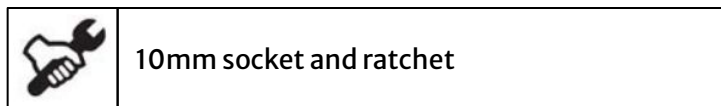

**7** Remove the fixings (1) securing the top of the headlight (2) and retain for reuse.

Carefully remove the headlight unit.

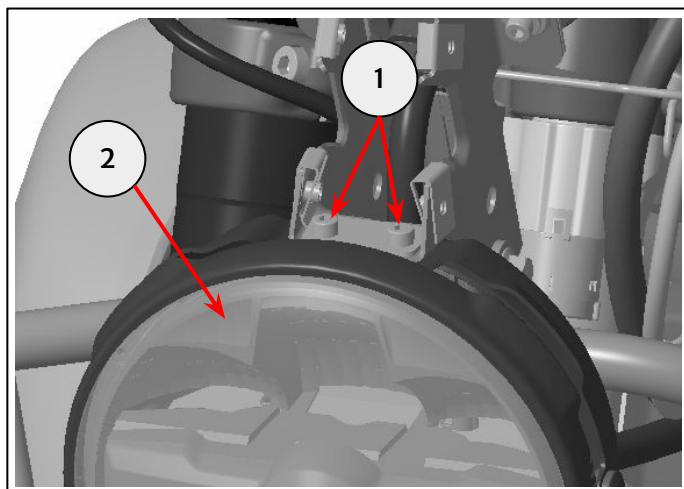
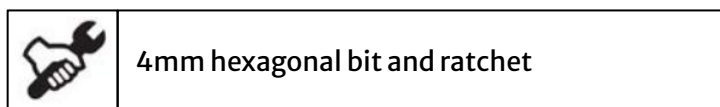

**8** Collect the mounting bracket (1) from the kit and secure to the rear mounts (2) within the headlight unit with two M5 x 8mm fixings from the kit (3).

Tighten the fixings to 5Nm.

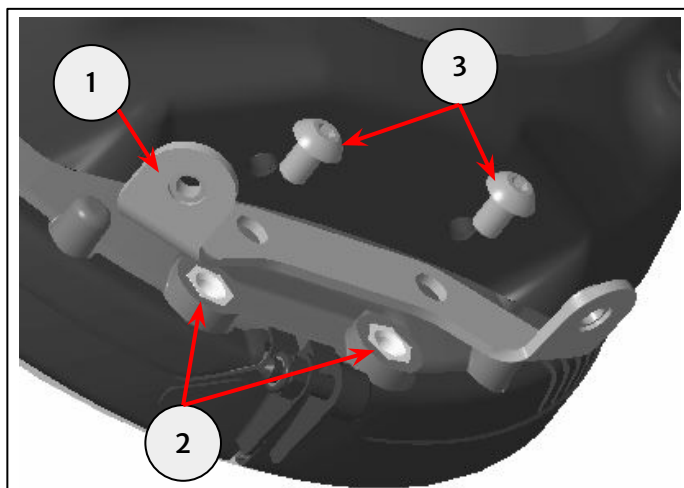
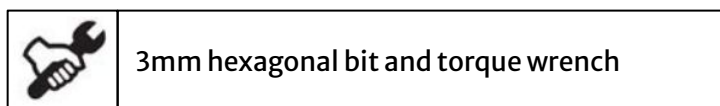

**9** Remove the fixings (1) on each side of the headlight unit and retain for reuse if the motorcycle is to be returned to its original condition.

Collect the two spacers (2) from the kit and place within the grommet (3) on each side of the headlight unit.



5mm hexagonal bit and ratchet

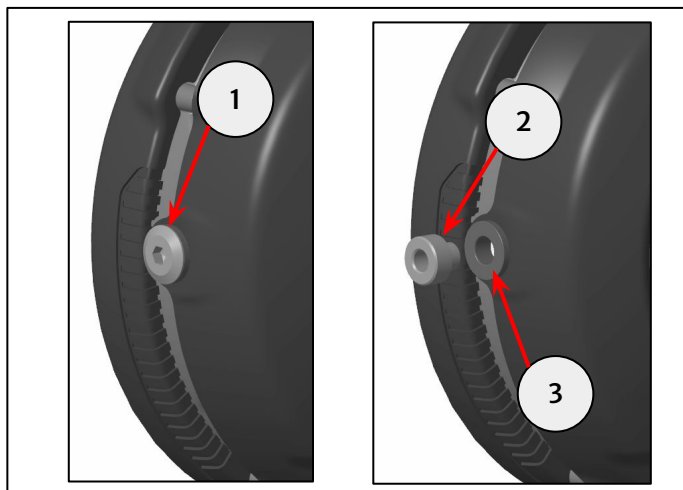

**10** Align the headlight grill (1) as shown. Secure the grill through the side mounts with two M6 x 22mm fixings (2) supplied in the kit.

Secure the headlight grill to the mounting bracket (3) with two M5 x 8mm fixings (4) supplied in the kit.

Tighten the side M6 fixings to **4Nm**.  
Tighten the lower M5 fixings to **5Nm**.



T30 Torx bit and torque wrench  
3mm hexagonal bit and torque wrench

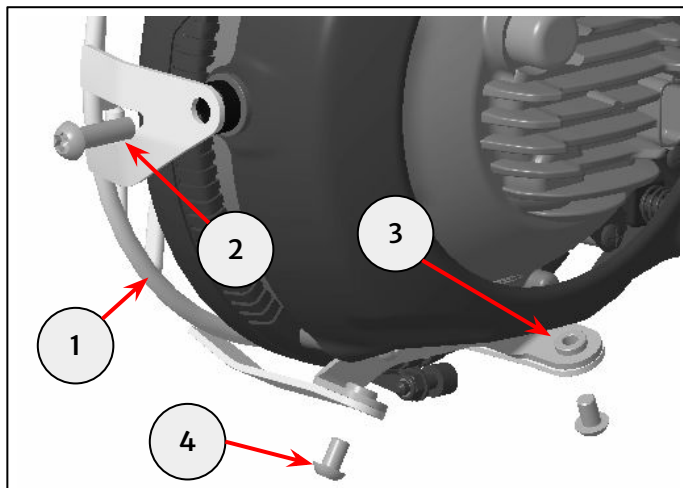

**11** Carefully reassemble the headlight unit and secure with the upper fixings (1) previously removed in step 7.

Tighten fixings to **5Nm**.



4mm hexagonal bit and torque wrench

**Note:** Proceed to step 12 if a number plate is fitted.  
Proceed to step 13 if a number plate is not fitted.

**12** Refit the two spacers (1) and number plate bracket (2) with the fixings (3) previously removed in step 3.

Tighten fixings to **5Nm**.



4mm hexagonal bit and torque wrench

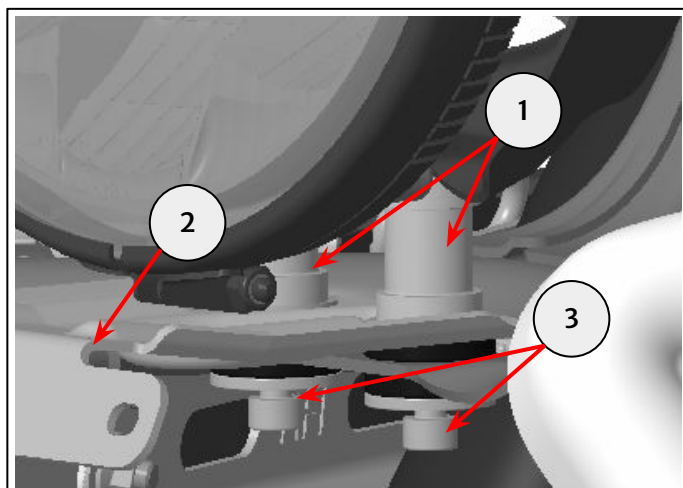
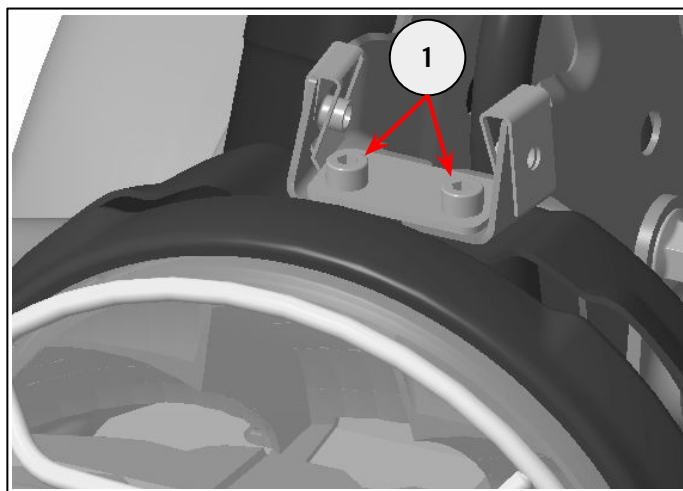

**13** Refit the lower headlight unit fixings previously removed in step 4.

Tighten fixings to **5Nm**.



4mm hexagonal bit and torque wrench

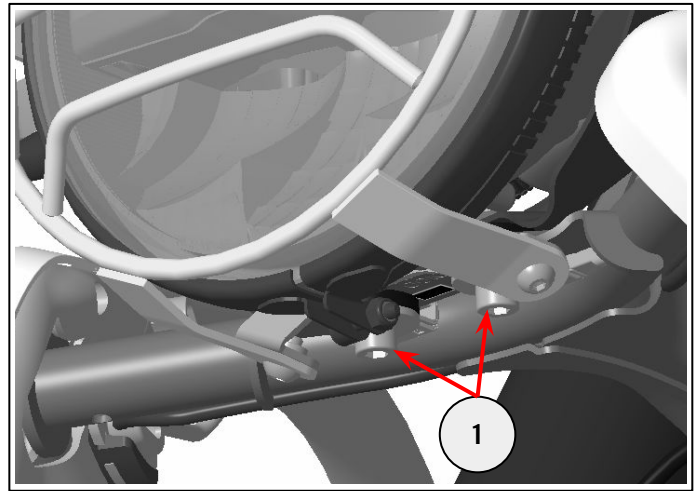

**14** Refit the mudguard (1) with the fixings (2) previously removed in step 2.

Tighten fixings to **5Nm**.



4mm hexagonal bit and torque wrench

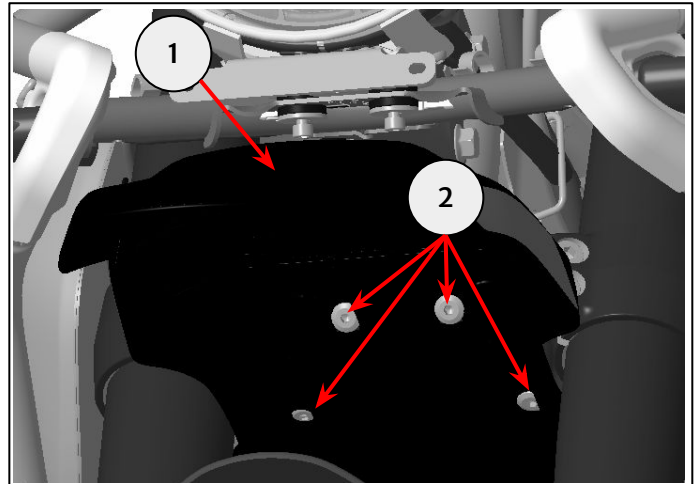

**15** Refit the number plate (1) with the fixings (2) previously removed in step 2.

Tighten fixings to **3Nm**.



3mm hexagonal bit and torque wrench

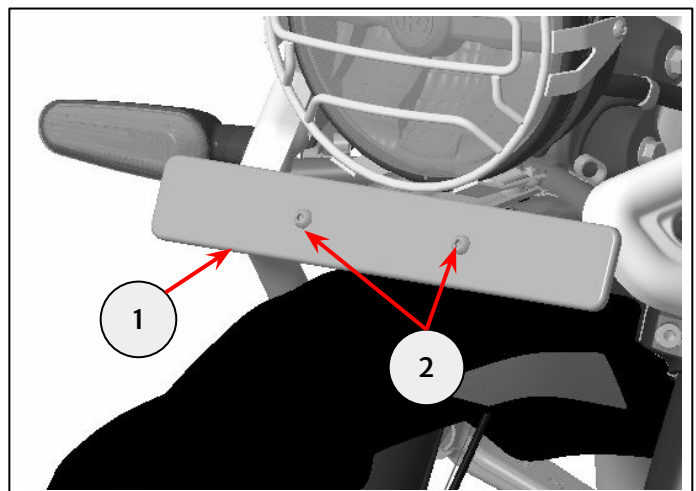

**16** Assemble the screen mount (1) and secure with the fixings (2) previously removed in step 6.

Tighten fixings to **10Nm**.



10mm socket and torque wrench

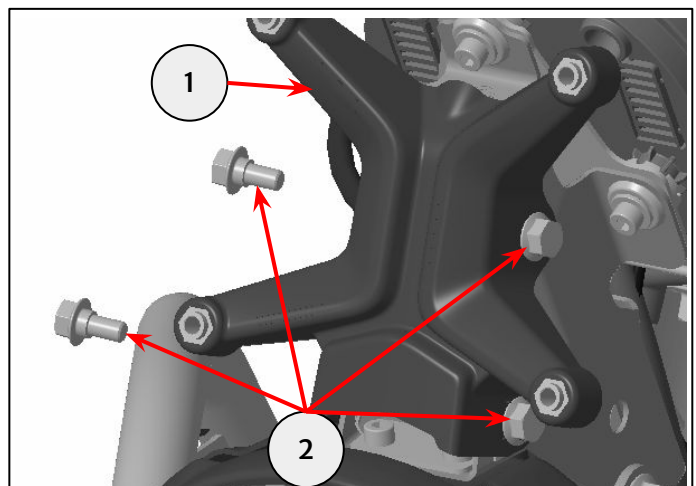

**17** Secure the screen (1) to the screen mount with the fixings (2) previously removed in step 5.

Tighten fixings to **10Nm**.



5mm hexagonal bit and torque wrench

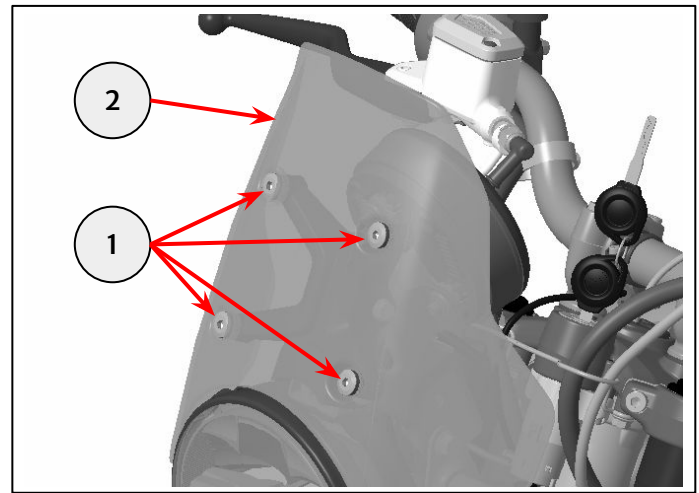

**18** Reconnect the electrical connector (1) to the headlight unit.

Align headlight angle as described in the Owner's Manual.

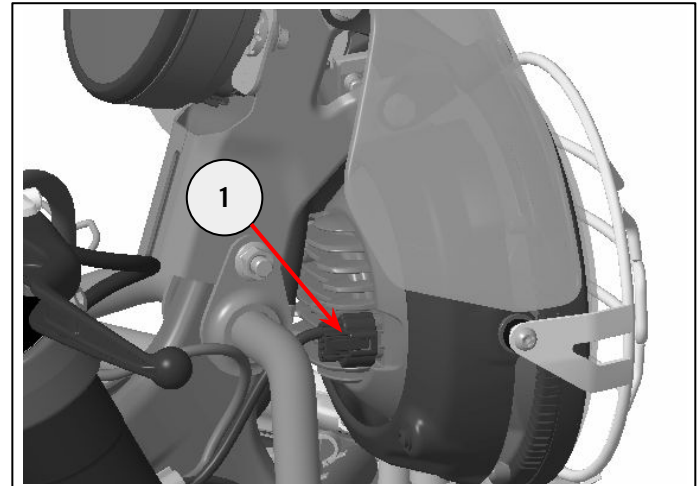

**19** Reconnect the battery and refit the seats as described in the Owner's Manual.



**WARNING:** After fitting any genuine Royal Enfield accessory always ride the motorcycle with caution and allow time to become familiar with any change in the motorcycle handling characteristics. Failure to become familiar with any change in the motorcycle handling characteristics may cause the motorcycle to become unstable and result in an accident.

## For Guerrilla models only:

**20** Remove the seat and disconnect the battery as described in the Owner's Manual.

Disconnect the electrical connector from the headlight (1).

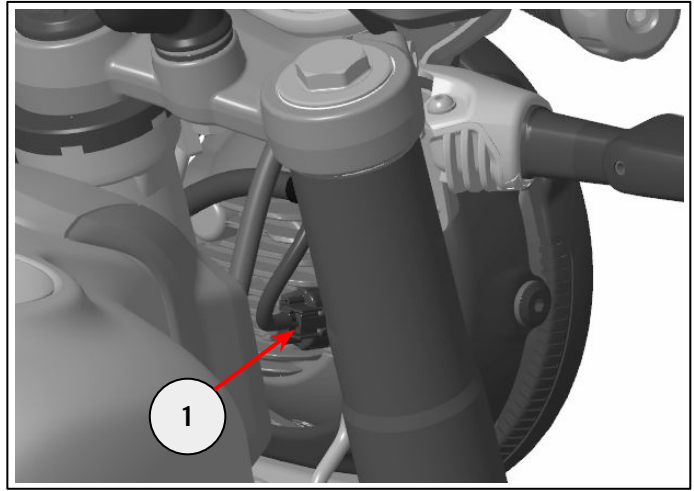

**21** Remove the number plate (if fitted) (1).

Retain the number plate and fixings for reuse.



4mm hexagonal bit and ratchet  
Phillips screwdriver

**Note:** Proceed to step 22 if a number plate is fitted.  
Proceed to step 23 if a number plate is not fitted.

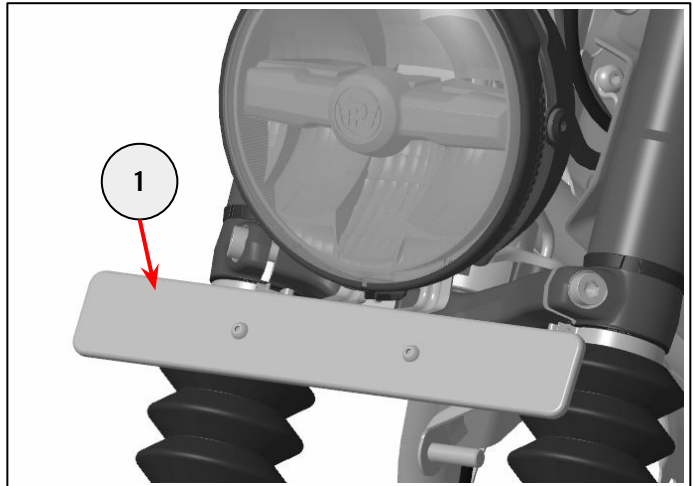

**22** Remove the two fixings (1) securing the number plate bracket (2) retain for reuse.



5mm hexagonal bit and ratchet

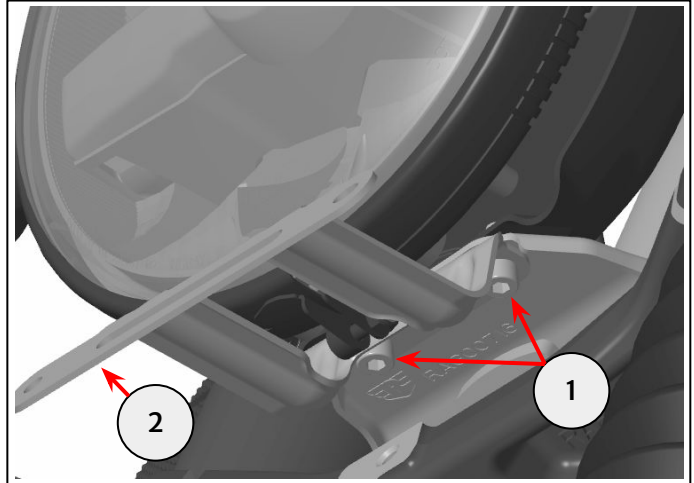

**23** Remove the two fixings on the underside of the headlight unit (1) and retain for reuse.



5mm hexagonal bit and ratchet

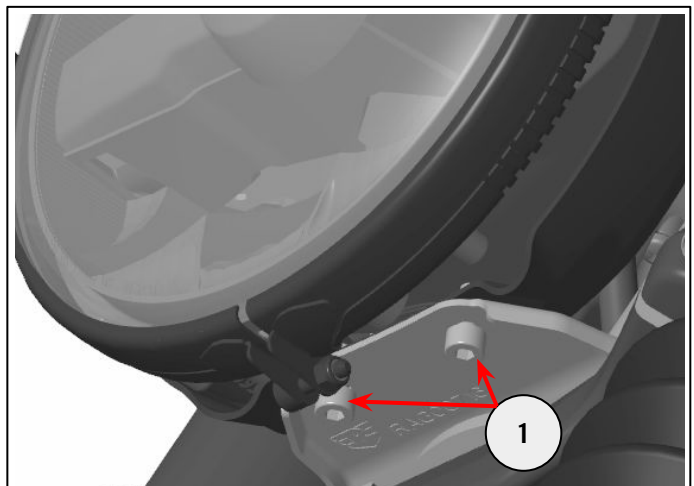

## 24 Remove the indicator mount (1).

Retain the indicator mount and fixings for reuse.



3mm hexagonal bit and ratchet  
5mm hexagonal bit and ratchet

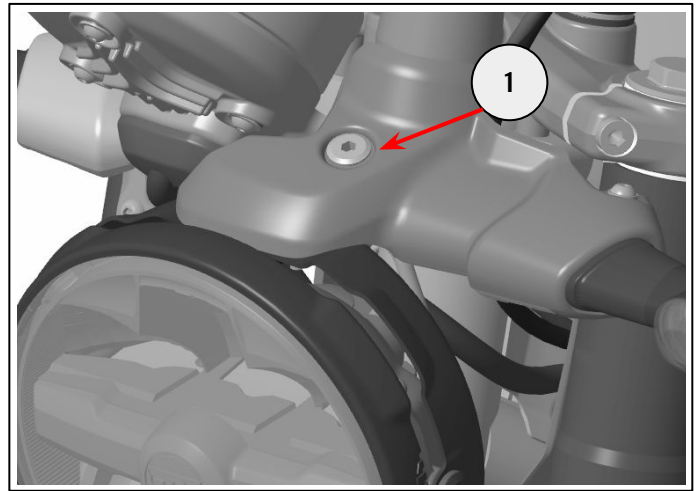

## 25 Remove the fixings (1) securing the top of the headlight (2) and retain for reuse.

Carefully remove the headlight unit.



4mm hexagonal bit and ratchet

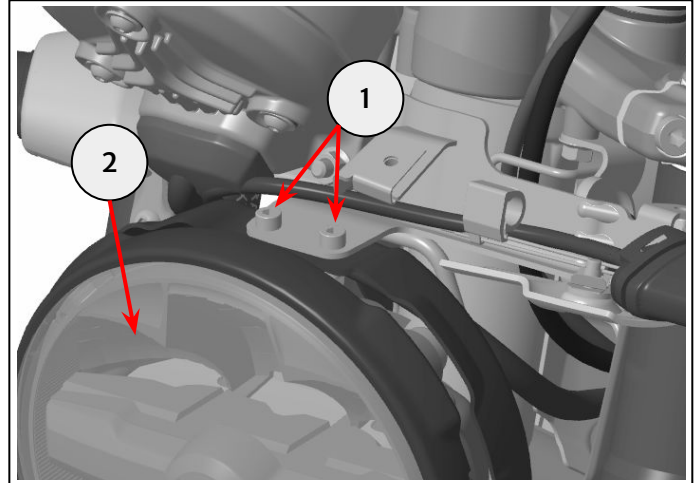

## 26 Carefully reassemble the headlight unit and secure with the upper fixings (1) previously removed in step 25.

Tighten fixings to **5Nm**.



4mm hexagonal bit and torque wrench

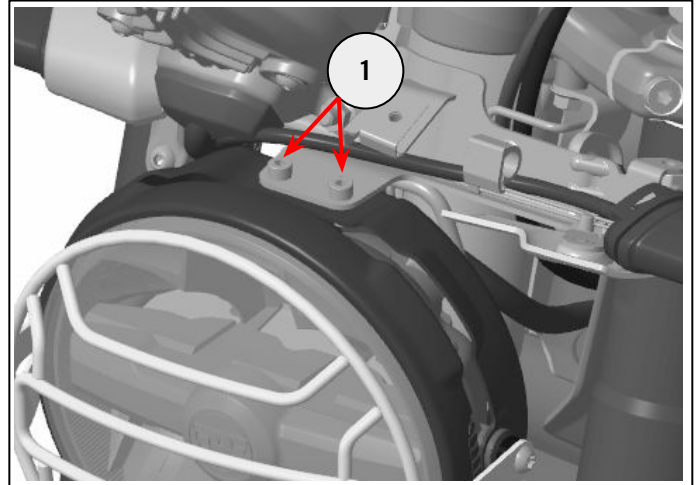

## 27 Refit indicator mount (1) with the fixings (2) & (3) previously removed in step 24.

Tighten fixing (2) to **10Nm**.

Tighten fixing (3) to **5Nm**.



5mm hexagonal bit and torque wrench  
3mm hexagonal bit and torque wrench

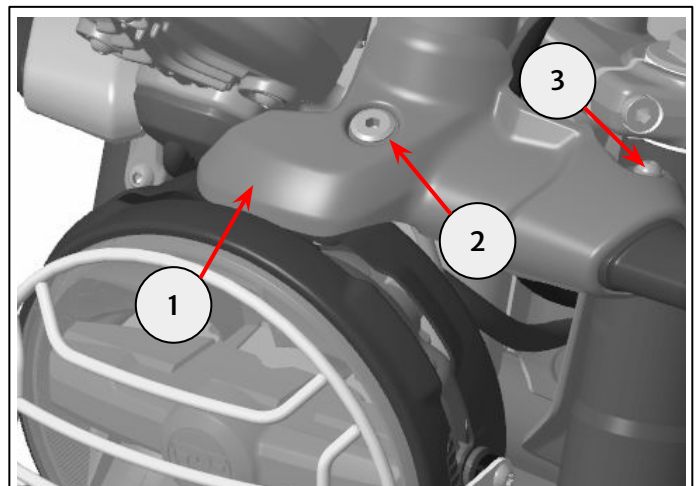

**Note:** Proceed to step 29 if a number plate is fitted.  
Proceed to step 28 if a number plate is not fitted.

**28** Refit the two fixings (1) on the underside of the headlight unit previously removed in step 23.

Tighten fixings to **5Nm**.

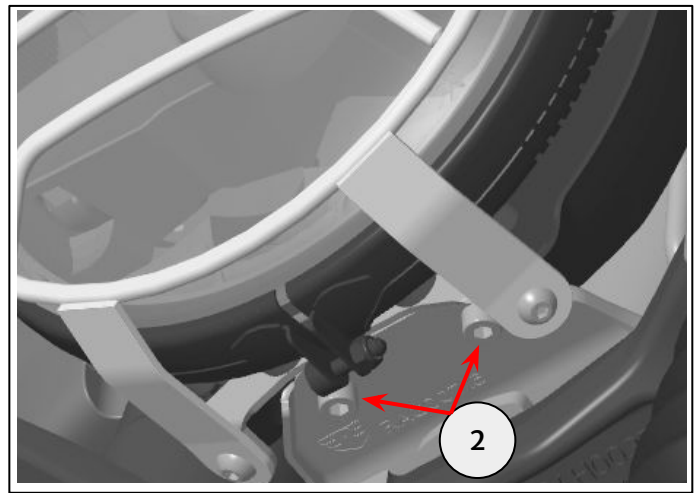
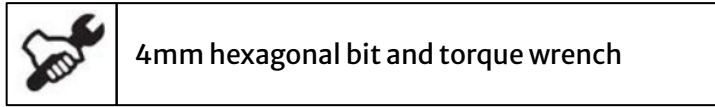

**29** Refit the number plate bracket (1) with the fixings (2) previously removed in step 22.

Tighten fixings to **5Nm**.

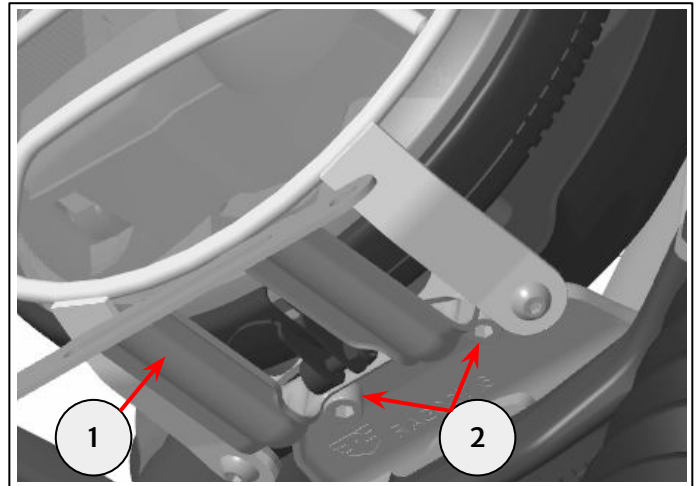
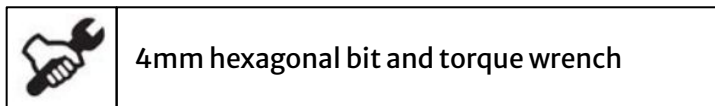

**30** Refit the number plate (1) with the fixings (2) previously removed in step 21.

Tighten fixings to **3Nm**.

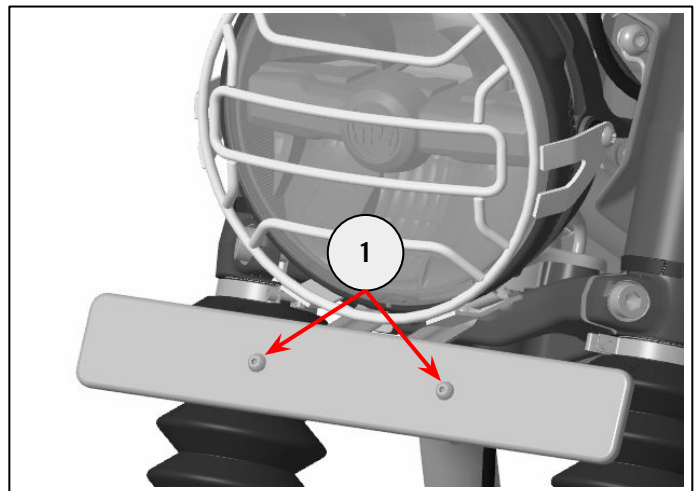
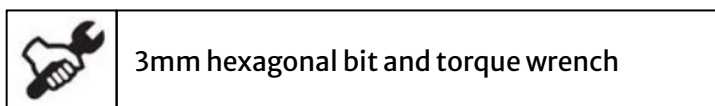

**31** Reconnect the battery and refit the seat as described in the Owner's Manual.



**WARNING:** After fitting any genuine Royal Enfield accessory always ride the motorcycle with caution and allow time to become familiar with any change in the motorcycle handling characteristics. Failure to become familiar with any change in the motorcycle handling characteristics may cause the motorcycle to become unstable and result in an accident.