

Part Number:
KXA00224

Models:
Super Meteor
VIN starting with ME3P7B6FHN10007

WARNING: Royal Enfield genuine accessories are designed to fit only the specific Royal Enfield motorcycle(s) that are specified above. They should not be fitted to any other type of motorcycle. Pay particular attention to the warnings and cautions contained in this instruction, failure to do so may result in an incorrect installation of the accessory which could result in an unsafe riding condition and possible accident. If in any doubt always seek help from your authorised Royal Enfield dealer.

WARNING: Before starting any accessory kit installation ensure the motorcycle is supported in a stable condition. Failure to support the motorcycle correctly could lead to motorcycle damage or personal injury.

WARNING: All fixings must be tightened to the torque values specified in this instruction. Failure to tighten fixings to the correct torque could result in an unsafe riding condition and possible accident

CAUTION: Care should be taken when fitting any accessory kit. Incorrect handling of kit components or the use of incorrect tools could lead to component or motorcycle damage.

NOTE: The content of this instruction is subject to change at any time without notice or liability. Royal Enfield reserves the right to revise the information presented at any time.

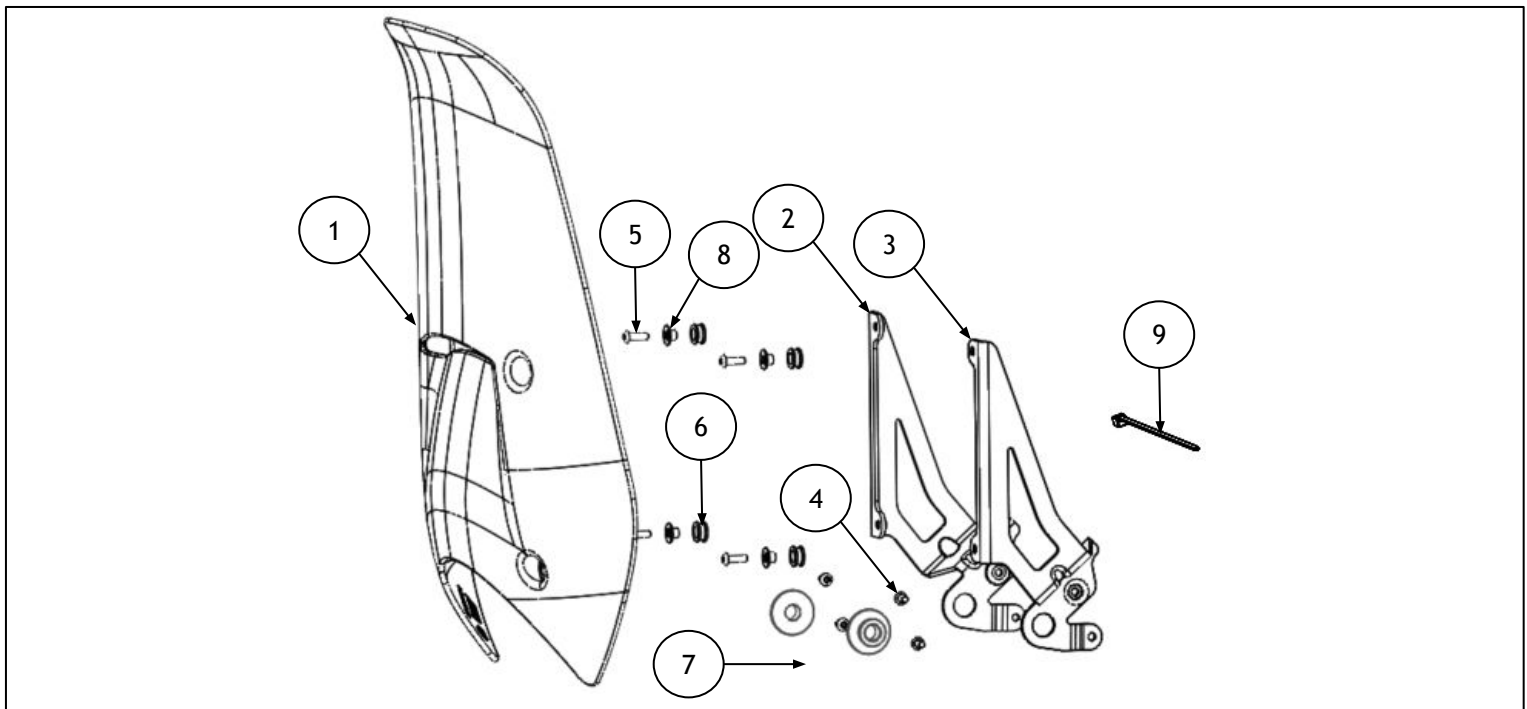

Item	Description	Qty
1	Touring screen	1
2	Touring screen bracket, right hand	1
3	Touring screen bracket, left hand	1
4	Fixing, M5 x 10mm	4
5	Fixing, M5 x 16mm	4
6	Rubber grommet	4
7	Large rubber Grommet	2
8	Top hat	4
9	Cable tie	1

1 Fit the rubber grommets (1) from the kit onto the touring screen (2) then, fit the flanged insert (3) from the kit into the rubber grommet.

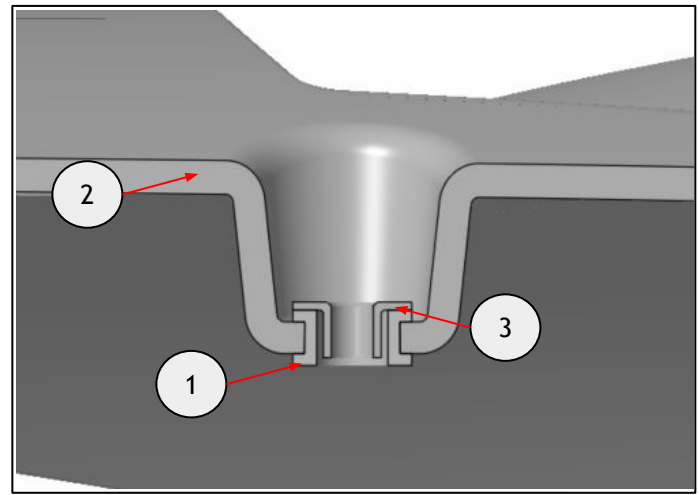

2 Remove the headlight (1) from its mount by removing the fixings (2), top hats (3) and the rubber grommets (4) underneath. Gently pull the headlight assembly forward.

Retain the fixings and top hats for reuse. Retain the rubber grommets for reuse if the motorcycle is to be returned to its original condition.

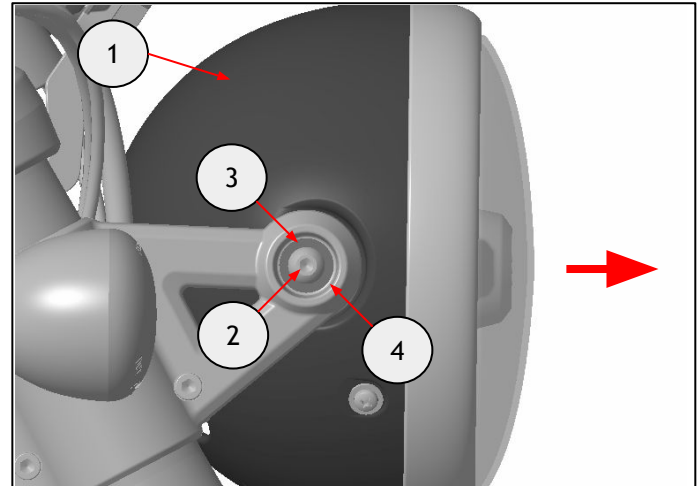

3 Loosen the headlamp brackets (1) front fixings (2). Rotate the brackets outward.

Note: Headlight assembly removed for visual purpose only.

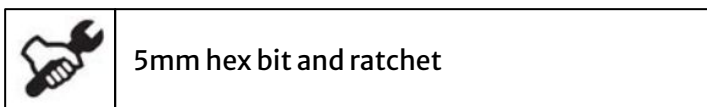
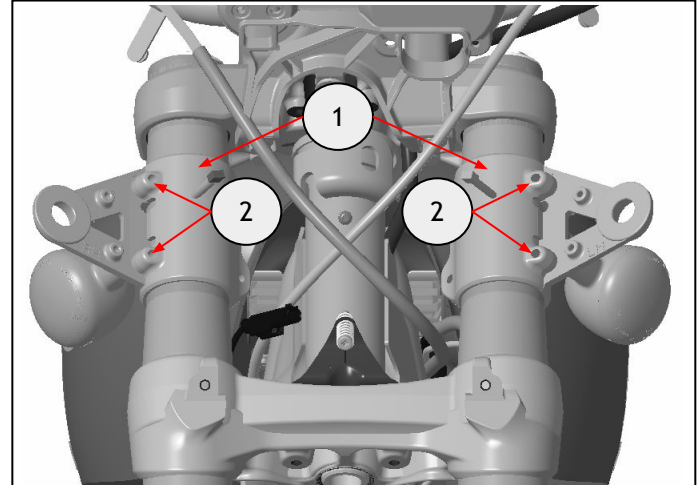

4 Loosely fit the two brackets (1) on the headlight mounts (2) using the M5 x 10mm fixings (3) from the kit.

Note: Headlight assembly removed for visual purpose only.

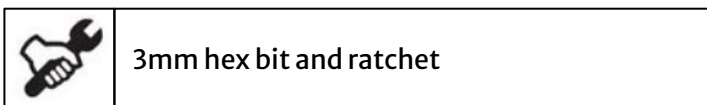
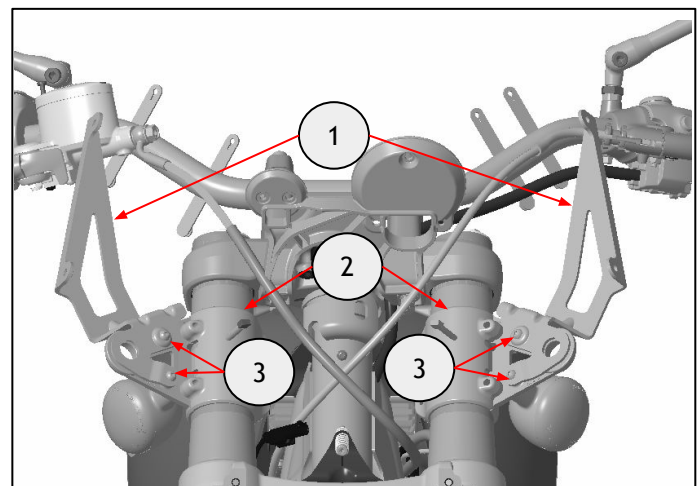

5 Fit the two large rubber grommets (1) from the kit through the headlamp and screen brackets, then fit the top hats (2) removed in step 2 into the rubber grommets (1).

Tighten the fixings (3) to **5Nm**.

Note: Headlight assembly removed for visual purpose only.



3mm hex bit and torque wrench

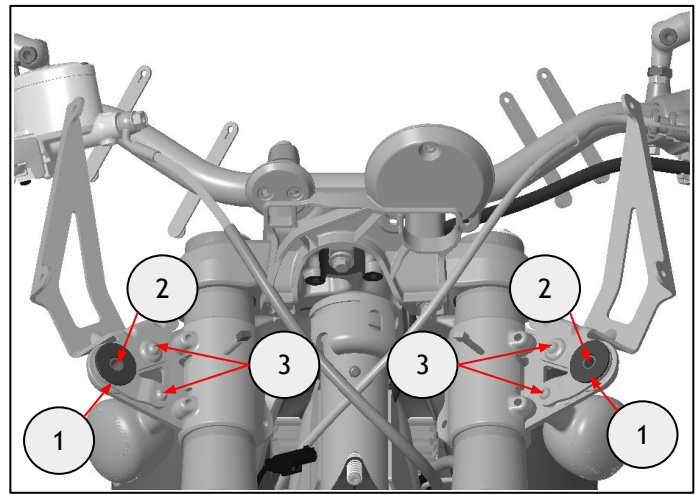

6 Fix the headlamp assembly (1) onto the mounts (2) using the M8 x 25mm fixings (3) removed in step 2.

Tighten the fixings (3) to **10Nm**.

Tighten the fixings (4) to **10Nm**.



5mm hex bit and torque wrench

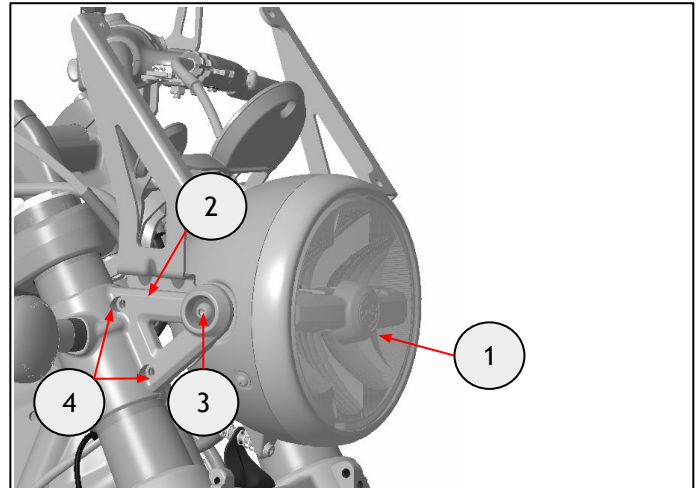

7 Assemble the Touring Screen (1) on the brackets (2) using the M5 x 16mm fixings (3) from the kit.

Tighten the fixings (3) to **5Nm**.



3mm hex bit and torque wrench

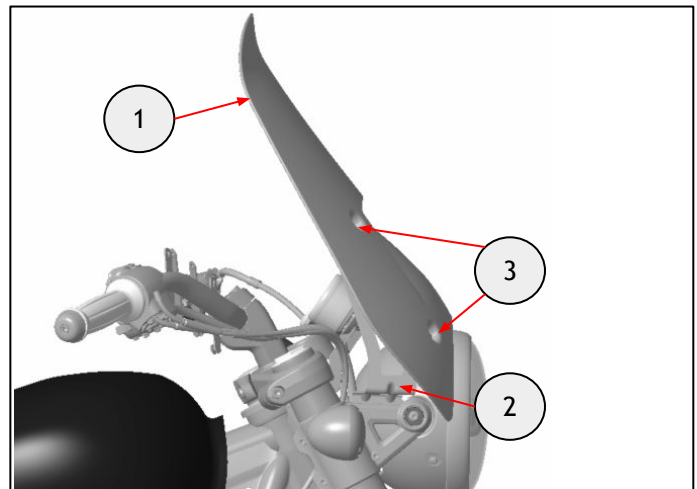

8 Attach the throttle cables (1) with the ABS hose (2) using the cable tie (3) from the kit to prevent rubbing against the screen brackets.

Turn the handlebar from full right lock to full left lock to ensure the throttle cables and ABS hoses are not rubbing on the screen bracket.

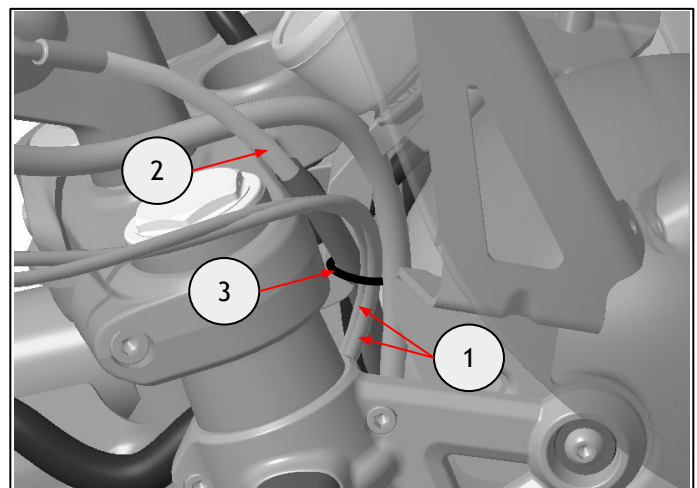

9 To adjust the headlamp, position the motorcycle upright, with the rider seated and with a distance of 6.2 meters between a wall and the center of the front wheel contact patch.

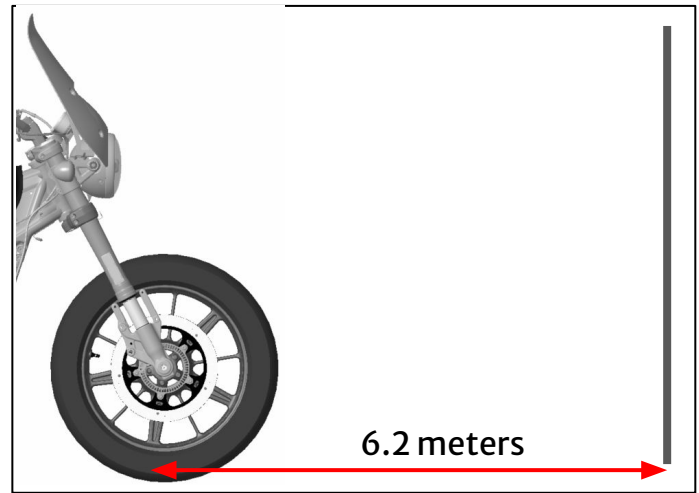

10 Ensure the motorcycle is perpendicular to the wall and upright.

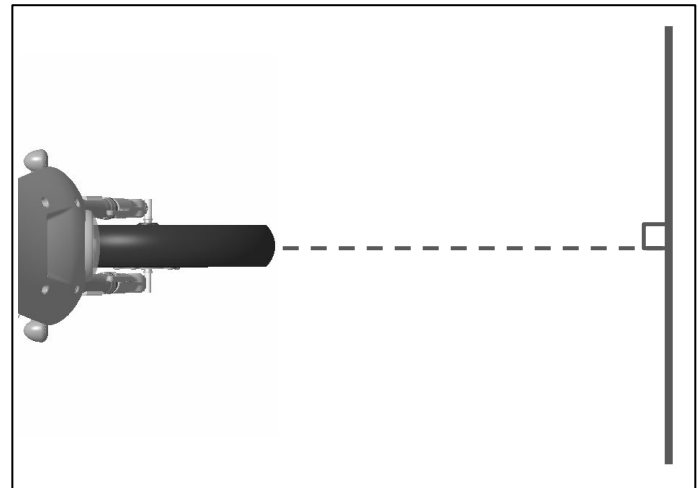

11 Turn the low beam on, the top of the beam must be between the two limit lines and as close to the target as possible.

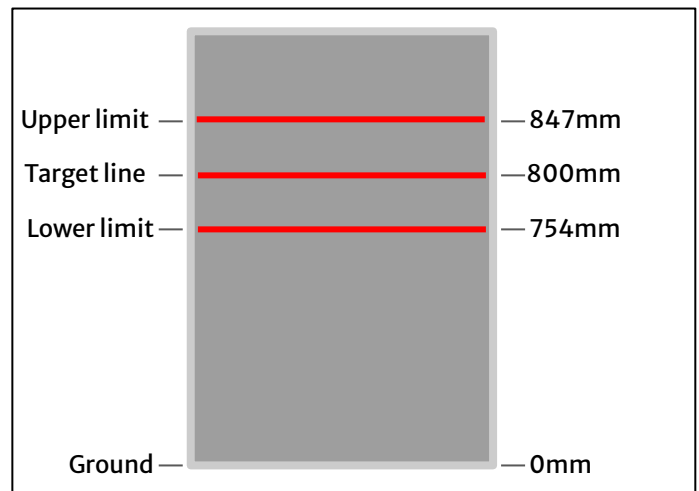

12 If the low beam criteria is not met, adjust the headlight angle using the adjuster bolt (1) and test again.

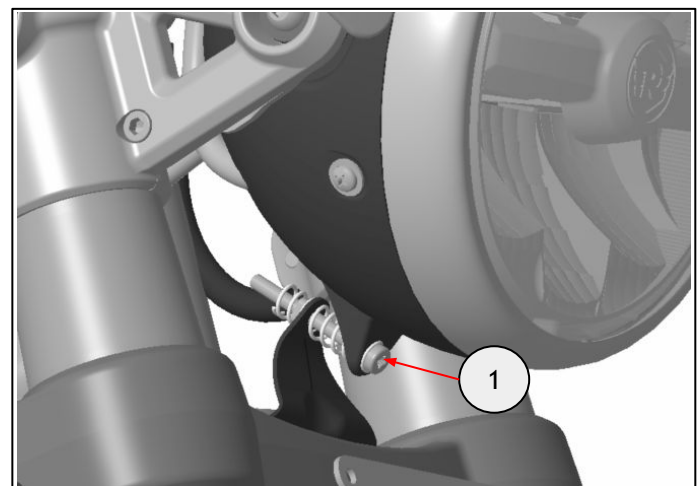

Phillips screwdriver



WARNING: After fitting any genuine Royal Enfield accessory always ride the motorcycle with caution and allow time to become familiar with any change in the motorcycle handling characteristics. Failure to become familiar with any change in the motorcycle handling characteristics may cause the motorcycle to become unstable and result in an accident.