

Part Number:
1990527

Models:
Interceptor Bear 650 (all years)

WARNING: Royal Enfield genuine accessories are designed to fit only the specific Royal Enfield motorcycle(s) that are specified above. They should not be fitted to any other type of motorcycle. Pay particular attention to the warnings and cautions contained in this instruction, failure to do so may result in an incorrect installation of the accessory which could result in an unsafe riding condition and possible accident. If in any doubt always seek help from your authorised Royal Enfield dealer.

WARNING: Before starting any accessory kit installation ensure the motorcycle is supported in a stable condition. Failure to support the motorcycle correctly could lead to motorcycle damage or personal injury.

WARNING: All fixings must be tightened to the torque values specified in this instruction. Failure to tighten fixings to the correct torque could result in an unsafe riding condition and possible accident

CAUTION: Care should be taken when fitting any accessory kit. Incorrect handling of kit components or the use of incorrect tools could lead to component or motorcycle damage.

NOTE: The content of this instruction is subject to change at any time without notice or liability. Royal Enfield reserves the right to revise the information presented at any time.

Parts Supplied: 1990527

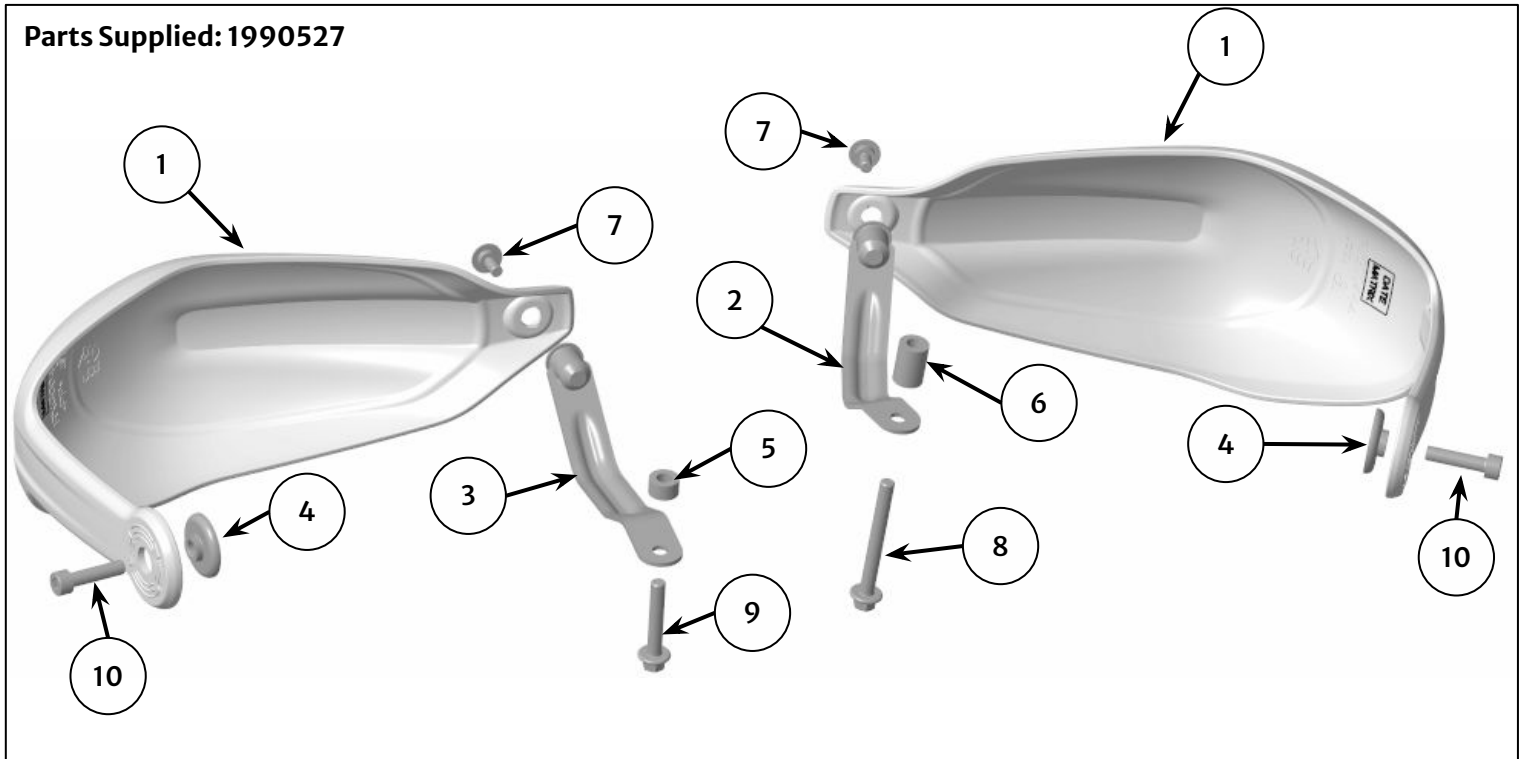

Item	Description	Qty
1	Handguard Shroud (non handed)	2
2	Bracket, RH	1
3	Bracket, LH	1
4	Bar end spacer	2
5	Spacer, M6, short	1
6	Spacer, M6, long	1
7	Fixing, M5 x 12.5mm	2
8	Fixing, M6 x 55mm	1
9	Fixing, M6 x 35mm	1
10	Fixing, M6 x 25mm (thread-locked)	2

1 Remove the left hand handlebar bar end weight (1) and retain for reuse.

Retain the fixing (2) for reuse if the motorcycle is to be returned to its original condition.

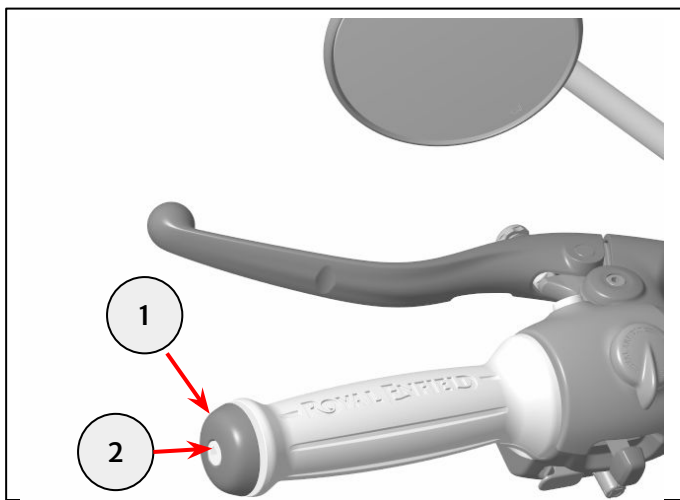
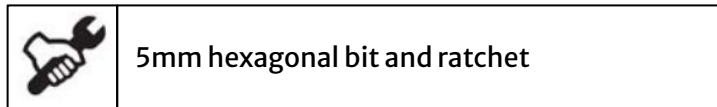

2 Assemble a handguard shroud (1) to the left hand bracket (2) with a M5 x 12.5mm fixing (3) from the kit, as shown.

Do not fully tighten the fixing at this stage.

Note: The left hand bracket is the longer of the two brackets.

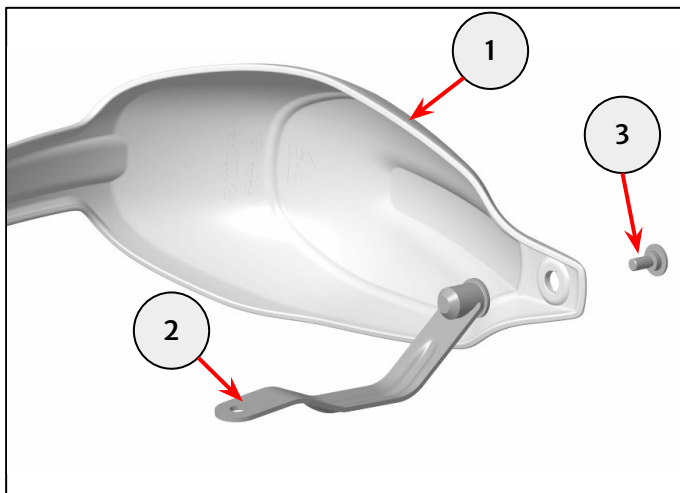
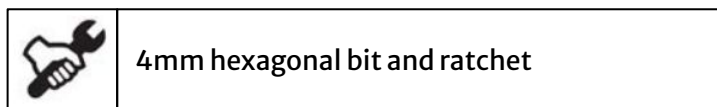

3 Fit a bar end spacer (1), left hand handguard (2) and reused bar end weight (3) to the handlebar end, as shown. Secure with a M6 x 25mm thread-locked fixing (4) from the kit.

Do not fully tighten the fixing at this stage.

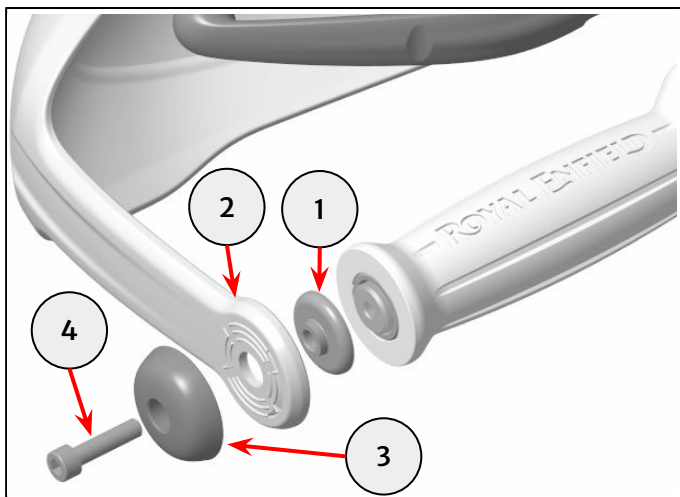
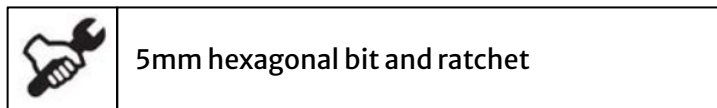

4 Remove the clutch clamp fixing (1) and retain for reuse if the motorcycle is to be returned to its original condition.

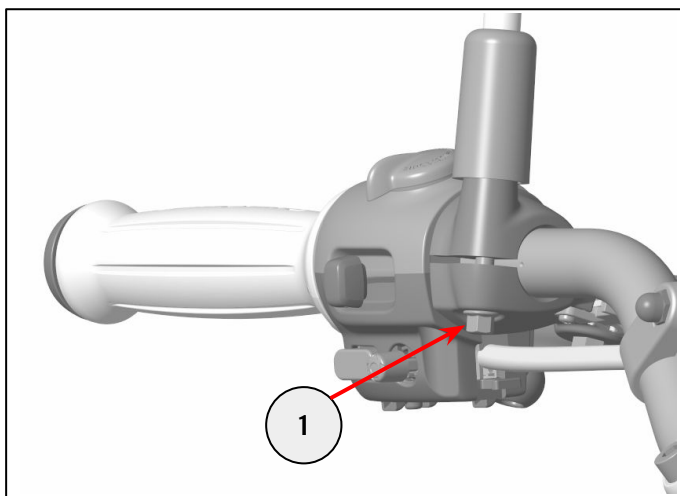
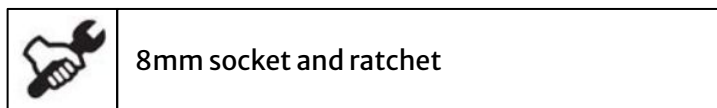

5 Locate the short spacer (1) between the clutch mount (2) and bracket (3). Align the clutch mount to the alignment mark (4) and secure with a M6 x 35mm fixing (5) from the kit. Tighten to **12Nm**.

Note: Take extra care to ensure the cable (6) is routed below the bracket, as shown.



8mm socket and torque wrench

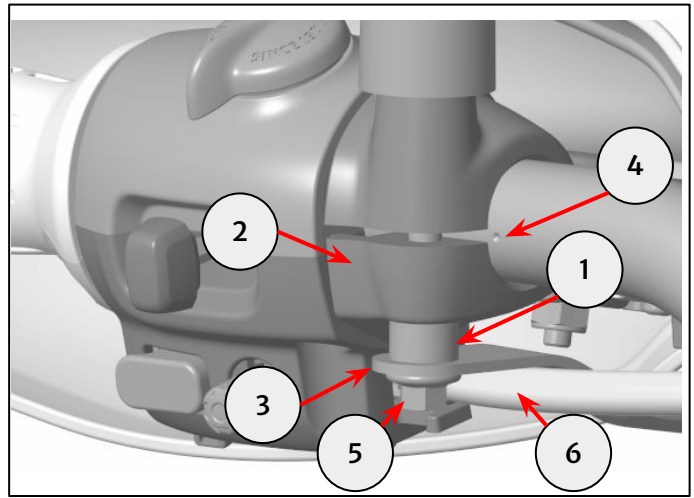

6 Align the handguard centrally to the clutch lever and tighten the two remaining fixings as below:

- M5 x 12.5mm fixing (1) to **5Nm**
- M6 x 25mm fixing (2) to **10Nm**



4mm and 5mm hexagonal bit and torque wrench

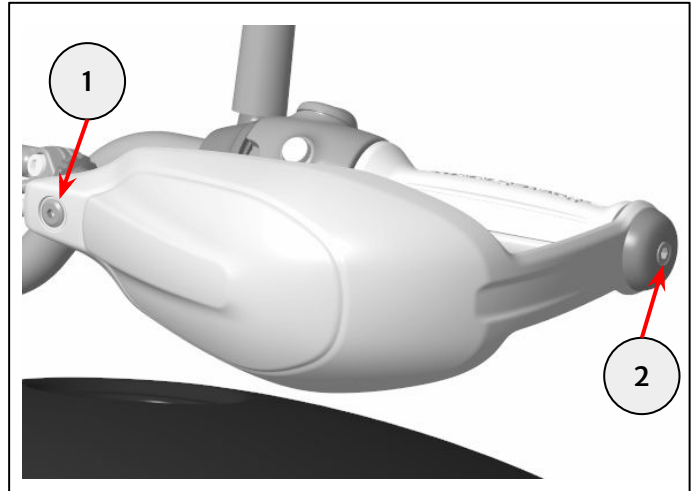

7 Repeat steps 1-3 for the right hand side.



8 Remove the forward front master cylinder clamp fixing (1) and retain for reuse if the motorcycle is to be returned to its original condition.



8mm socket and ratchet

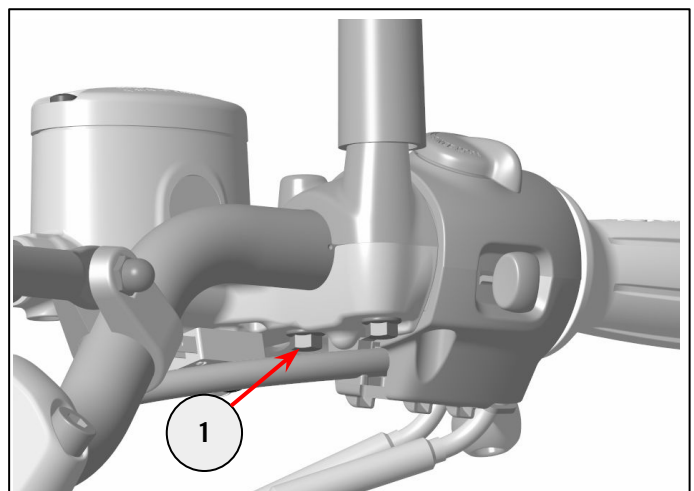

9 Locate the long spacer (1) between the front master cylinder mount (2) and bracket (3). Align the front master cylinder mount to the alignment mark (4) and secure with a M6 x 55mm fixing (5) from the kit. Tighten to **10Nm**.

Note: Take extra care to ensure the cable (6) is routed behind the spacer (1), as shown.



8mm socket and torque wrench

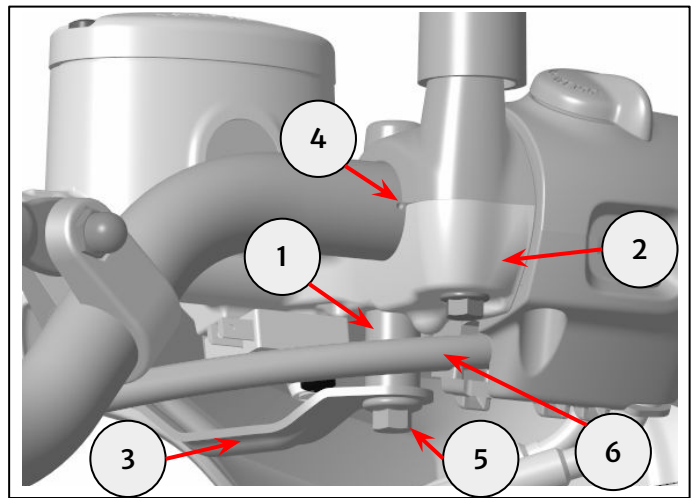

10 Align the handguard centrally to the brake lever and tighten the two remaining fixings:

- M5 x 12.5mm fixing (1) to **5Nm**
- M6 x 25mm fixing (2) to **10Nm**



4mm and 5mm hexagonal bit and torque wrench



WARNING: After fitting any genuine Royal Enfield accessory always ride the motorcycle with caution and allow time to become familiar with any change in the motorcycle handling characteristics. Failure to become familiar with any change in the motorcycle handling characteristics may cause the motorcycle to become unstable and result in an accident.