

Part Number:

KXA00030, KXA00031, KXA00181,
KXA00182

Models:

Classic 350 , Bullet 350, Goan Classic 350, Meteor
350

WARNING: Royal Enfield genuine accessories are designed to fit only the specific Royal Enfield motorcycle(s) that are specified above. They should not be fitted to any other type of motorcycle. Pay particular attention to the warnings and cautions contained in this instruction, failure to do so may result in an incorrect installation of the accessory which could result in an unsafe riding condition and possible accident. If in any doubt always seek help from your authorised Royal Enfield dealer.

WARNING: Before starting any accessory kit installation ensure the motorcycle is supported in a stable condition. Failure to support the motorcycle correctly could lead to motorcycle damage or personal injury.

WARNING: All fixings must be tightened to the torque values specified in this instruction. Failure to tighten fixings to the correct torque could result in an unsafe riding condition and possible accident

CAUTION: Care should be taken when fitting any accessory kit. Incorrect handling of kit components or the use of incorrect tools could lead to component or motorcycle damage.

NOTE: The content of this instruction is subject to change at any time without notice or liability. Royal Enfield reserves the right to revise the information presented at any time.

Parts Supplied: KXA00030, KXA00031, KXA00181, KXA00182

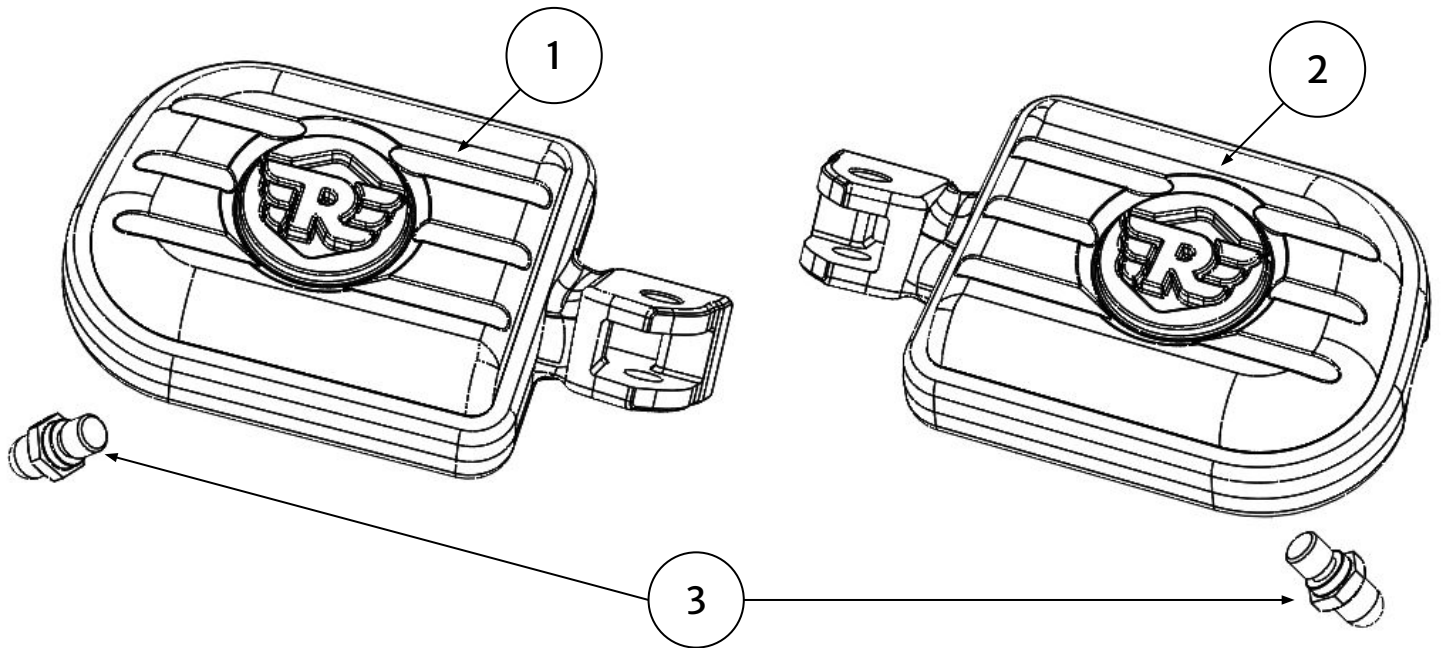

Item	Description	Qty
1	Deluxe Footpeg, LH	1
2	Deluxe Footpeg, RH	1
3	Footpeg feeler pegs	2

1 Remove the circlip (1) from the rider footrest clevis pin (2)



External circlip pliers



Caution - Wear eye protection, circlip may eject from pliers

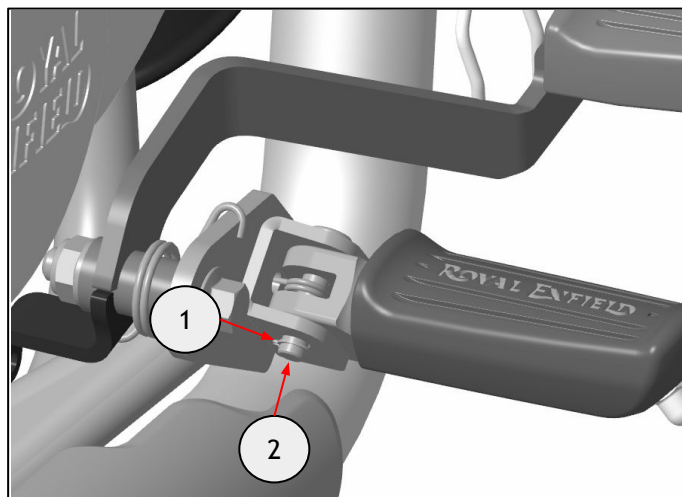

2 Hold the rider footrest (1) in position, and remove the clevis pin (2). Retain the clevis pin for reuse.

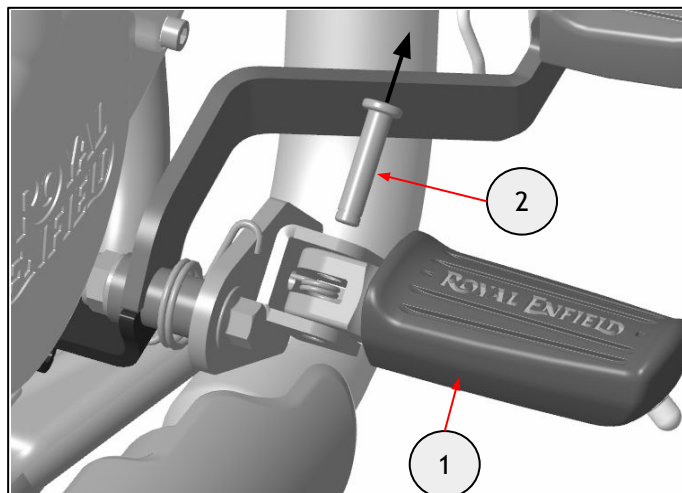

3 Remove the rider footrest (1) and retain the footrest return spring for reuse (2).

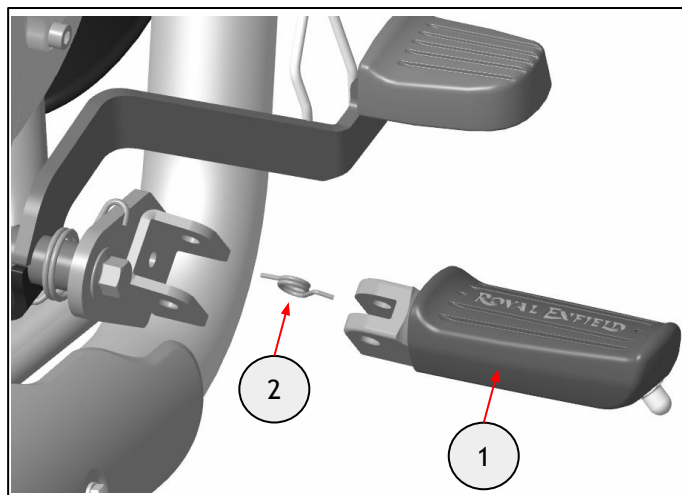

4 Fit the feeler peg (1) from the kit on the deluxe footpeg (2). Tighten the feeler peg (1) to 12 Nm.



14mm socket and torque wrench

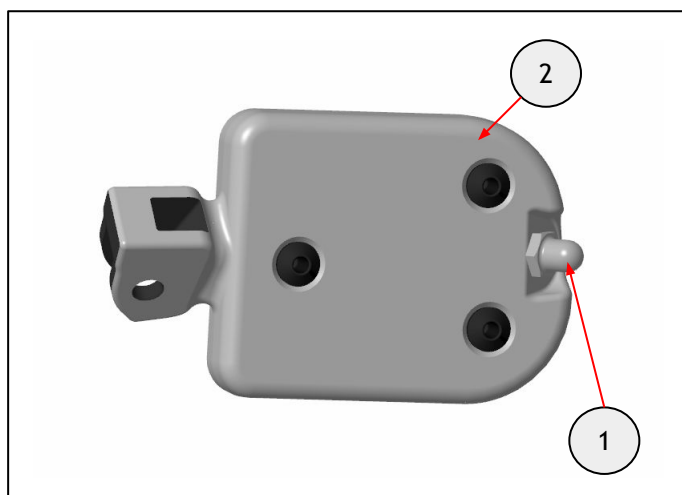

5 Locate the footrest spring (1) in the position shown within the RH deluxe footrest (2)

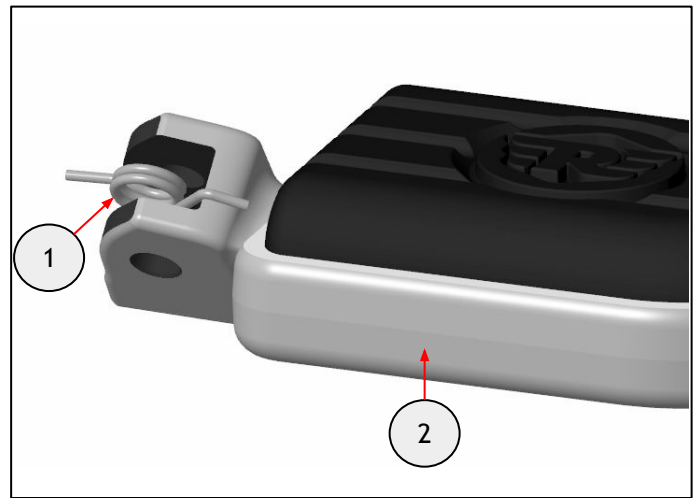

6 Align the deluxe footpeg (1) mounting hole with the clevis (2) hole. Fit the straight end of the return spring (3) in the clevis spring hole. Fit the clevis pin (4) through the clevis, the footpeg and the spring.

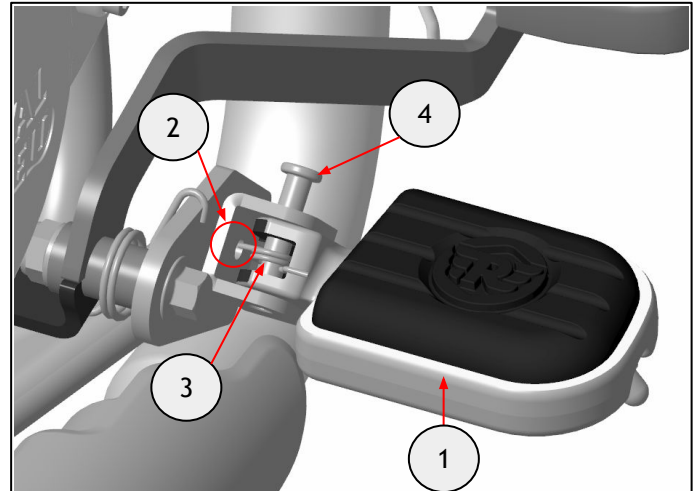

7 Fit the circlip (1) removed in step 1 into the clevis pin (2) groove.

Note: Apply grease on the circlip to avoid rusting.

Repeat steps 1 to 7 on the left side.

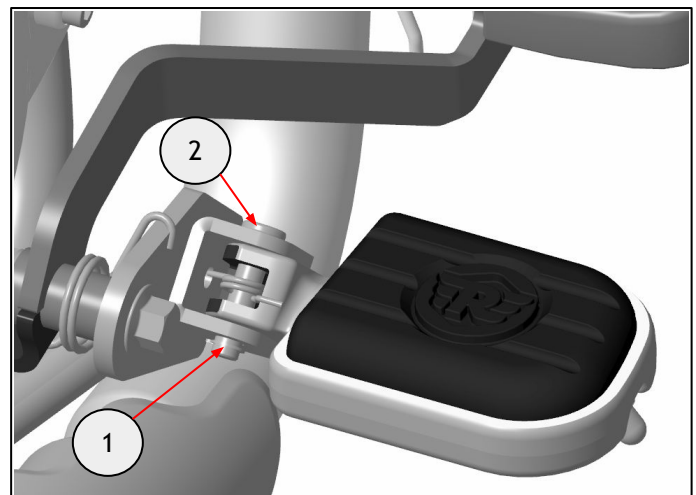

8 When fitting rear footrests for pillion position, the same procedure should be followed as steps 1–7 above, with the following exceptions:

After following step 1–3 for the pillion footrest, the detent ball (1) and spring (2) should be retained for reuse if the motorcycle is to be returned to its original condition.

Exclude step 5, as the return spring is not required for fitment of the accessory footpegs in pillion position.

