

Part Number:
KXA00217

Models:
P4D
With VIN starting **ME3J3A5FAL3**

WARNING: Royal Enfield genuine accessories are designed to fit only the specific Royal Enfield motorcycle(s) that are specified by the model name and VIN number above. They should not be fitted to any other type of motorcycle. Pay particular attention to the warnings and cautions contained in this instruction, failure to do so may result in an incorrect installation of the accessory which could result in an unsafe riding condition and possible accident. If in any doubt always seek help from your authorised Royal Enfield dealer.

WARNING: Before starting any accessory kit installation ensure the motorcycle is supported in a stable condition. Failure to support the motorcycle correctly could lead to motorcycle damage or personal injury.

WARNING: All fixings must be tightened to the torque values specified in this instruction. Failure to tighten fixings to the correct torque could result in an unsafe riding condition and possible accident.

CAUTION: Care should be taken when fitting any accessory kit. Incorrect handling of kit components or the use of incorrect tools could lead to component or motorcycle damage.

NOTE: The content of this instruction is subject to change at any time without notice or liability. Royal Enfield reserves the right to revise the information presented at any time.

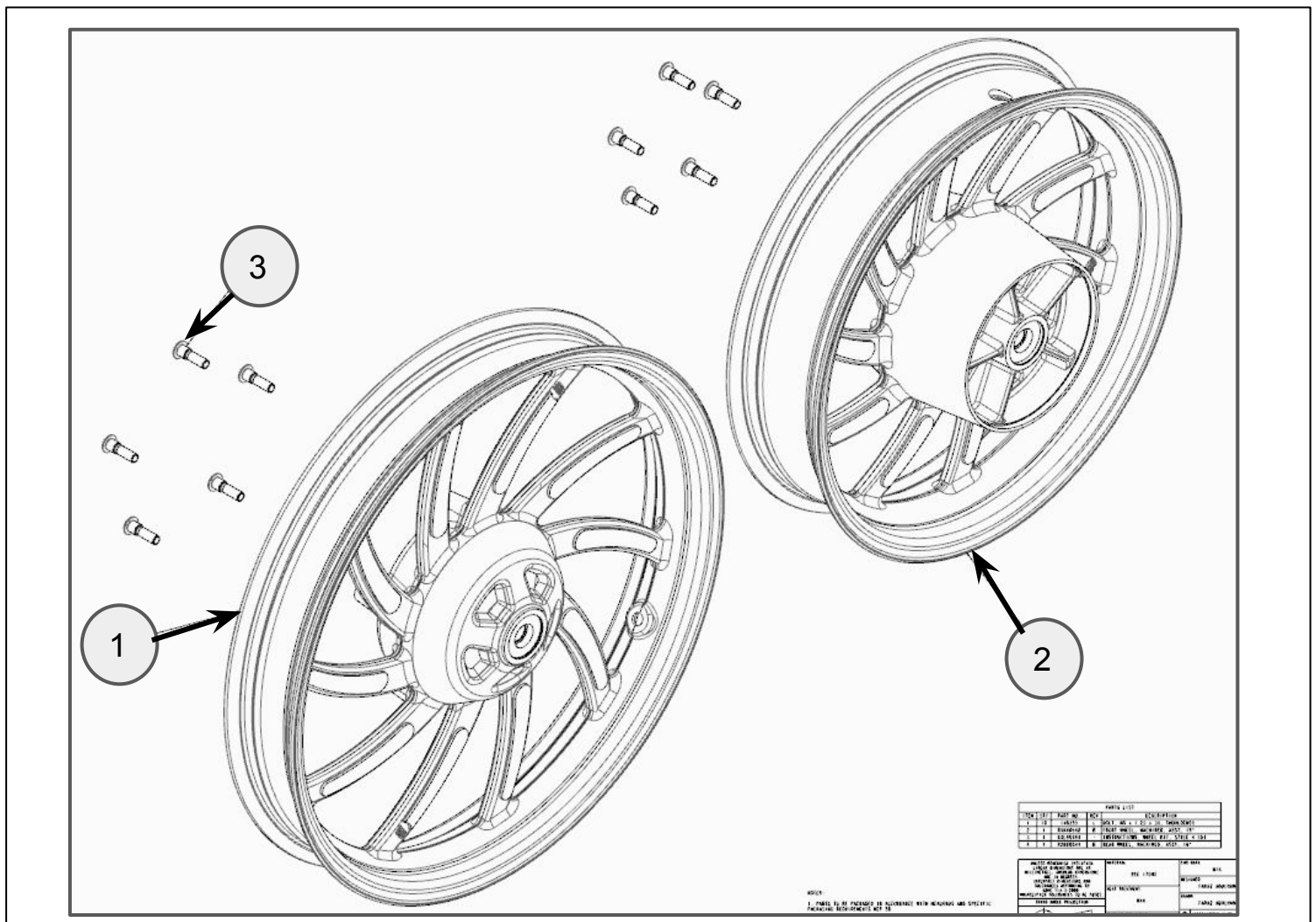

Item	Description	Qty
1	Front wheel Assy	1
2	Rear wheel Assy	1
3	Bolt, M8 x 30	10

1 Loosen the M8 fastener (4) from the LH side bottom of the fork. Then remove the front wheel spindle (5) from the fork and secure it for reuse. Then remove the front wheel assembly from the vehicle.

Note: Work is to be performed on the centre stand, wheel removal should only be carried out by a qualified person using appropriate equipment to avoid aesthetic damage and the risk of injury.

	(4) 8mm Hex bit socket and wrench (5) 14mm Hex bit socket and wrench
--	---

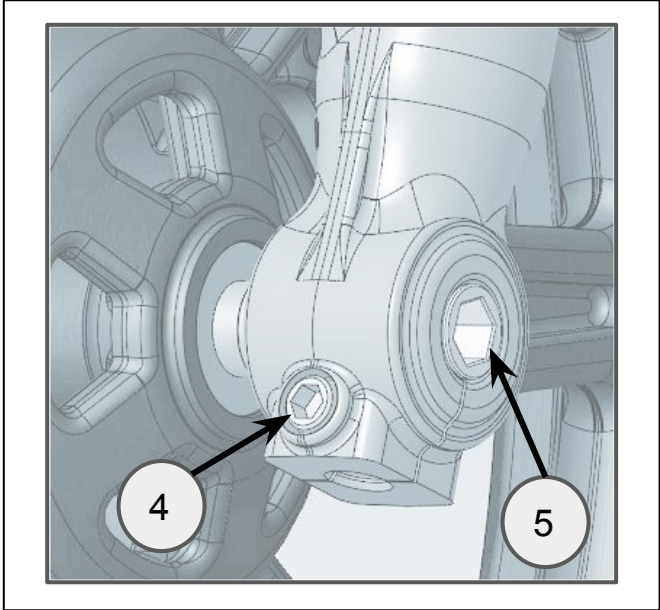

2 Remove the spacer (2 Nos) (6) from the front wheel assembly on both LH and RH sides, secure the spacer for reuse. Then remove the disc (7) and toner ring (8) from the wheel assembly by loosening the M8 fastener (9) (5 Nos) from the wheel assembly. Secure the disc and toner ring for reuse but discard the M8 fastener (9) (5 Nos). Remove the valve (10) and tyre (11) from the wheel assembly, secure the valve and tyre for reuse. Don't place the disc face on the ground to avoid damage.

	(9) 6mm Hex bit socket and wrench
--	-----------------------------------

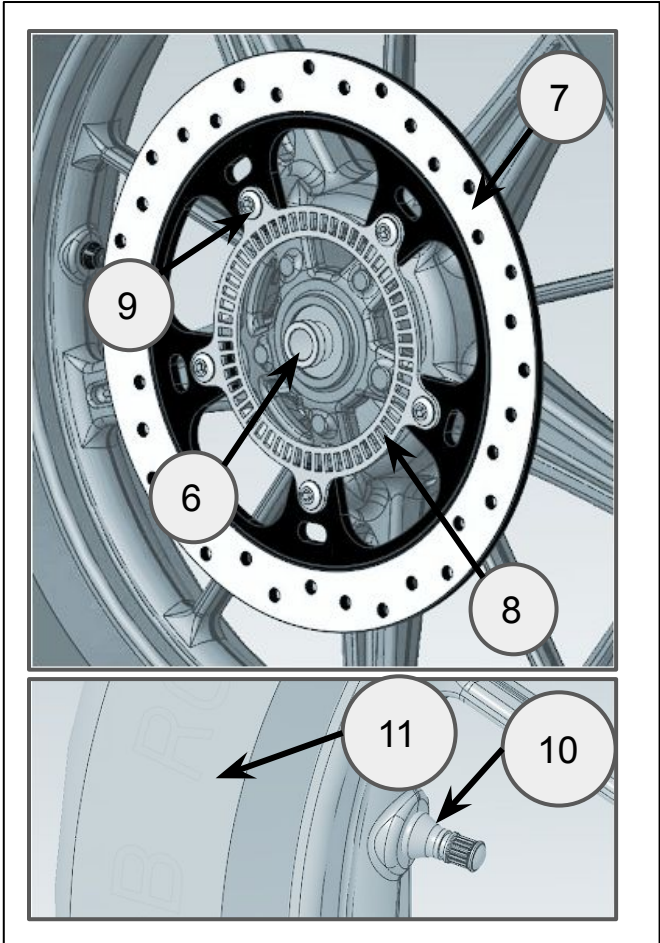

3 Reuse disc (7) and toner ring (8) to assemble on accessories front wheel (1) using M8 fastener (3) 5Nos available on kit, place disc between wheel and toner ring. Torque the fastener (3) 5Nos to **25Nm**. Reuse valve (10) and tyre (11) to assemble on accessories front wheel. Tyre rotation arrow marking should be clockwise direction while disc face is upside. Don't place the disc face on ground to avoid the damage.

Wheel balancing to consider and add the balancing weight (both LH and RH side of wheel) which is recommended by balancing machine on recommended position

	<p>(3) 6mm Hex bit socket and torque wrench</p>
--	---

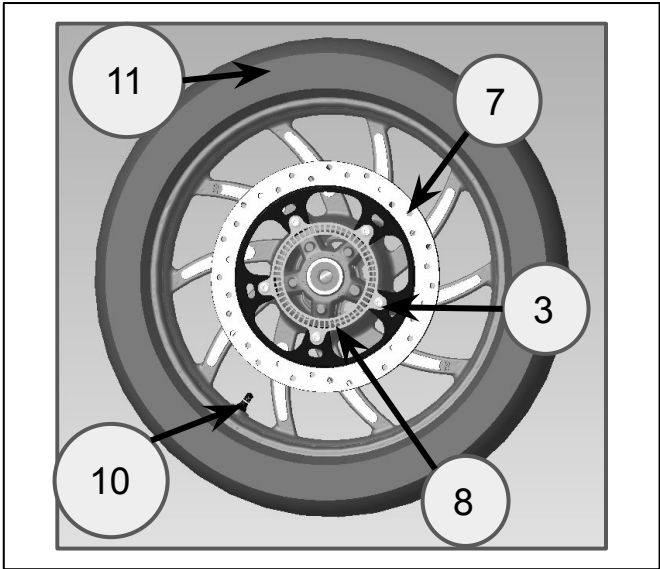

4 Reuse spacer (6) 2Nos to assemble on wheel assembly and position the wheel assembly between front fork. Reuse spindle (5) and insert from LH side fork through the wheel assembly as shown. Torque the spindle (5) to **70Nm**. Reuse M8 fastener (4) to LH side bottom of fork. Torque the fastener (4) to **25Nm**

Note: Ensure free rotation of the front wheel. Ensure front brake operates by applying pressure to front brake lever.

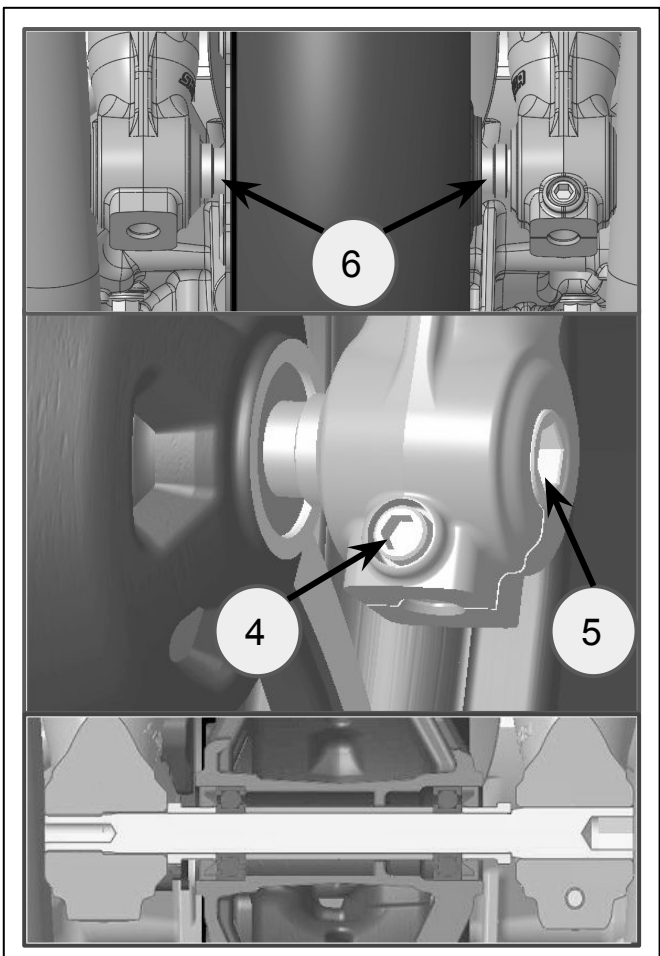

5 Remove silencer assy left and right (12,13) from vehicle to remove rear wheel spindle, then loose the M16 nut (14) and washer (15), remove spindle by pulling in opposite direction. Retain M16 Nut (14), M16 washer (15) and rear wheel spindle (16) to reuse

Note: For silencer remove refer T4200822. work is to be performed on centre stand wheel removal should only be carried out by a qualified person using appropriate equipment to avoid aesthetic damage and the risk of injury.

	<p>(14) 24mm hexagonal socket</p>
--	-----------------------------------

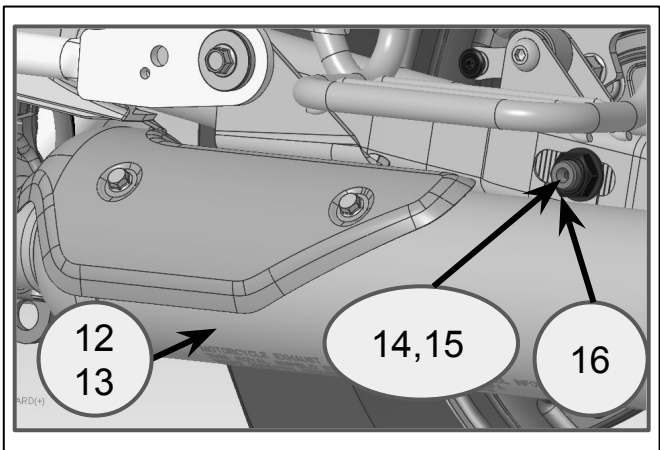

6 Remove chain from chain sprocket, then remove wheel assy from vehicle.
Remove sprocket assy (17) from wheel by pulling out without disturbing any fastener. Then remove cush rubber (18) 5Nos from wheel. Secure sprocket assy (17) and cush rubber (18) to reuse.

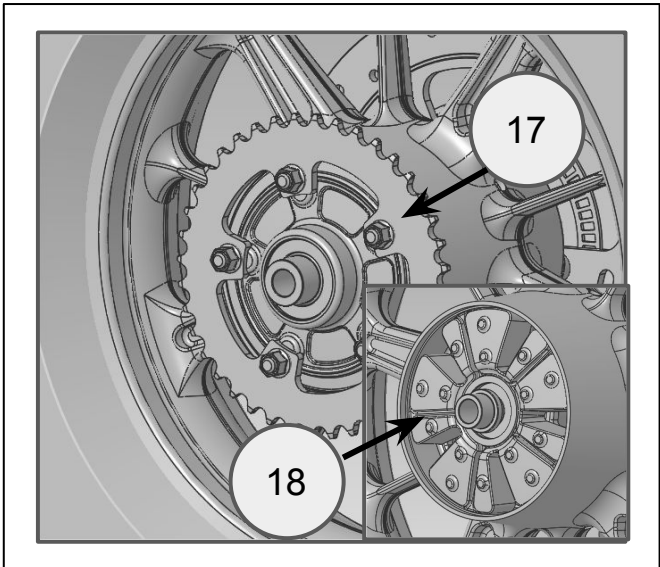

7 Remove RH (19) and LH (20) side spacer, Secure spacer (19) and (20) to reuse.
Then remove disc (21) and toner ring (22) form wheel assy by loosen M8 fastener (23) 5Nos from wheel assy. secure disc and toner ring for reuse but discard M8 fastener (23) 5Nos.
Remove valve (24) and tyre (25) from wheel assy, secure valve and tyre for reuse.
Don't place the disc face on ground to avoid the damage.

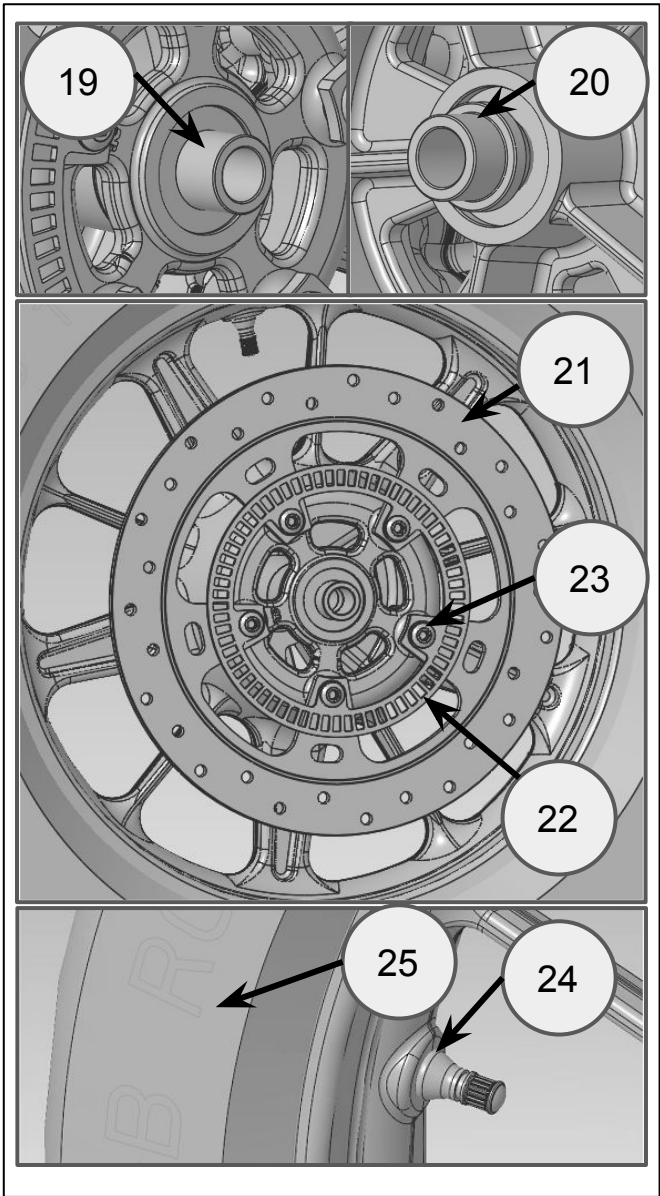

(23) 6mm Hex bit socket and wrench

8 Reuse disc (21) and toner ring (22) to assemble on accessories Rear wheel (2) using M8 fastener (3) 5Nos available on kit, place disc between wheel and toner ring .Torque the fastener (3) 5Nos to **25Nm**.

reuse valve (24) and rear tyre (25) to assemble on accessories rear wheel. Tyre rotation arrow marking should be in clockwise direction while disc face is upside. Don't place the disc face on ground to avoid the damage.

Wheel balancing to consider and add the balancing weight (both LH and RH side of wheel) which is recommended by balancing machine on recommended position.

	<p>(3) 6mm Hex bit socket and wrench</p>
--	--

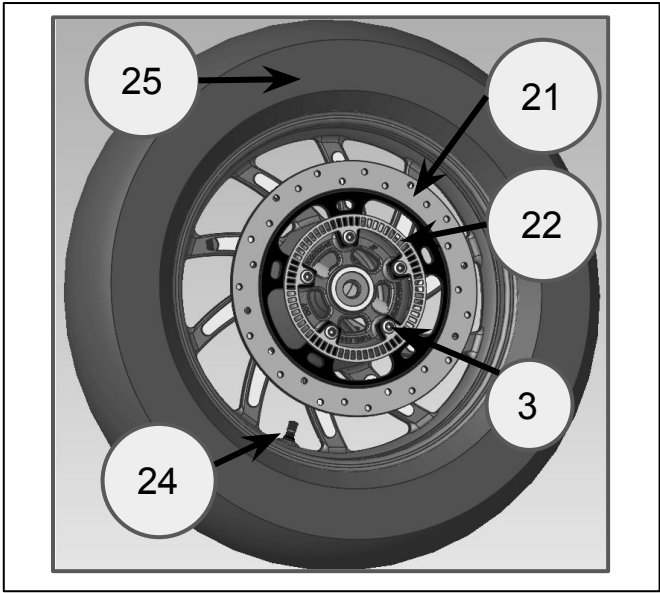

9 Reuse RH (19) and LH (20) side spacer to accessories Rear wheel (2) to assemble as shown on image.

Reuse cush rubber (18) 5No and insure cush rubber (18) assemble as shown on image.

assemble sprocket assy (17) to wheel by push inside the open on cush rubber

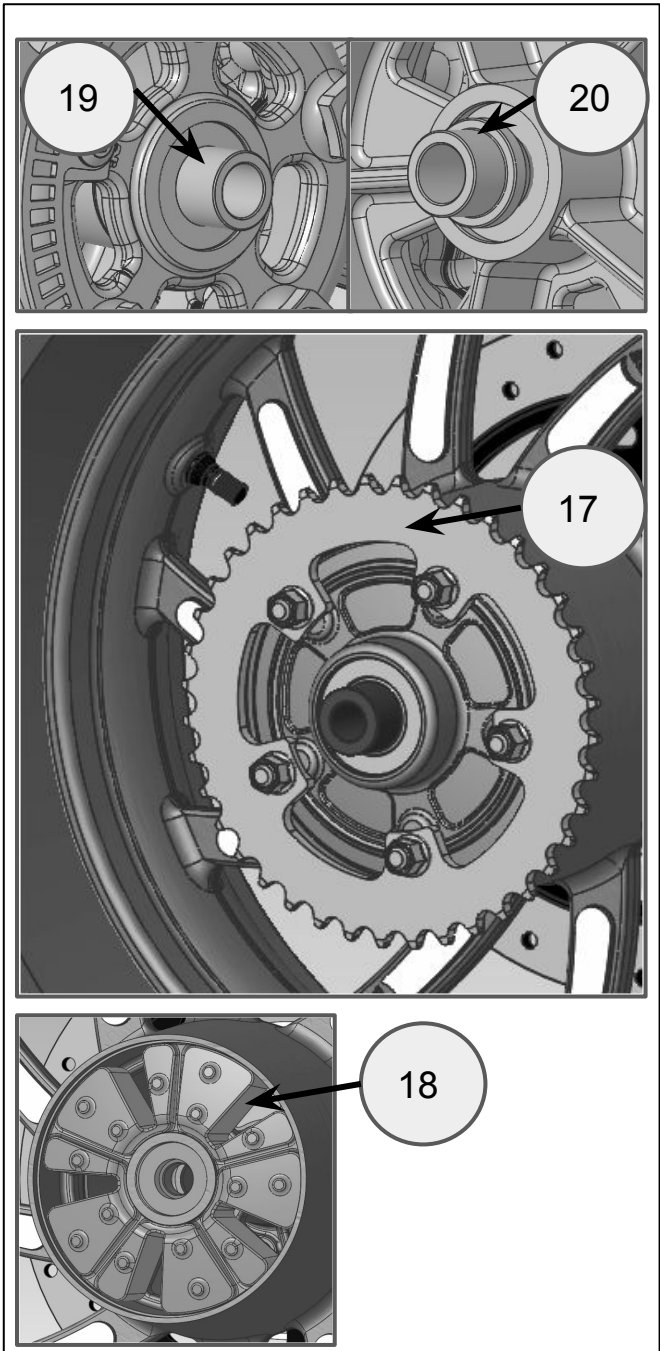

10 Place rear wheel between swing arm and insure brake assembly (26) positioned on right side swing arm. Assemble chain over the sprocket and Insert the rear wheel spindle (16) from right side through swing arm, brake assembly and wheel. Reuse the M16 washer (15) 2Nos both side of spindle and reuse M16 nut (14) left side of spindle Torque the M16 nut (14) to **70Nm**.

Note: Ensure free rotation of the rear wheel and chain slack to check as per vehicle user manual. Ensure the rear brake operates by applying pressure to the rear brake lever.

	<p>(14) 24mm hexagonal socket and torque wrench</p>
--	---

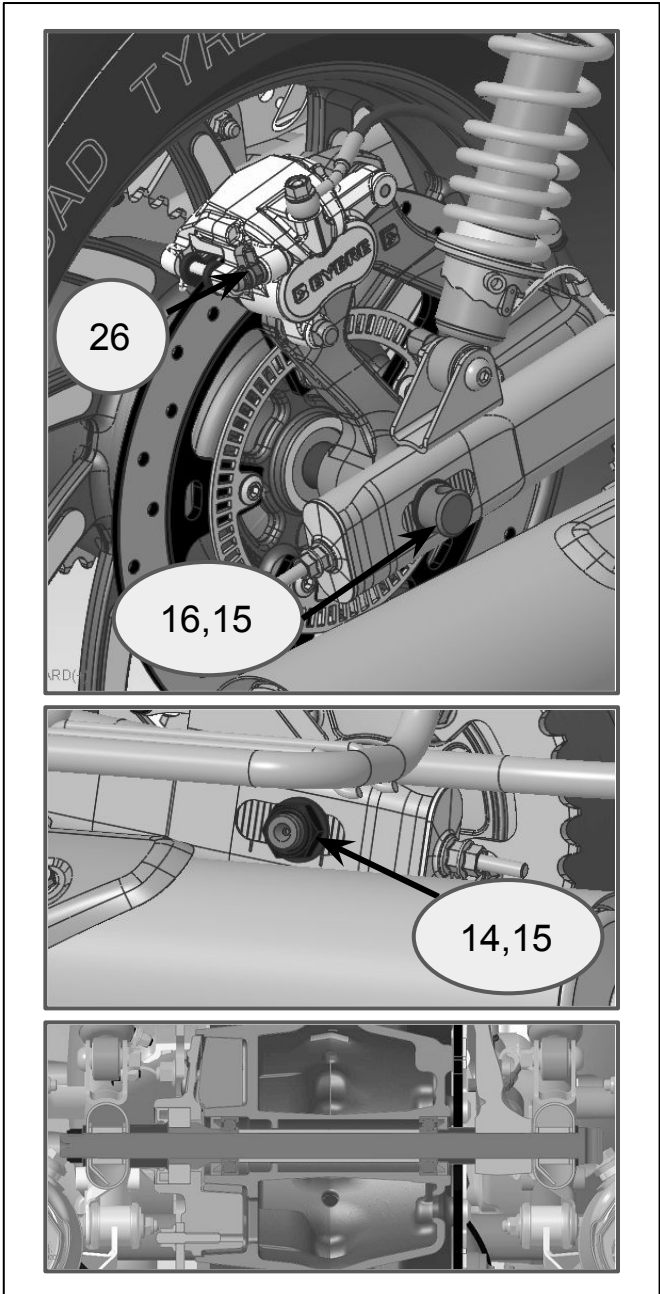

11 Reassemble the silencer assy left and right (12,13) to the vehicle.

Note: For silencer reassemble refer T4200822.

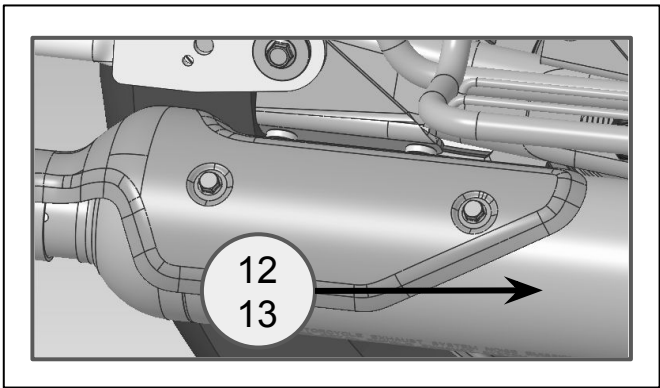

WARNING: After fitting any genuine Royal Enfield accessory always ride the motorcycle with caution and allow time to become familiar with any change in the motorcycle handling characteristics. Failure to become familiar with any change in the motorcycle handling characteristics may cause the motorcycle to become unstable and result in an accident.