





Part Number:
1990261

Models:
Himalayan, Scram 411

-  **WARNING:** Royal Enfield genuine accessories are designed to fit only the specific Royal Enfield motorcycle(s) that are specified above. They should not be fitted to any other type of motorcycle. Pay particular attention to the warnings and cautions contained in this instruction, failure to do so may result in an incorrect installation of the accessory which could result in an unsafe riding condition and possible accident. If in any doubt always seek help from your authorised Royal Enfield dealer.
-  **WARNING:** Before starting any accessory kit installation ensure the motorcycle is supported in a stable condition. Failure to support the motorcycle correctly could lead to motorcycle damage or personal injury.
-  **WARNING:** All fixings must be tightened to the torque values specified in this instruction. Failure to tighten fixings to the correct torque could result in an unsafe riding condition and possible accident
-  **CAUTION:** Care should be taken when fitting any accessory kit. Incorrect handling of kit components or the use of incorrect tools could lead to component or motorcycle damage.

NOTE: The content of this instruction is subject to change at any time without notice or liability. Royal Enfield reserves the right to revise the information presented at any time.

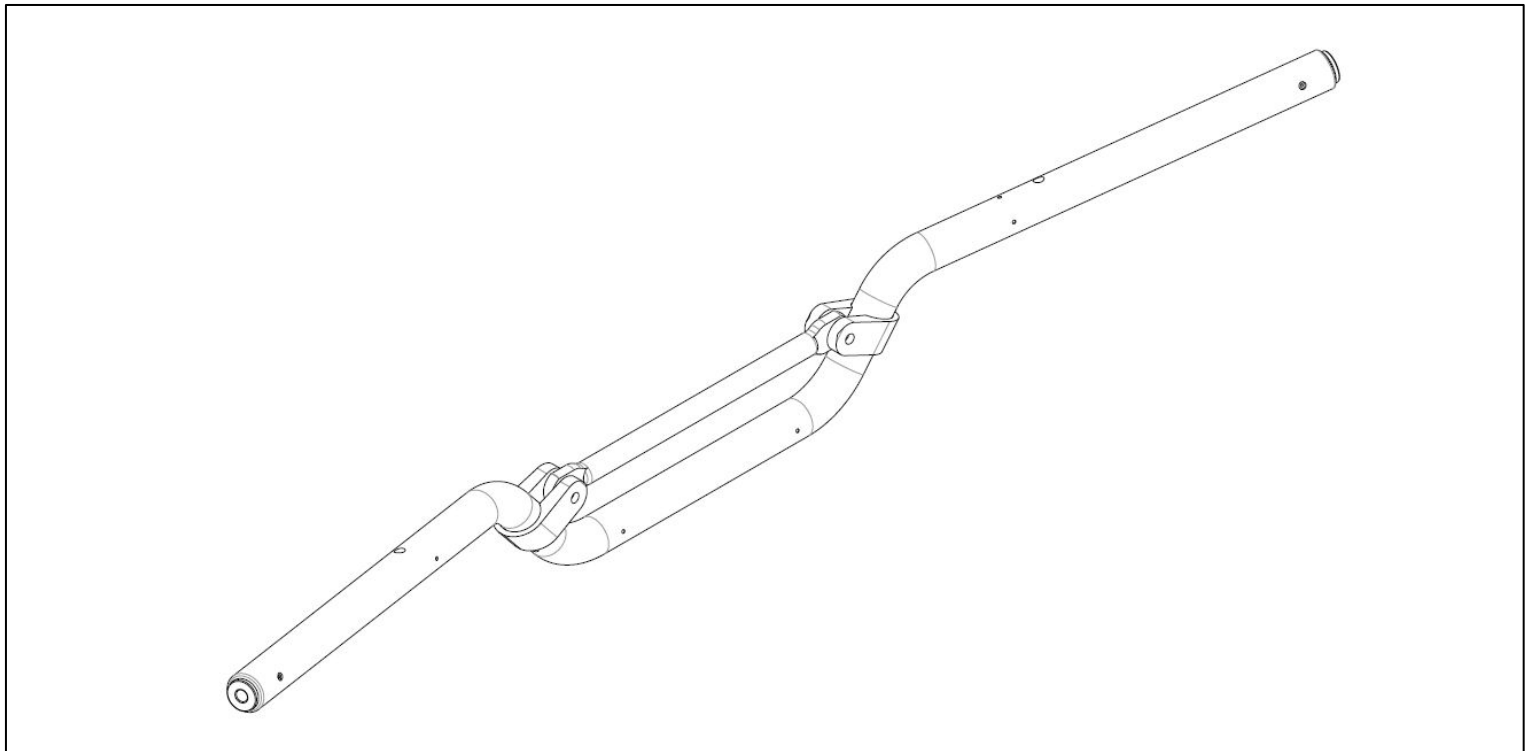

Item	Description	Qty
1	Adventure Handlebar	1

1 Disconnect the battery negative lead first as described in the Owner's Manual, Remove Left Hand Mirror (1) & Right Hand Mirror (2) from the Handlebar and Retain the Items for reuse with GMA Handlebar.

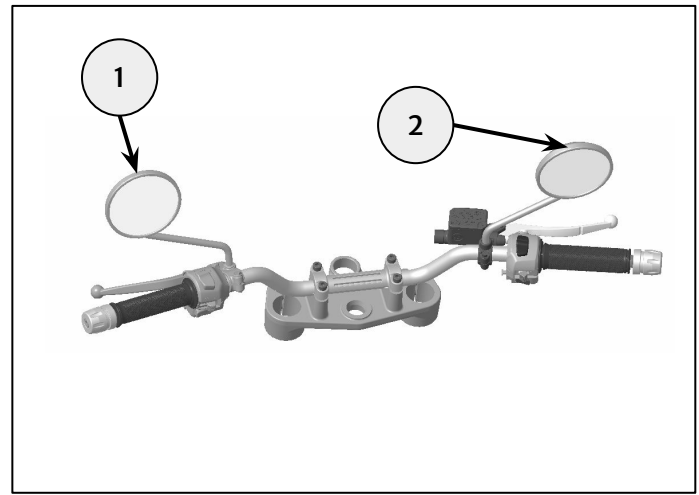

2 Remove the bar end weights (1) from the handlebars, left hand side shown. Retain the bar end weights (1) and fixings (2) for reuse if the original handlebars are to be refitted.



6mm hexagonal bit with ratchet/6mm Allen Key

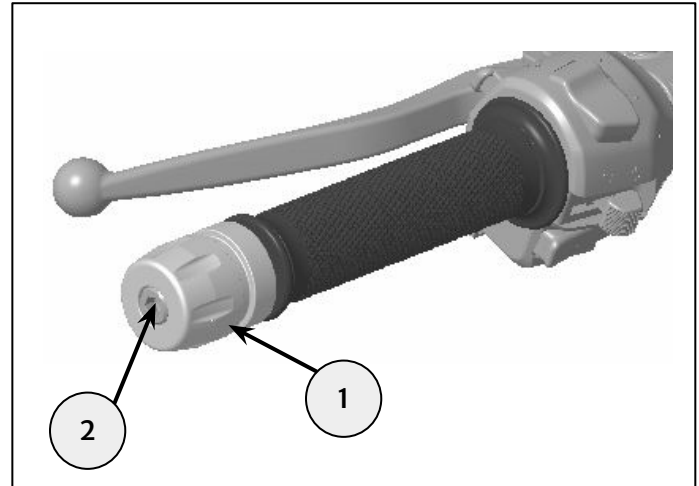

3 Detach the left hand side and right hand side harness clips (1) from the underside of the handlebars, left hand side shown. Do not remove the clips from the harnesses.

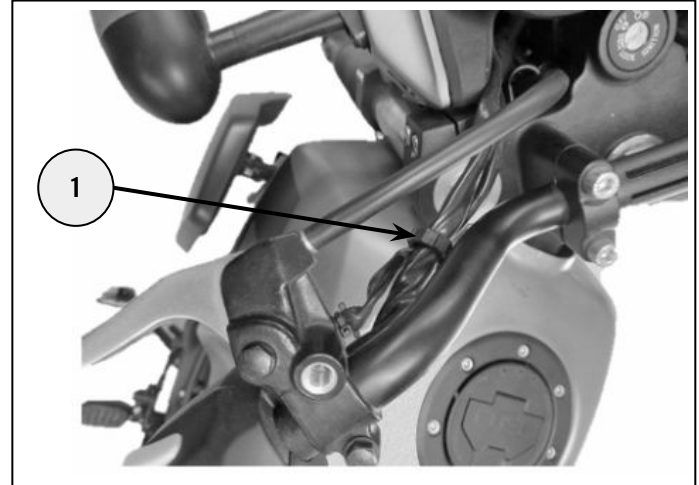

4 Force Slide Left Hand Grip (1) from its place and retain the item for reuse with GMA Handlebar.



CAUTION: Do not damage the grip when removing from the handlebars. If the grip is damaged when removing it must be replaced with a new Genuine Royal Enfield handlebar grip (Part Number: 587317) from your local authorised Royal Enfield dealer.

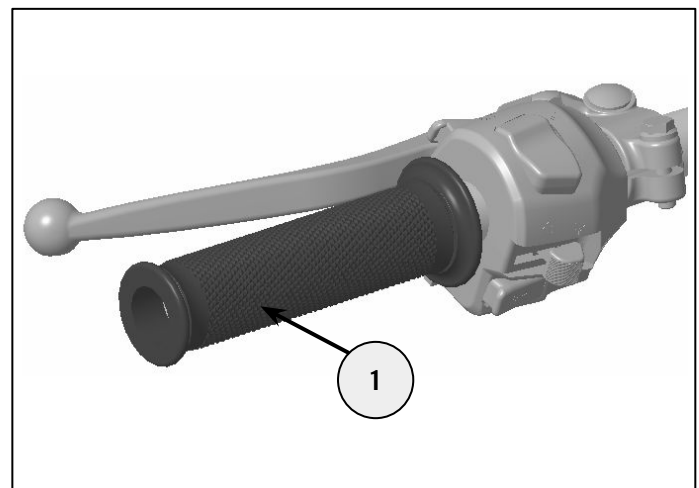

5 Remove the Fixing, 2x Phillips Screws (1) to remove the Left Hand Switch Cube (2) from its place. Retain the Items and fixings for reuse with GMA Handlebar



Phillips Screwdriver / PH1 phillips bit and ratchet.

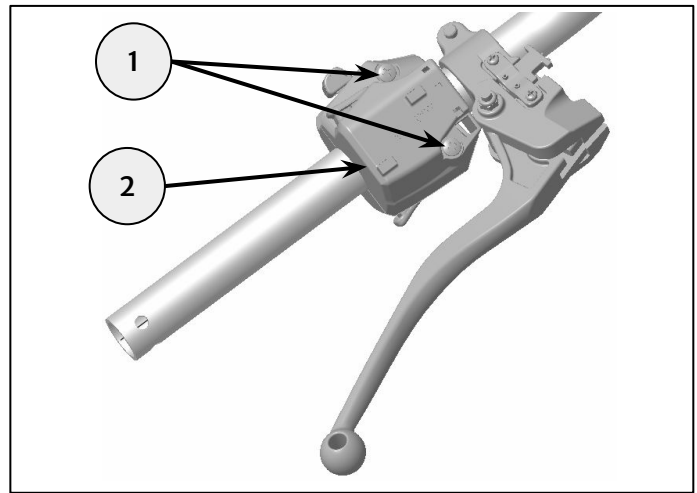

6 Remove Clutch Lever (1) by removing M6x25 Fixing (2), Retain the Items and fixings for reuse with GMA Handlebar.



10mm socket and ratchet

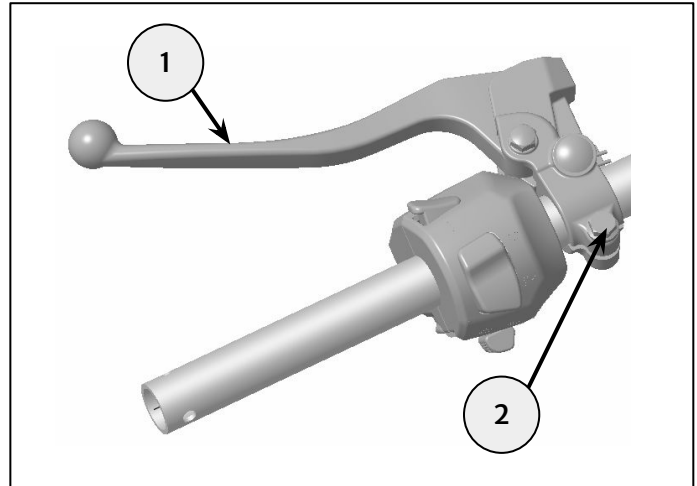

CAUTION: Do not remove Clutch Cable from the Clutch Lever and Support the Clutch Lever properly as it may freely oscillate around the handlebar

7 Remove Top cover of Right Hand Switch Cube (1) by removing the Fixing, 2x Phillips Screws (2) as shown in the image and Loosen the Throttle Cable from the Throttle Tube (3), Now remove the bottom cover of the Right Hand Switch Cube (1) and retain the Items and fixings for reuse with GMA Handlebar.



CAUTION: Do not remove Throttle Cable from the Switch Cube and support the Right Hand Switch Cube properly as it may freely oscillate around the bike



Phillips Screwdriver / PH1 phillips bit and ratchet.

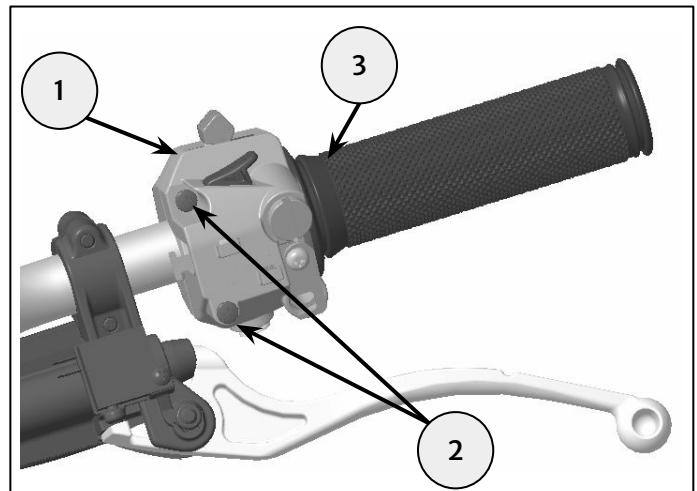

8 Slide out Right Hand Grip (1) from its place and Retain the Item for reuse with GMA Handlebar.

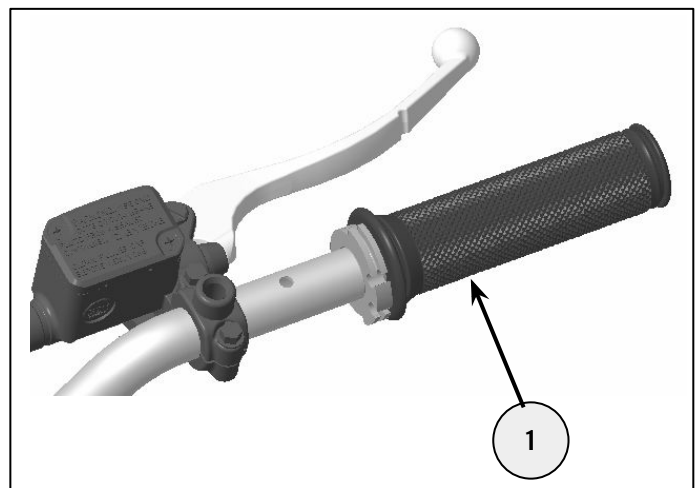

9 Remove the ABS Master Cylinder (1) by removing the M6X25 fixing (2). Retain the Items and fixings for reuse with GMA Handlebar.



CAUTION: Do not remove ABS Hose from the Master Cylinder and support the ABS Master Cylinder properly as it may freely oscillate around the bike



8mm socket and ratchet

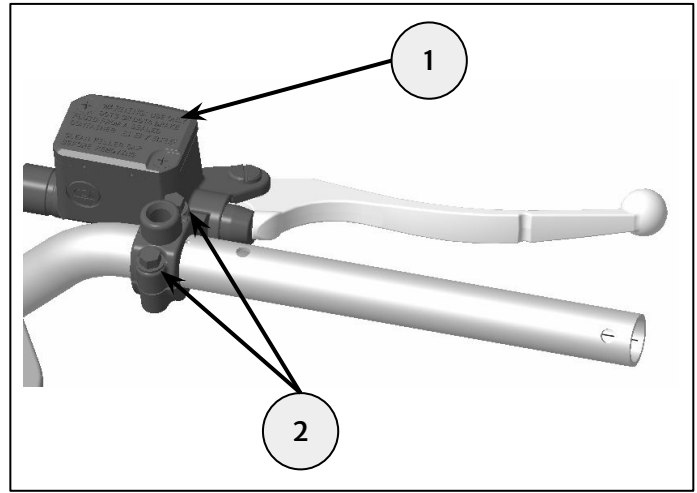

10 Remove OE Handlebar Clamp (1) by removing 4x M8x40 Fixing (2). Retain the items and fixings reuse with GMA Handlebar. Remove OE Handlebar (3) from its place and Slide out Clutch Lever from the Handlebar. Retain the OE Handlebar for reuse if the motorcycle is to be returned to its original condition



CAUTION: Before loosening the handlebar clamp bolts, ensure adequate protection has been applied to the fuel tank as handlebar will freely rotate.



6mm Hex socket with ratchet

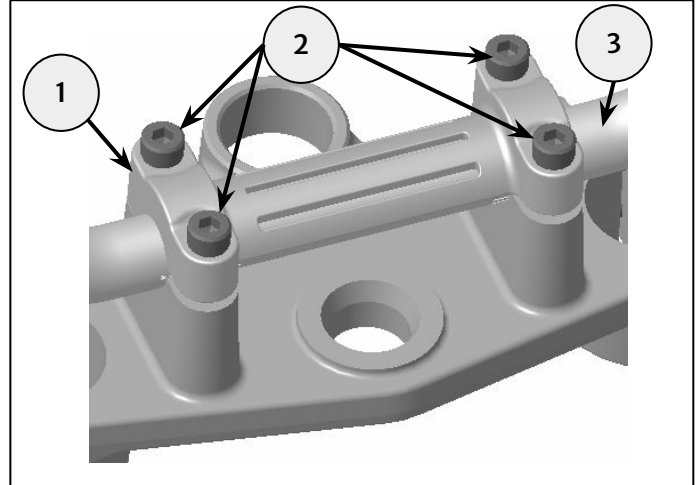

11 Slide the Clutch Lever (1) into the GMA Handlebar (2) and do not tighten the fixings at this stage and place the whole GMA Touring Handlebar assembly (2) and assemble OE Handlebar Clamp (3) with 4x M8x40 Fixings (4) do not tighten the fixings at this stage.



CAUTION: Ensure adequate Handlebar Brace Clamp and Clutch Lever is properly supported



6mm Hex socket with ratchet

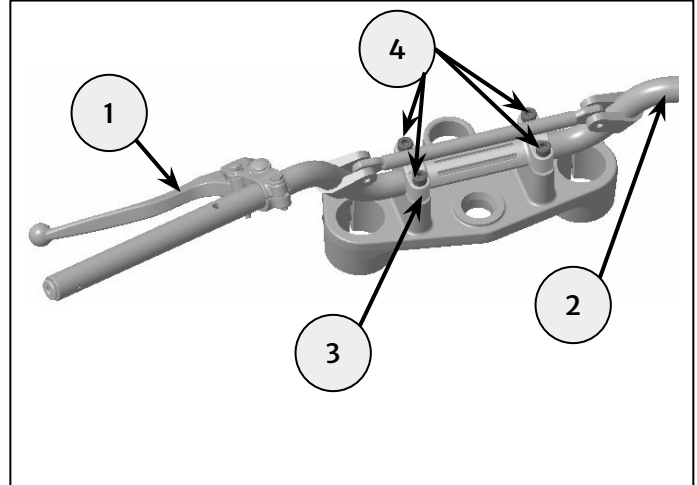

12 Align the GMA Handlebar (1) to the top yoke (2) as shown in the image. Punch mark (Highlighted in Black (5)) in the Handlebar (1) can be used as a guide to position the Handlebar (1) to the top yoke (2). Tighten the 4x M8x40 Fixings (OE Clamp) (3) to 23 - 25 Nm where shown front two fixings are tightened first to the OE Handlebar Clamp (4) followed by the rear fixings.



6mm Hex socket with Torque Wrench

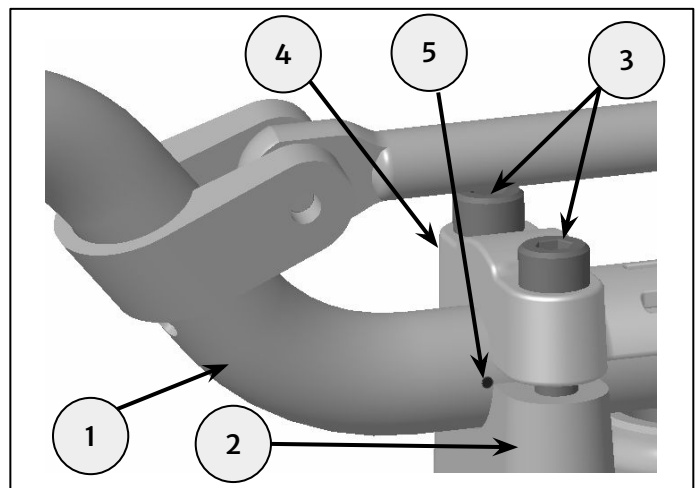

13 Position the Clutch Lever Assy (1) in to the GMA Handlebar (2) using the Punch mark (Highlighted in Black) in the Handlebar and Tighten with M6x25 Fixing (3) as shown with a Torque of 10-12 Nm



10mm Hex socket with Torque Wrench

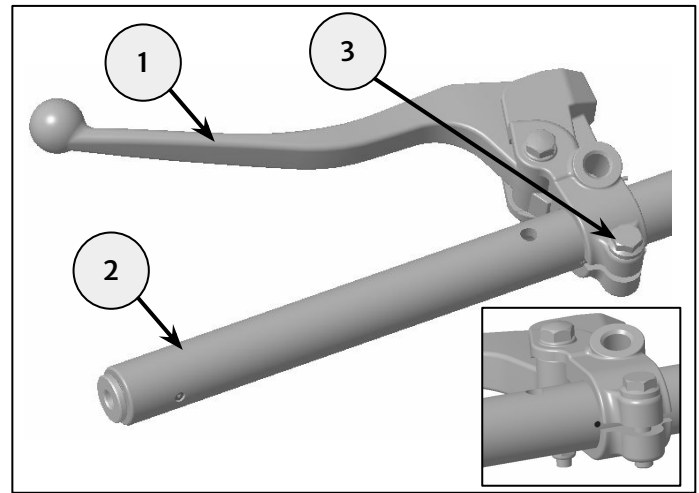

14 Assemble the Left Hand Switch Cube (2) into the GMA Handlebar (1) and make sure the Left Hand Switch Cube is properly seated in its locating Hole and Tighten the Left Hand Switch Cube using Fixings, Phillips Screws (2) to 1.5 to 2 Nm Max.



PH1 Phillips bit and torque wrench.

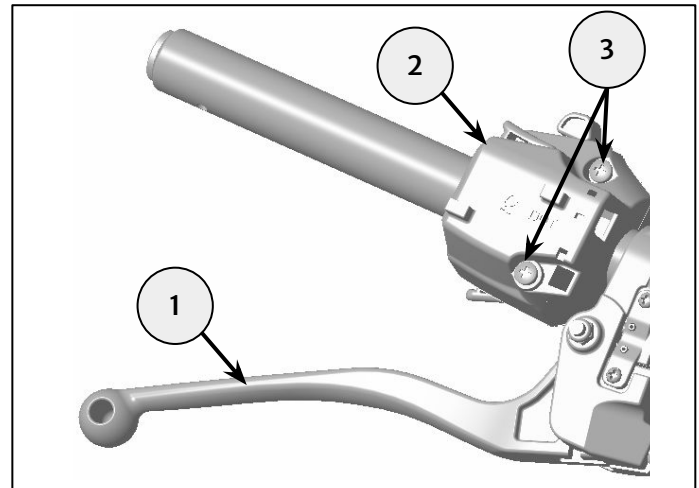

15 Slide in the Left Hand Grip (2) over the GMA Handlebar (1) and make sure the Grip (2) contacts the Left Hand Switch Cube (3).



WARNING: It's advised to purchase a new Left Hand Handgrip (Part Number: 587317) from Royal Enfield Spares as removing the bonded grip can cause damage to the handlebar and make the grip unusable.

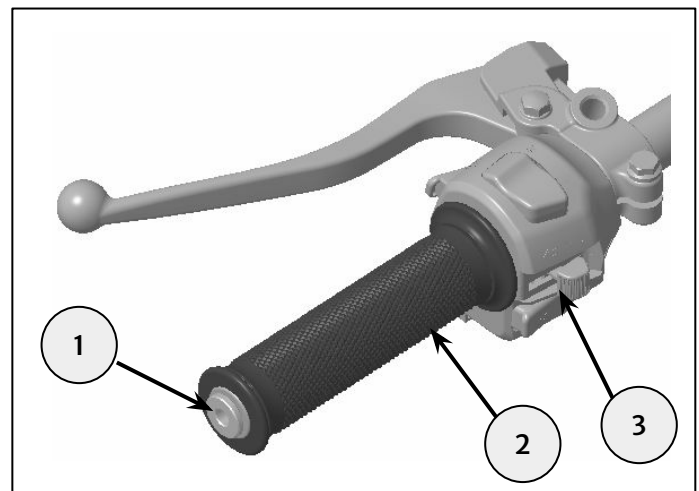

16 Assemble the ABS Master Cylinder (1) and use the Punch mark (4) for the IN Models, Use the punch mark (5) for the EU models to locate the Master Cylinder (1) location in the GMA Handlebar (2) and tighten the Master cylinder with 2X M6x25 fixings (3) at 10-12 Nm Torque.



8mm Hex socket with Torque Wrench

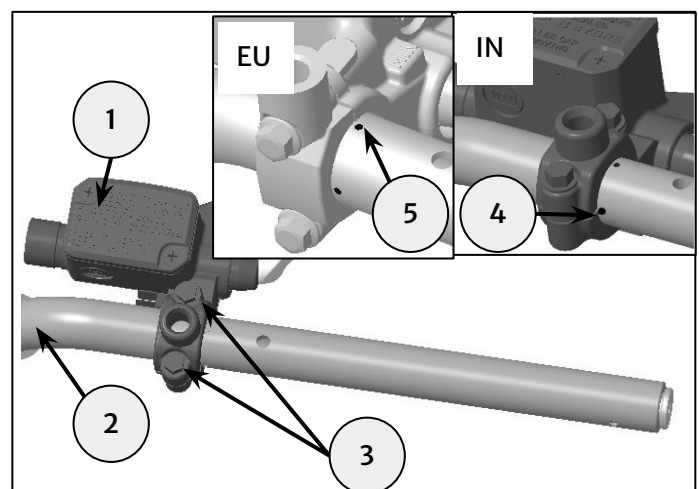

17 Assemble Throttle Tube (3) to the GMA Handlebar (1) and place bottom half of the Right Hand Switch Cube (2) and attach the Throttle cable (not shown here) to the Throttle Tube (3).



WARNING: Ensure proper Throttling after connecting the Throttle Cable to the Throttle Tube

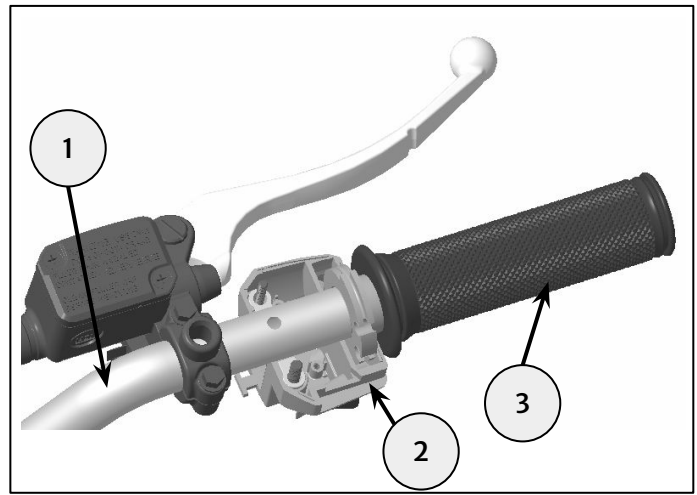

18 Place Top half of the Right Hand Switch Cube (1) make sure the switch cube is properly seated in its locating Hole and tighten the Switch Cube using the Fixings, Phillips Screws (2) to 1.5 to 2 Nm Max.



PH1 Phillips bit and torque wrench.

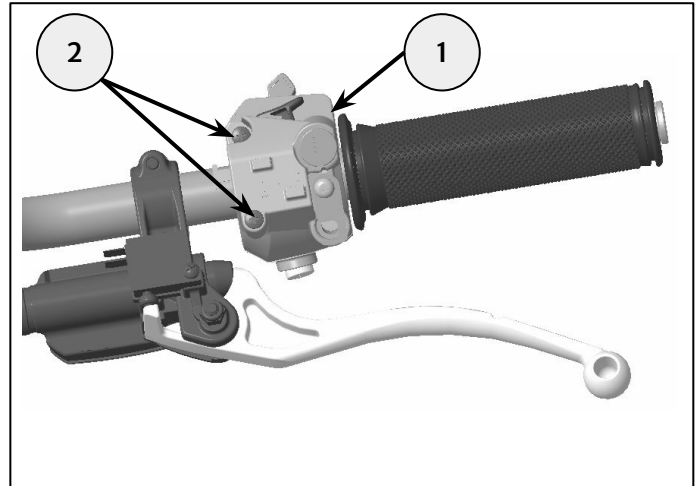

19 Place the Left Hand & Right Hand Bar End Weight (1) and tighten it with the 2X M8x50 Fixing (2) to a torque of 10-12 Nm.



6mm hexagonal bit with ratchet/6mm Allen Key

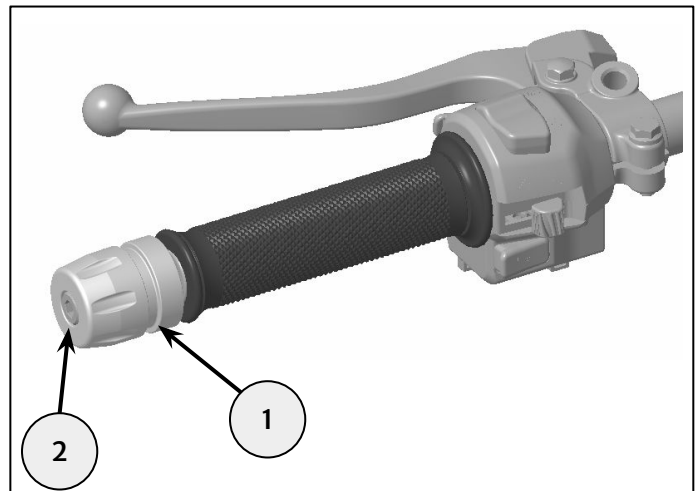

20 Refit the Left Hand OE Mirror (1) & Right Hand OE Mirrors (2) as per the Owner's Manual.

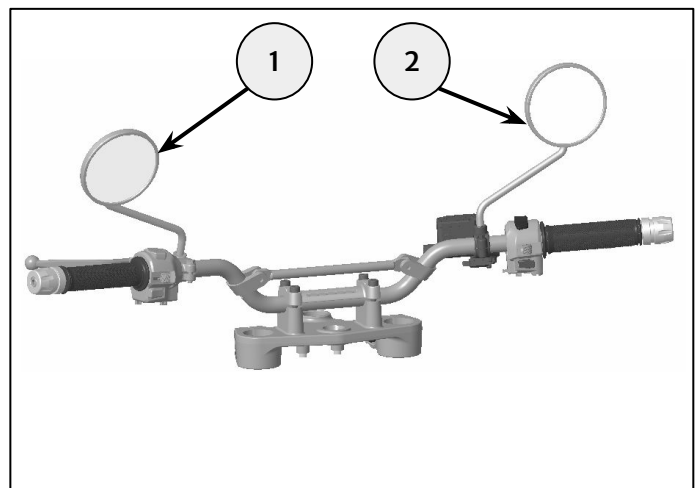

21 Fit the left hand side and right hand side harness clips (1) into the holes on the underside of the handlebars, right hand side shown.

22 Reconnect the battery, positive lead first.

23 Check the operation of both the left hand and right hand switch cube functions.

24 Check that the twist grip rotates smoothly through its full range of movement and is not restricted in any way. If any tightness or resistance is felt, check and rectify the cause before riding the motorcycle.

25 Ensure Clutch Lever free play. This should be adjusted by a genuine Royal Enfield dealer as per standard T0516.



WARNING: Clutch Lever free play adjustment is mandatory



WARNING: Ensure proper Brake Functioning after GMA Handlebar fitment

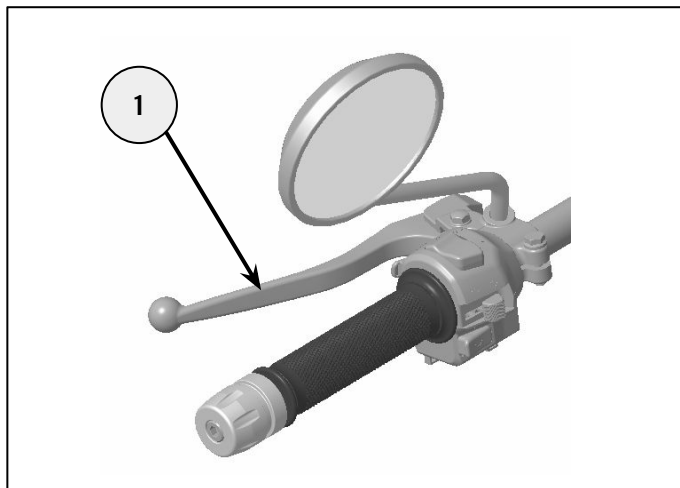
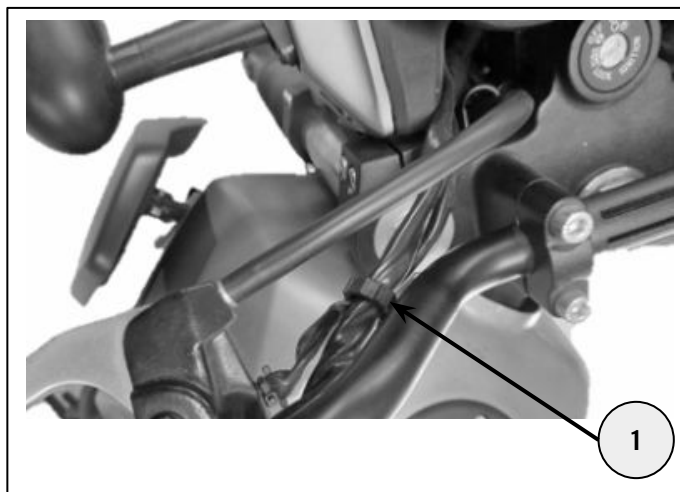

WARNING: After fitting any genuine Royal Enfield accessory always ride the motorcycle with caution and allow time to become familiar with any change in the motorcycle handling characteristics. Failure to become familiar with any change in the motorcycle handling characteristics may cause the motorcycle to become unstable and result in an accident.