

**Part Number:**

1990206

**Models:**

Himalayan

**WARNING:** Royal Enfield genuine accessories are designed to fit only the specific Royal Enfield motorcycle(s) that are specified above. They should not be fitted to any other type of motorcycle. Pay particular attention to the warnings and cautions contained in this instruction, failure to do so may result in an incorrect installation of the accessory which could result in an unsafe riding condition and possible accident. If in any doubt always seek the help from your authorised Royal Enfield dealer.

**WARNING:** Before starting any accessory kit installation ensure the motorcycle is supported in a stable condition. Failure to support the motorcycle correctly could lead to motorcycle damage or personal injury.

**WARNING:** All fixings must be tightened to the torque values specified in this instruction. Failure to tighten fixings to the correct torque could result in an unsafe riding condition and possible accident.

**CAUTION:** Care should be taken when fitting any accessory kit. Incorrect handling kit components or the use of incorrect tools could lead to component or motorcycle damage.

**NOTE:** The content of this instruction is subject to change at any time without notice or liability. Royal Enfield reserves the right to revise the information presented at any time.

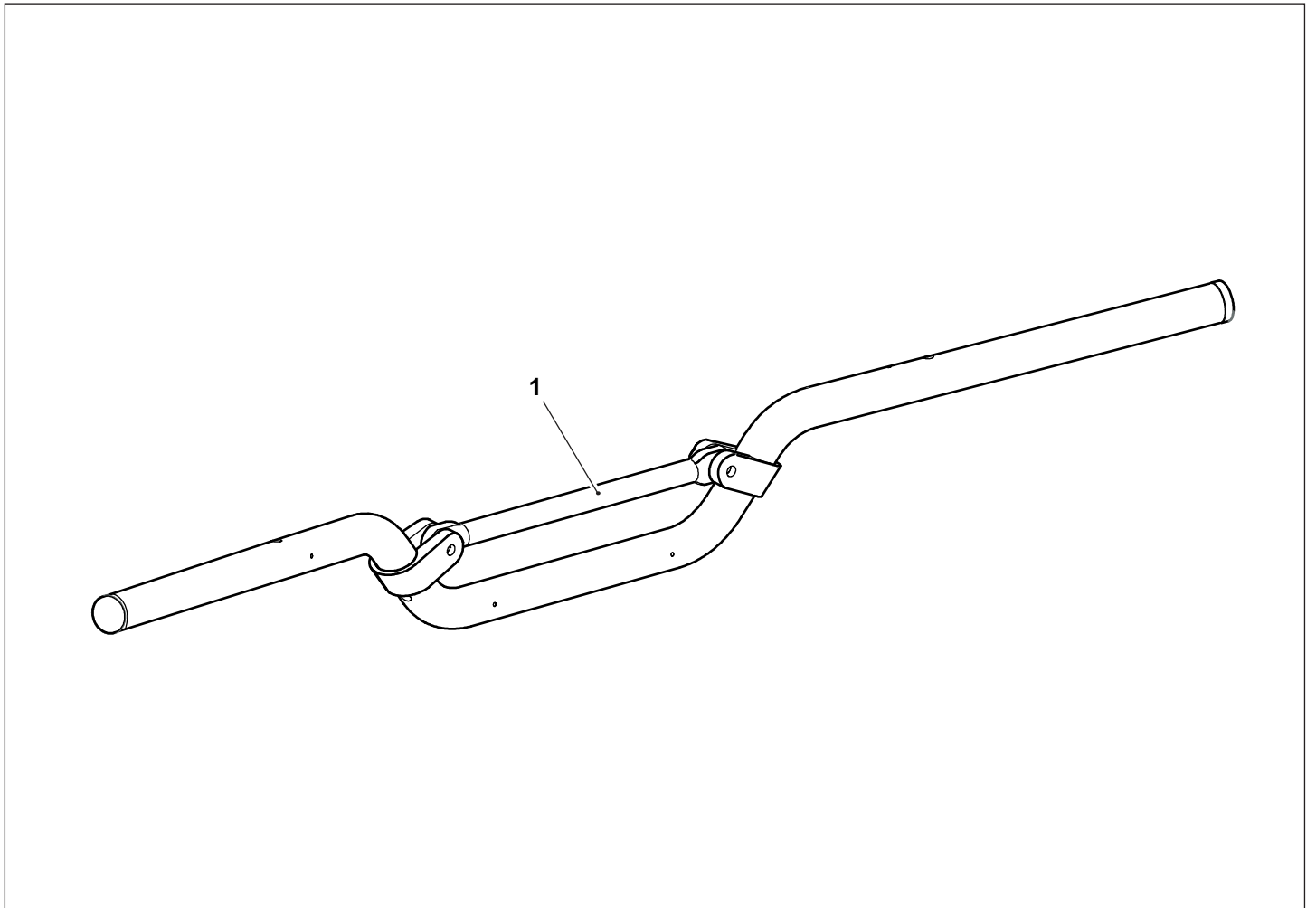

Item	Description	Qty
1	Handlebar	1

**1** Disconnect the battery, negative lead first.

**2** Remove the bar end weights (1) from the handlebars, left hand side shown. Retain the bar end weights (1) and fixings (2) for reuse if the original handlebars are to be refitted.

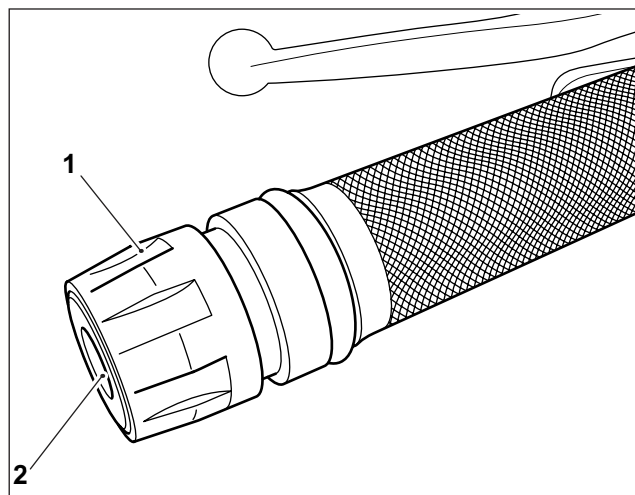

**3** Detach the left hand side and right hand side harness clips (1) from the underside of the handlebars, left hand side shown. Do not remove the clips from the harnesses.

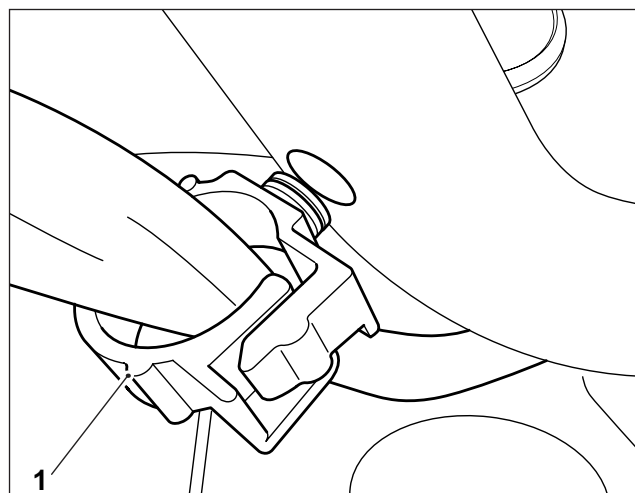

**4** Remove the left hand handlebar grip (1). Retain the grip for reuse.

**CAUTION:** Do not damage the grip when removing from the handlebars. If the grip is damaged when removing it must be replaced with a new Genuine Royal Enfield handlebar grip from your local authorised Royal Enfield dealer.

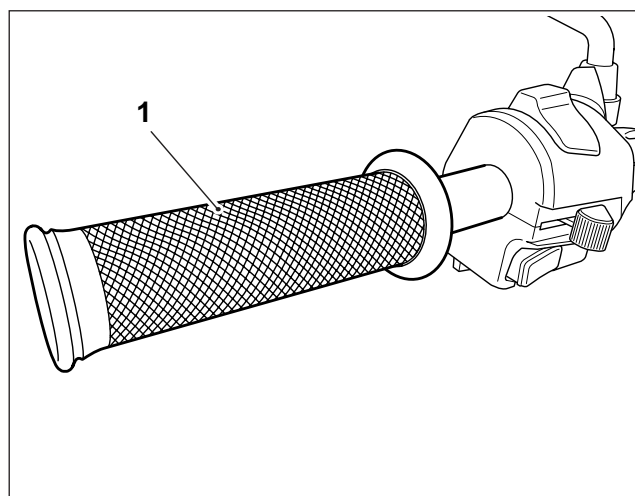

**5** Remove the right hand switch cube fixings (1). Retain the fixings for reuse.

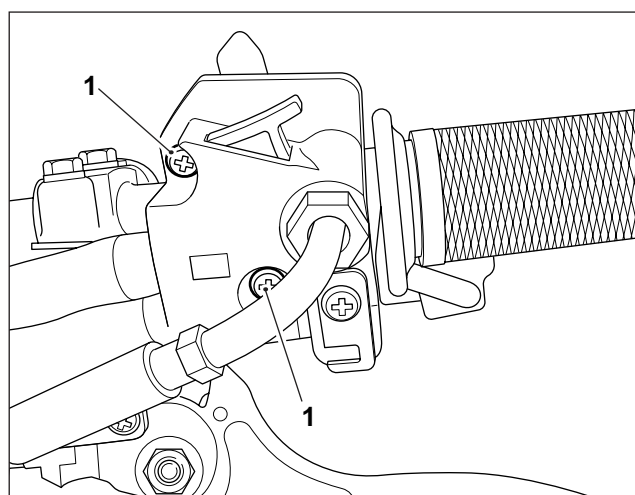

**6** Disconnect the throttle cable (1) from the twist grip (2) and remove the switch cube (3) from the handlebars. Ensure the switch cube is supported. Remove the twist grip (2) from the handlebars. Retain the twist grip for reuse.

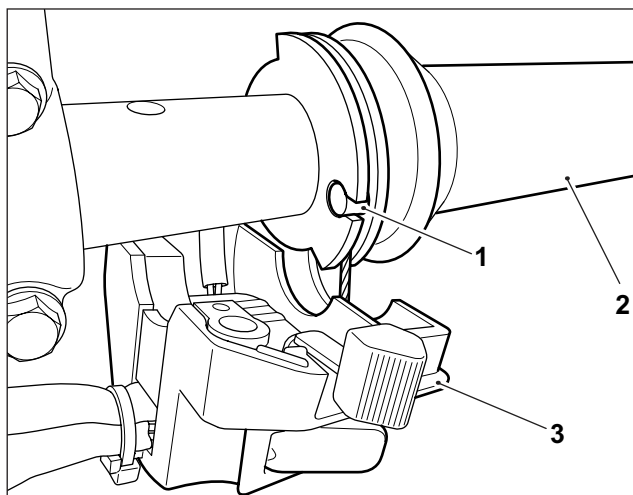

**7** Remove the brake lever and master cylinder clamp fixings (1). Retain the clamp (2) and fixings (1) for reuse. Ensure the brake lever and master cylinder assembly (3) are supported with the brake fluid reservoir (4) upright at all times.

**CAUTION:** Do not allow the master cylinder and fluid reservoir to become inverted, they must be supported in an upright position. If the master cylinder and fluid reservoir are inverted it may result in brake fluid loss. Brake fluid is corrosive and will damage any paintwork it contacts.

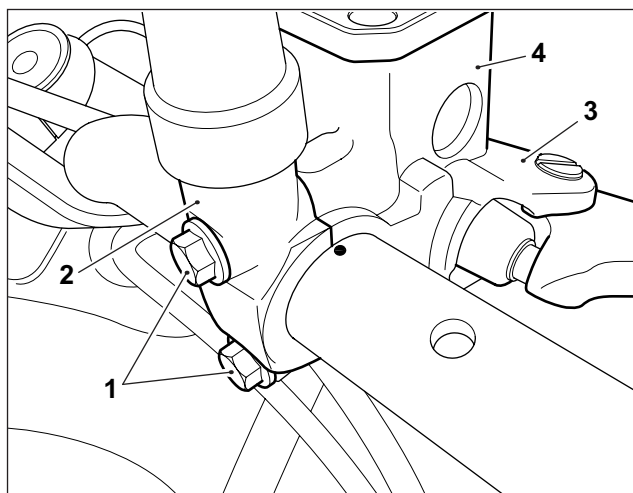

**8** Remove the left hand switch cube fixings. The front fixing (1) also secures the retaining plate (2) as shown. Retain the switch cube fixings and retaining plate for reuse.

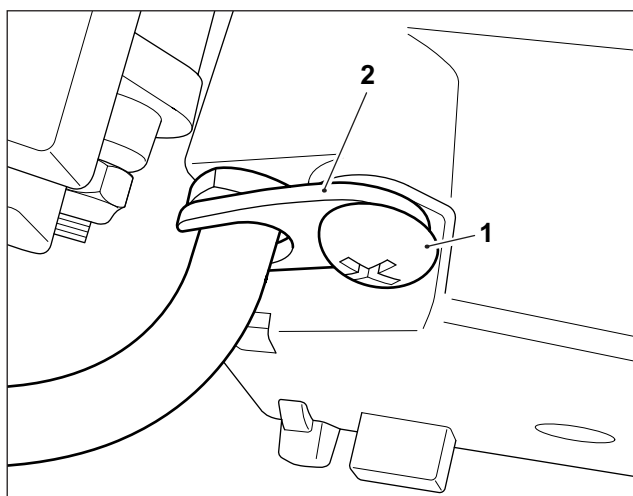

**9** Remove the switch cube (1) from the handlebars. Ensure the switch cube is supported.

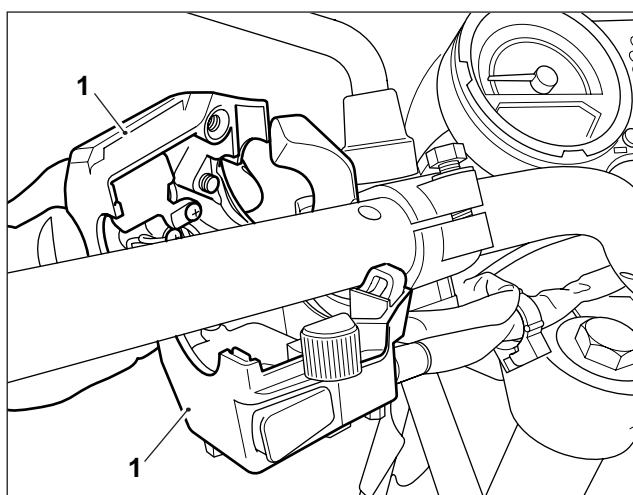

**10** Loosen the clutch lever clamp fixing (1). Do not remove the fixing.

Using a flat bladed screwdriver, or similar tool, carefully lever the clutch lever clamp open, as shown to enable easier removal and fitment of the clutch lever assembly.

 **CAUTION:** Do not use excessive force when using the screwdriver to open the clutch lever clamp. Using excessive force could result in damage to to clutch lever clamp.

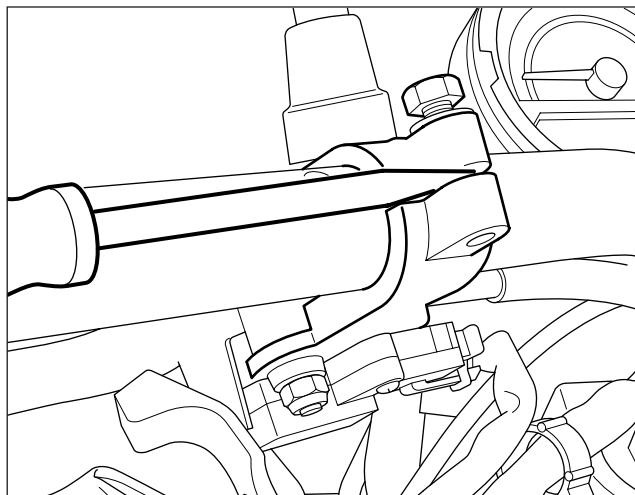

**11** While holding the handlebars (1), remove the handlebar clamp fixings (2). Remove the handlebar clamp (3). Retain the handlebar clamp and fixings for reuse.

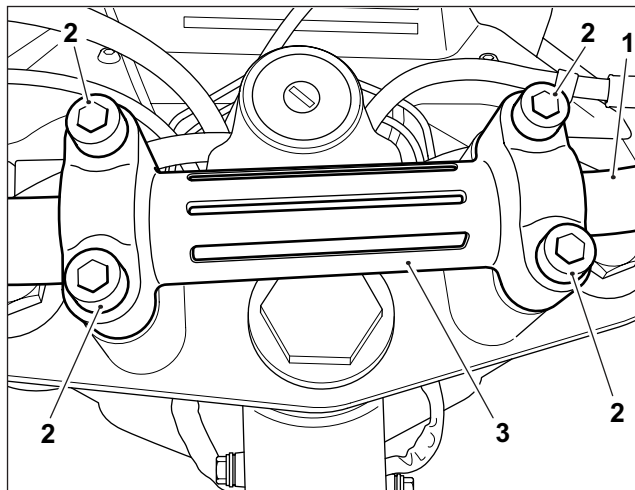

**12** While holding the handlebars (1), carefully slide the clutch lever (2) off the handlebars. Ensure the clutch lever is supported.

Retain the handlebars for reuse if the motorcycle is to be returned to its original condition.

 **CAUTION:** When removing the clutch lever assembly from the handlebars ensure care is taken not to damage the surface finish of the handlebars.

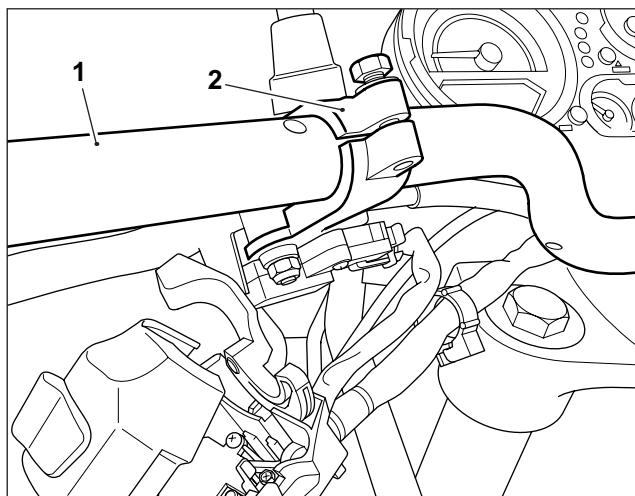

**13** Carefully fit the clutch lever (1) on to the new handlebars (2) from the kit.

 **CAUTION:** When fitting the clutch lever assembly on to the handlebars ensure care is taken not to damage the surface finish of the handlebars.

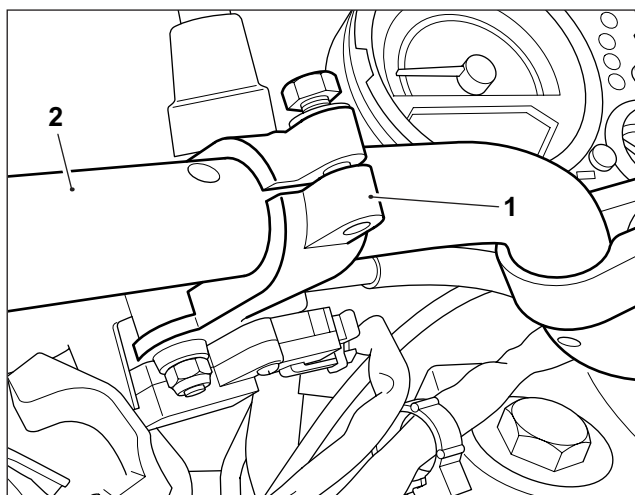

**14** Position the handlebar assembly (1) from the kit centrally on the risers (2). Refit the handlebar clamp (3) in the correct orientation.

**Note:** When correctly fitted the front of the handlebar clamp should rest on the risers and the rear of the handlebar clamp should have a gap between the risers and the handlebar clamp, as shown.

Fit the original fixings (4). Do not fully tighten the fixings at this stage.

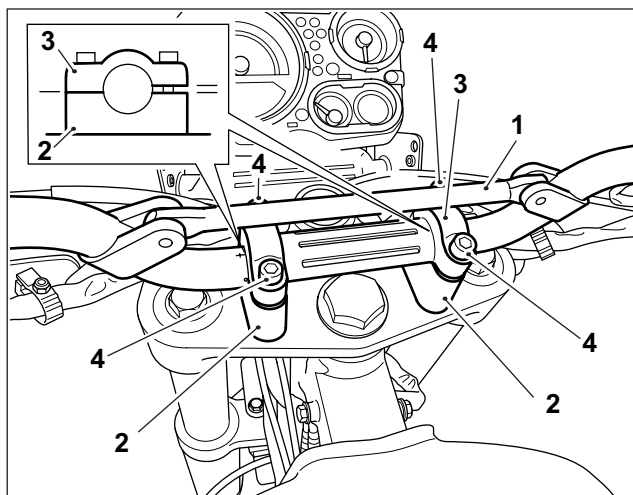

**15** Align the mark (1) on the left hand side of the handlebars with the split line (2) between the handlebar clamp and riser, as shown. Tighten the front handlebar clamp fixings (3) first to **25Nm**, then tighten the rear handlebar clamp fixings (4) to **25Nm**.

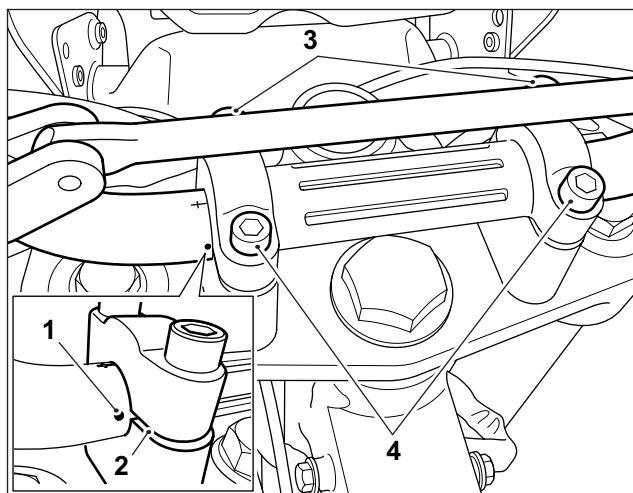

**16** Align the clutch lever clamp split line (1) with the alignment mark (2) on the handlebars, as shown. Tighten the clutch lever clamp fixing (3) to **10Nm**.

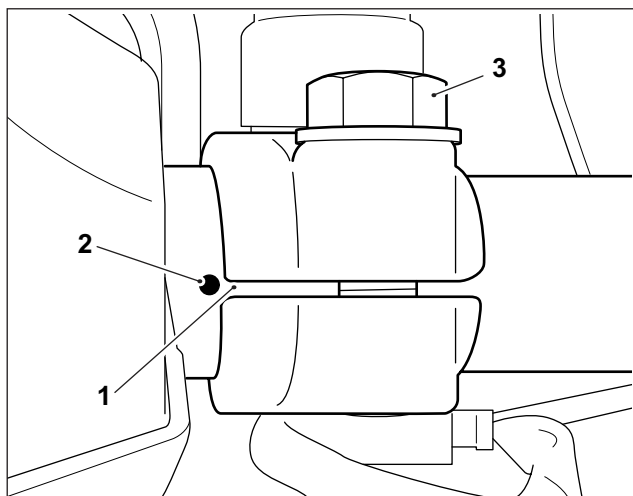

**17** Refit the left hand switch cube assembly ensuring the location peg (1) in the upper switch cube housing correctly locates in the hole (2) in the handlebars.

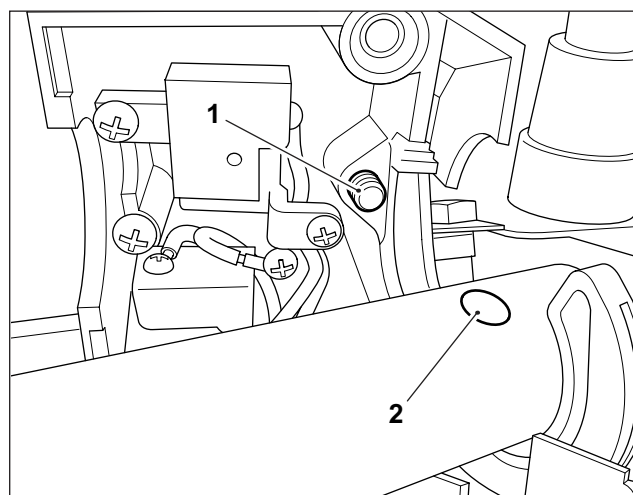

**18** Refit the switch cube fixings (1), front fixing shown, ensuring the retaining plate (2) is located correctly, as shown.  
Tighten the fixings to **1.75Nm**.

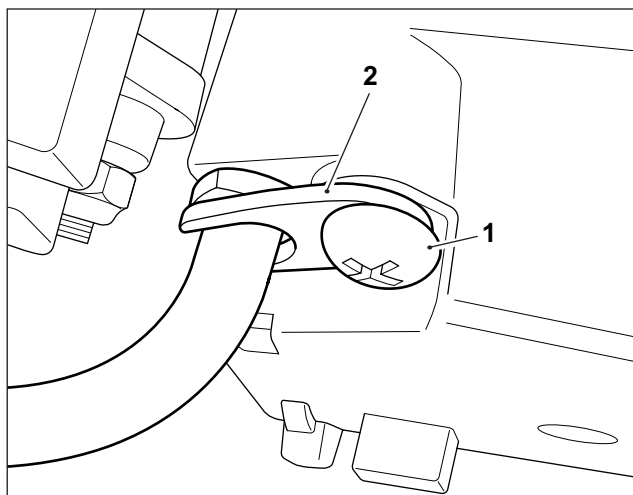

**19** Refit the brake lever and master cylinder assembly (1) to the right hand side of the handlebars. Refit the original clamp (2) and fixings (3).

Align the split line (4) between the brake lever and master cylinder assembly (1) and clamp (2) with the alignment mark (5) on the handlebars, as show.

Tighten the fixings to **10Nm**.

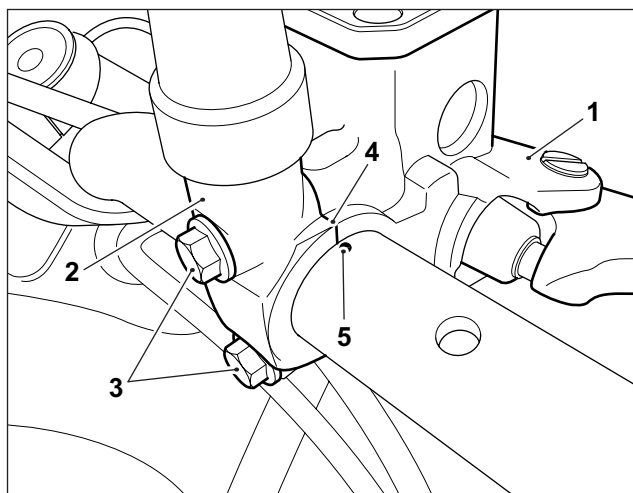

**20** Refit the twist grip (1) on to the right hand side of the handlebars and connect the throttle cable (2) as shown.

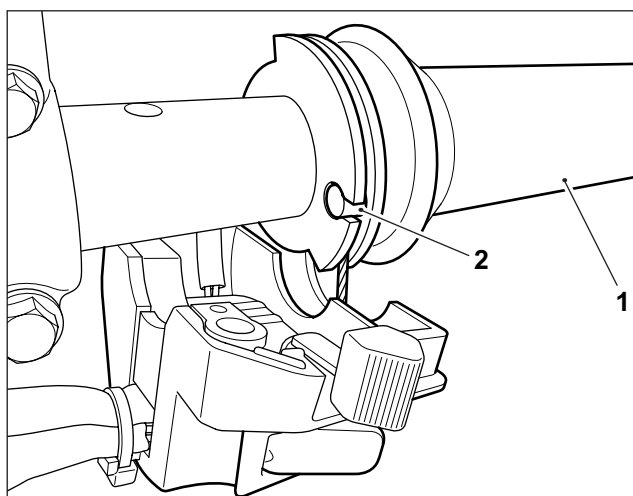

**21** Refit the right hand switch cube assembly ensuring the location peg (1) in the upper switch cube housing correctly locates in the hole (2) in the handlebars.

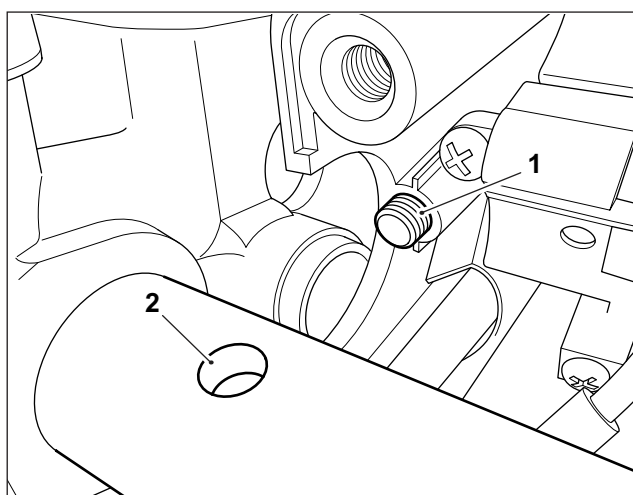

**22** Refit the original switch cube fixings. Note the longer fixing (1) is positioned towards the front of the motorcycle and the shorter fixing (2) is positioned towards the rear of the motorcycle. Tighten the fixings to **1.75Nm**.

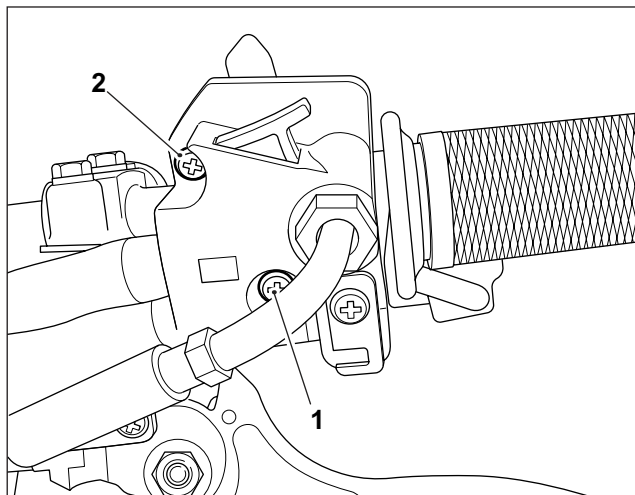

**23** Secure the grip in position with locking wire. A suitable glue should also be used to ensure a secure fit. (if used) Apply glue to the inside surface of the original left hand grip (1) on the handlebar. Ensure the grip is pushed fully on to the handlebars, past the plastic end cap (2) in the handlebars, as shown.

Wrap a loop of wire (3) into the groove at each end of the grip as shown. Pull the wire tight in to the groove and twist the ends of the wires together at the front of the grip, as shown. Trim the end of the twisted wire to leave approximately 10mm remaining. Bend the twisted end of the wire, at approximately 5mm, to 90 degrees (4). Bend the twisted end of the wire into the grip and tap the wire into the grip with a suitable soft faced mallet.

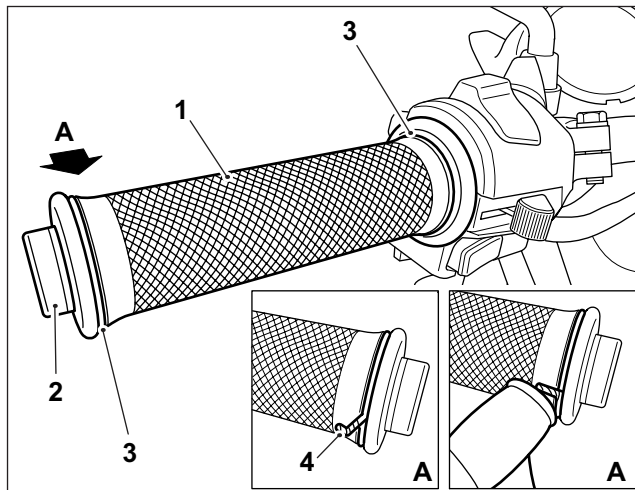

**24** Fit the left hand side and right hand side harness clips (1) into the holes (2) on the underside of the handlebars, right hand side shown.

**25** Reconnect the battery, positive lead first.

**26** Check the operation of both the left hand and right hand switch cube functions.

**27** Check that the twist grip rotates smoothly through its full range of movement and is not restricted in any way. If any tightness or resistance is felt, check and rectify the cause before riding the motorcycle.

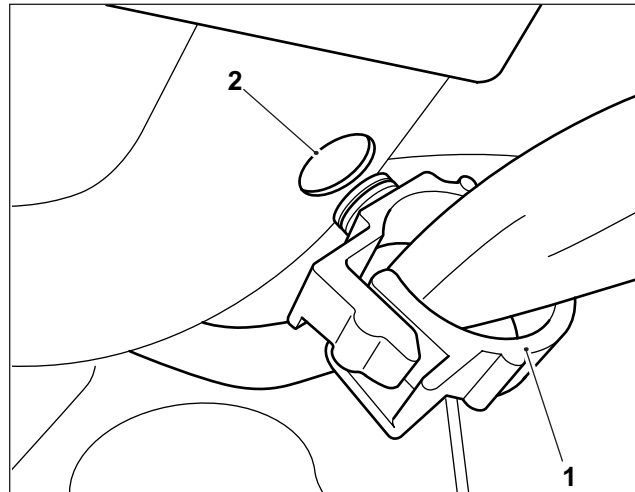

**WARNING:** Ensure that the operation of the twist grip is smooth, without tightness and will return to the throttle closed position when released. A tight or sticking twist grip can lead to loss of motorcycle control and an accident.

**WARNING:** After fitting any genuine Royal Enfield accessory always ride the motorcycle with caution and allow time to become familiar with any change in the motorcycle handling characteristics. Failure to become familiar with any change in the motorcycle handling characteristics may cause the motorcycle to become unstable and result in an accident.