

Part Number:

1990486

1990488

Models:

Continental GT

Interceptor



WARNING: Royal Enfield genuine accessories are designed to fit only the specific Royal Enfield motorcycle(s) that are specified above. They should not be fitted to any other type of motorcycle. Pay particular attention to the warnings and cautions contained in this instruction, failure to do so may result in an incorrect installation of the accessory which could result in an unsafe riding condition and possible accident. If in any doubt always seek help from your authorised Royal Enfield dealer.



WARNING: Before starting any accessory kit installation ensure the motorcycle is supported in a stable condition. Failure to support the motorcycle correctly could lead to motorcycle damage or personal injury.



WARNING: All fixings must be tightened to the torque values specified in this instruction. Failure to tighten fixings to the correct torque could result in an unsafe riding condition and possible accident.



CAUTION: Care should be taken when fitting any accessory kit. Incorrect handling of kit components or the use of incorrect tools could lead to component or motorcycle damage.

NOTE: The content of this instruction is subject to change at any time without notice or liability. Royal Enfield reserves the right to revise the information presented at any time.

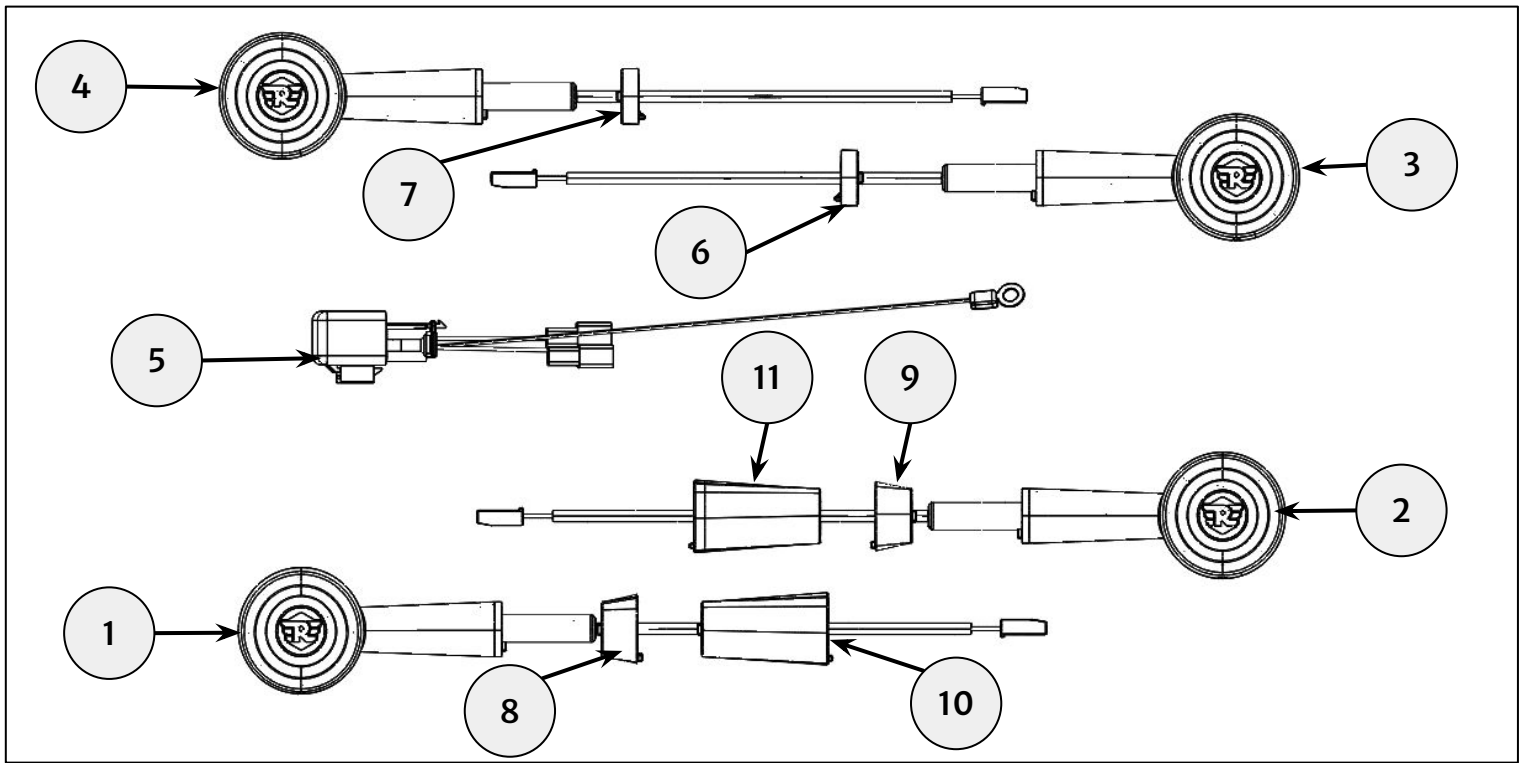

| Item | Description | Qty |
|------|-----------------------------------|-----|
| 1 | Rear Indicator, Left | 1 |
| 2 | Rear Indicator, Right | 1 |
| 3 | Front Indicator, Left | 1 |
| 4 | Front Indicator, Right | 1 |
| 5 | Flasher | 1 |
| 6 | Isolator front, Left | 1 |
| 7 | Isolator front, Right | 1 |
| 8 | Isolator rear, Left - INDIA | 1 |
| 9 | Isolator rear, Right - INDIA | 1 |
| 10 | Isolator rear, Left - EUROPE/USA | 1 |
| 11 | Isolator rear, Right - EUROPE/USA | 1 |

Note: Before starting fitment ensure the ignition is OFF. Use Key to open right side cover and pull the seat lock cable (1) to remove the seat. Open left side cover by removing the fixing (2) and disconnect Negative terminal from the battery, as described in the Owner's Manual.

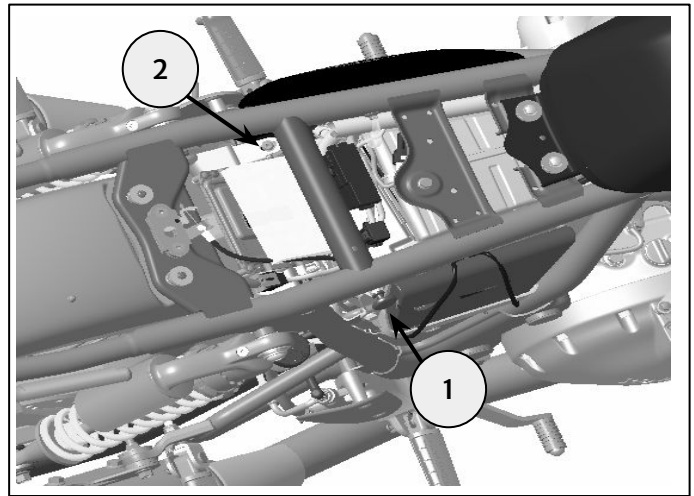

1 Remove Fixings (2) and Washers (3) from rear mud flap (1) as shown to separate the tail tidy assembly from mud flap. Retain fixings and washers for reuse.

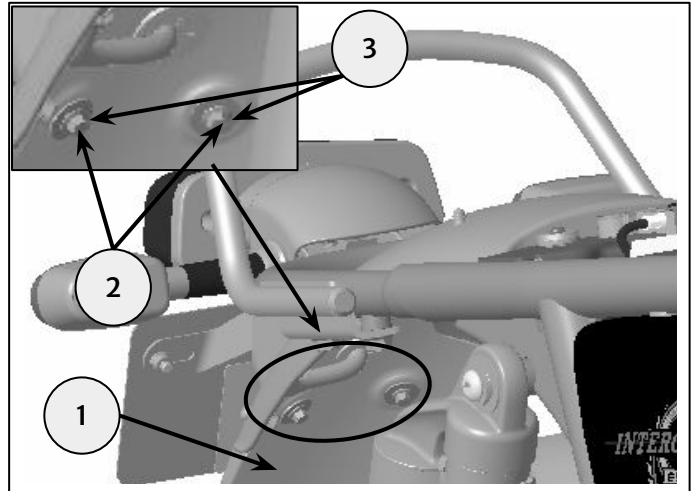
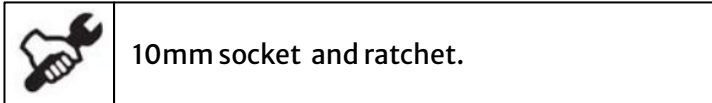

2 Remove fixing and washer set (1) and retain for reuse. This will allow the mud flap (2) to hang.

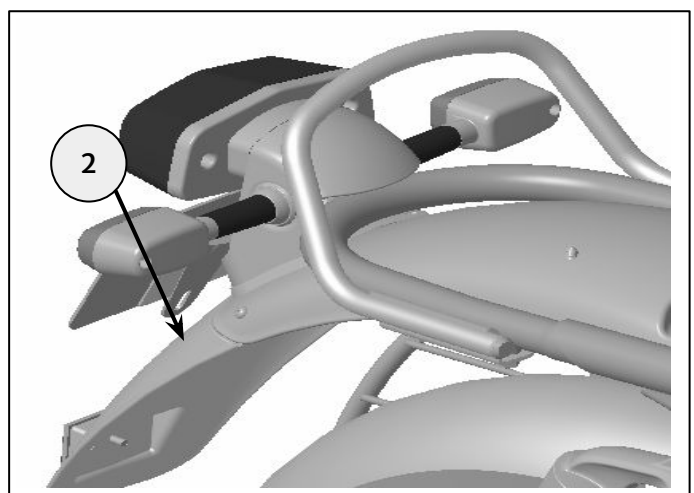
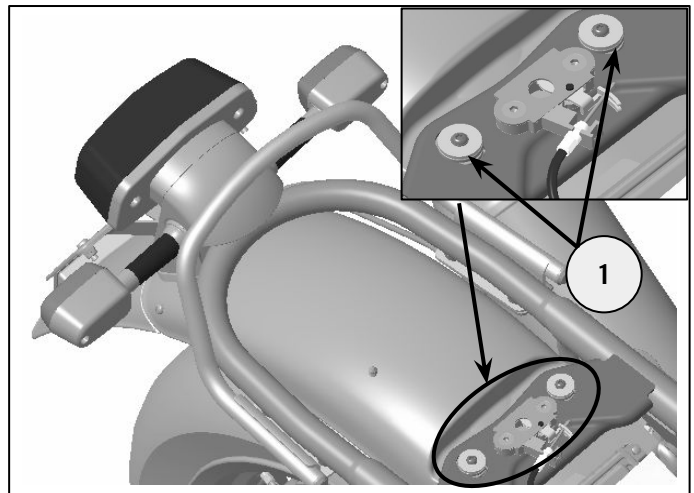
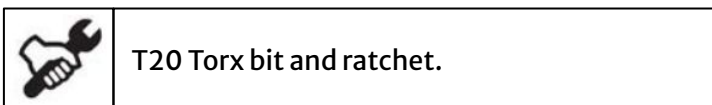

3 Disconnect tail lamp and Indicator harness (1) from vehicle harness (2).

Remove fixings (3) and nuts (4) to remove the tail tidy housing (5) and mounting bracket assembly (6) from vehicle subframe (7). Retain fixings and nuts for reuse.

Note : Use 8mm spanner to hold the fixing between number plate and tail tidy housing.



10mm socket and ratchet.
8mm spanner.

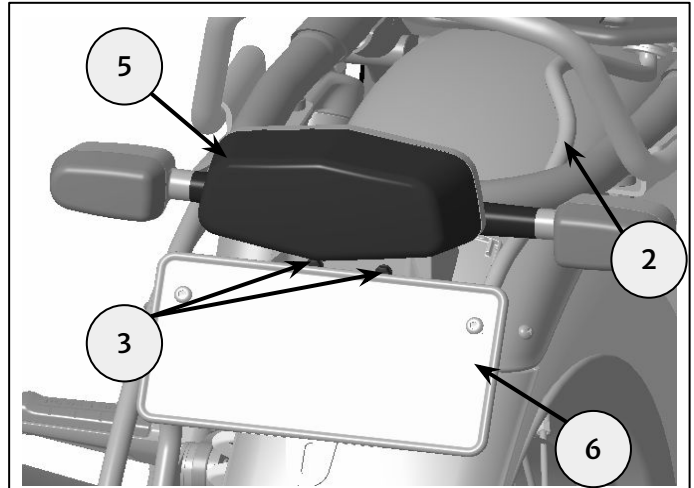
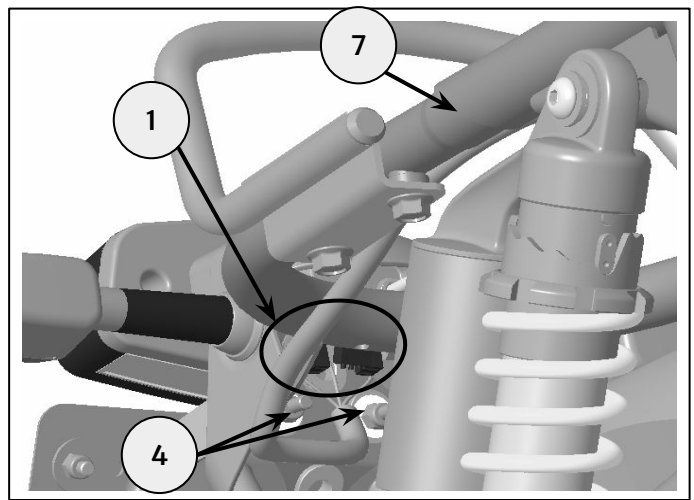

4 Remove Indicators (1) by removing adapter and washer set (2) from tail lamp housing (3). Retain adapter and washer set for reuse.



19mm spanner.

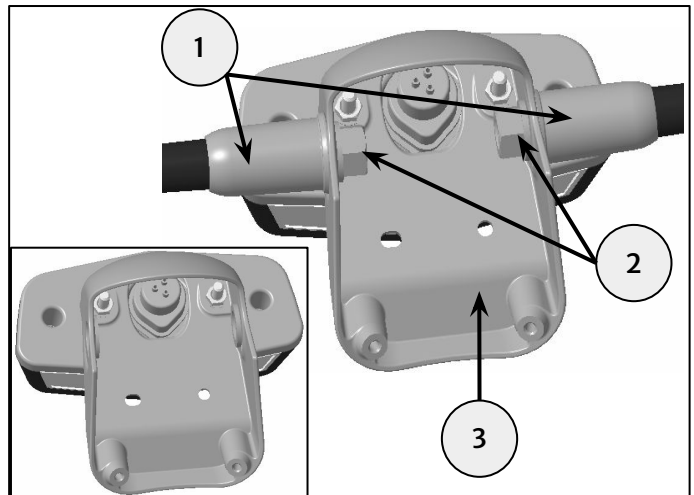

5 From kit use Rear Indicator, Left (1) and Isolator, rear Indicator, left (2) depends on region, insert both as shown. A slot and projection is provided to ensure orientation.

Note: Isolator for India will be short, while for Europe/USA will be little longer as shown.

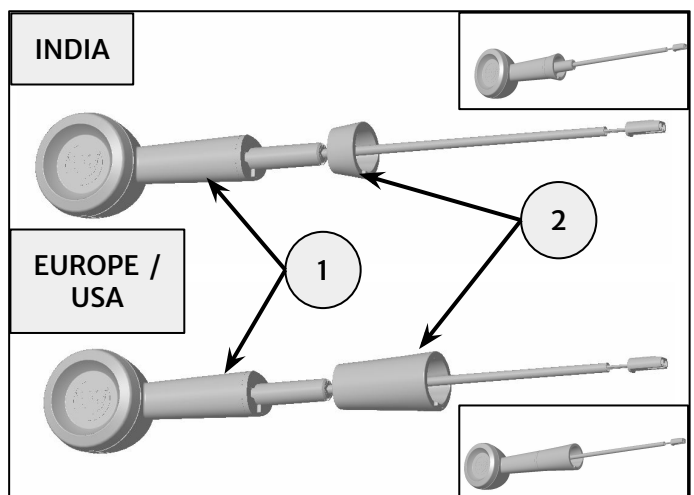

6 Repeat step 5 for Right side using Rear Indicator (1), and Isolator, rear Indicator right (2) from the kit, depends on region,as shown.

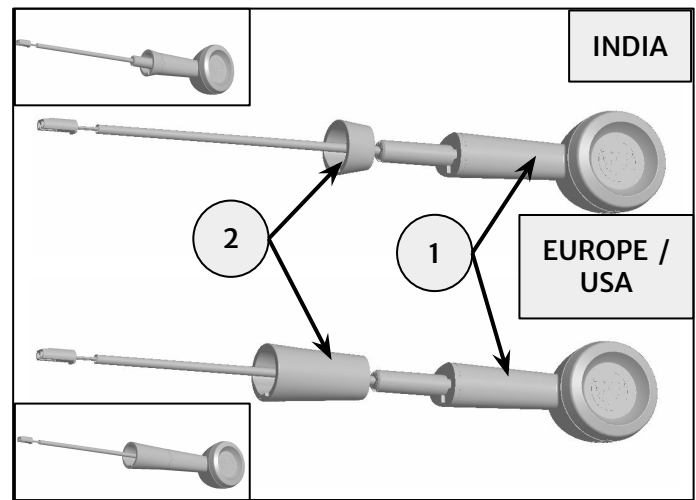

7 Assemble Rear Indicator, right assembly (1) with tail lamp housing (2) using adapter and washer set (3) retained from step 4 as shown and tighten to **6Nm**.

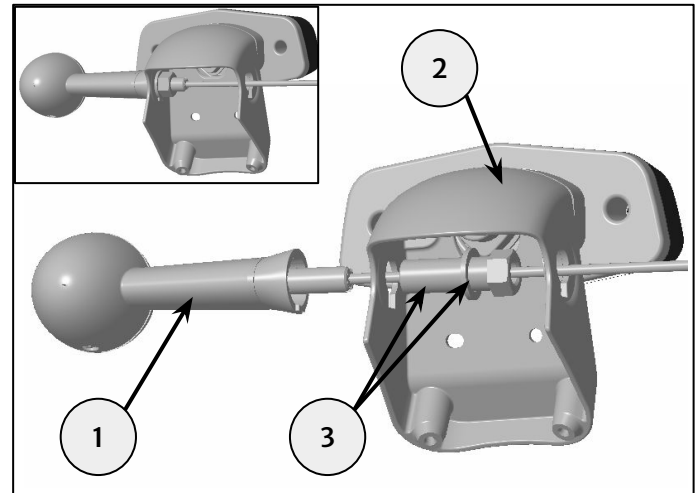
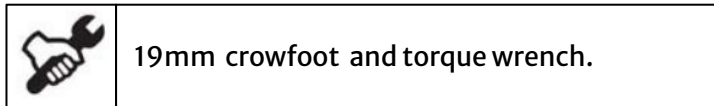

8 Repeat step 7 for right side.

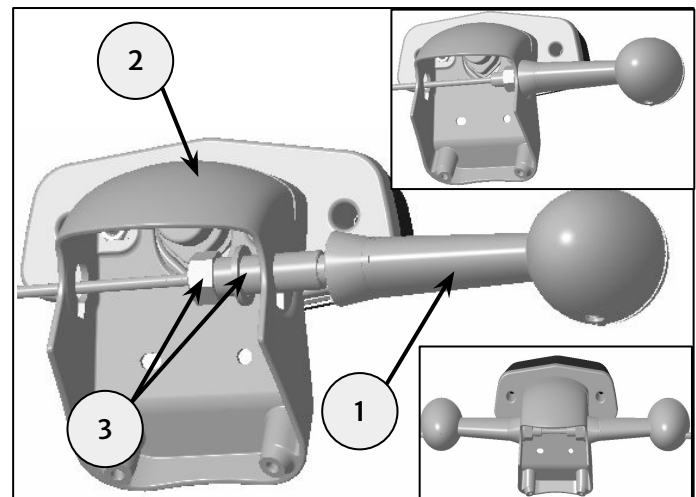

9 Connect 3 pin Tail lamp harness connector (1) to 3 pin vehicle harness connector, then Connect 2 pin Indicator connectors (2) with vehicle harness connector (3) by matching the colour black to black and white to white .

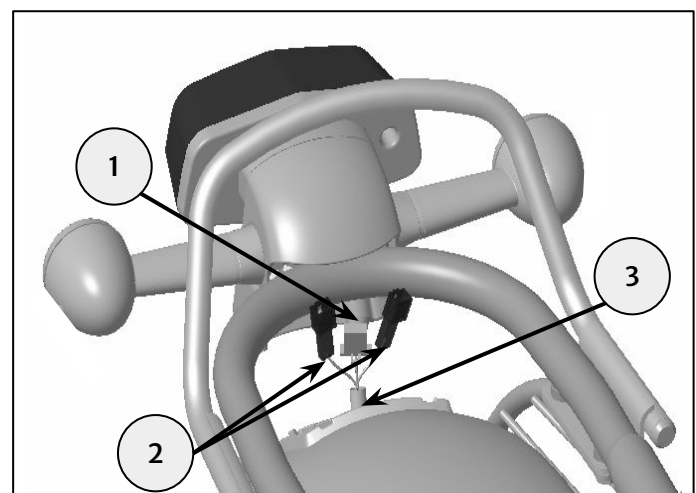

10 Reuse fixings (1) and nuts (2) from step 3 to assemble the tail tidy housing (3) and mounting bracket assembly (4) to vehicle subframe (5) as shown. Tighten to **10Nm**.

Note : Use 8mm spanner to hold the fixing between number plate and tail tidy housing.



10mm socket and Torque wrench.
8mm spanner.

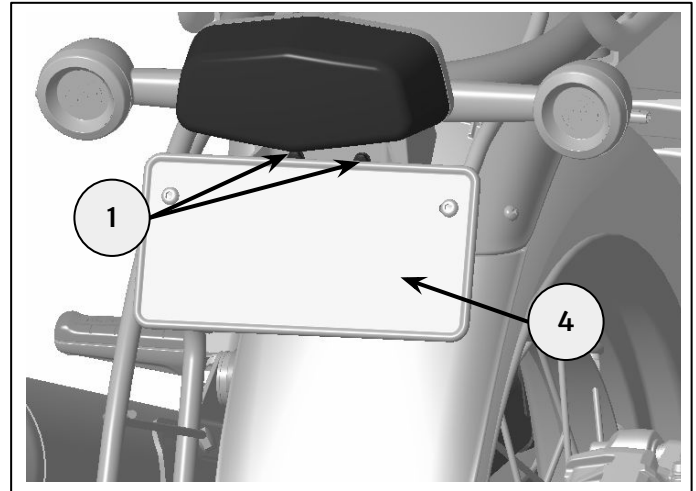
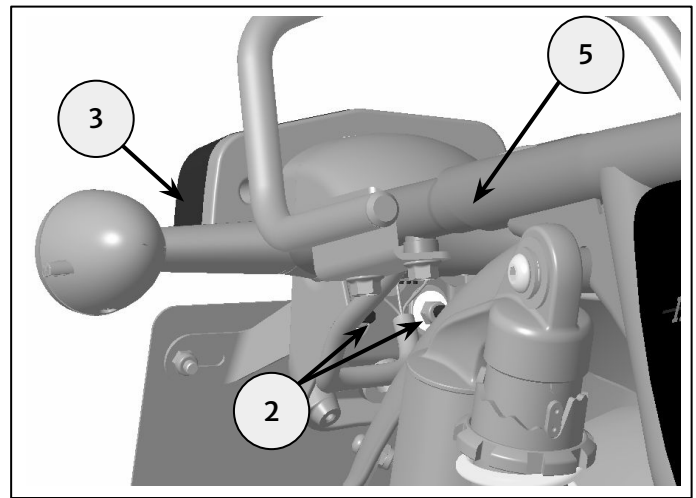

11 Reuse fixings (2) and washers (3) from step 2 to secure the rear mud flap (1) with vehicle as shown. Tighten to **1.5 Nm**.



T20 Torx bit and Torque wrench.

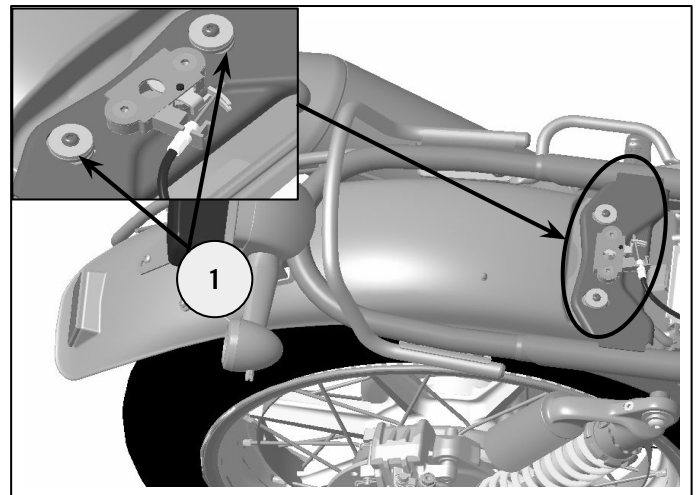

12 Reuse fixings (2) and washers (3) from step 1 to secure the Tail tidy housing with rear mud flap (1) as shown. Tighten to **7Nm**.



10mm socket and Torque wrench.

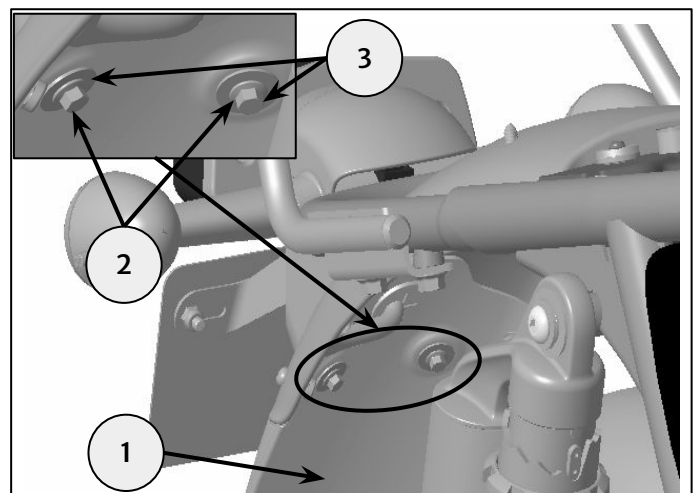

13 On the Front, Remove fixing (1) on both side to slightly pull out the headlight housing (2). Retain the fixings for reuse.

Note : For Halogen lamp, refer Owner's Manual.



Phillips screwdriver.

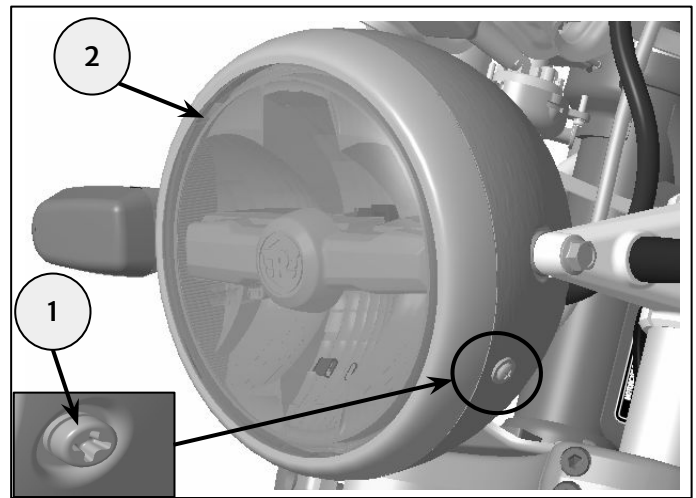

14 Remove fixing (1) on both side and pull out the connector retention plate (2) and disconnect the indicator harness from vehicle harness, retain all for reuse.

Note : For Halogen lamp, refer Owner's Manual.



Phillips screwdriver.

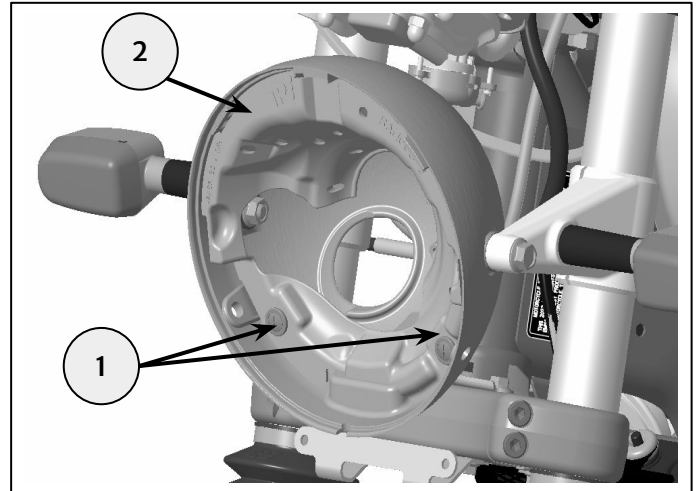

15 Remove fixing (1) on both side and allow headlamp housing to hang as it is, to facilitate access for indicator removal. Retain fixing for reuse.



12mm socket and wrench.

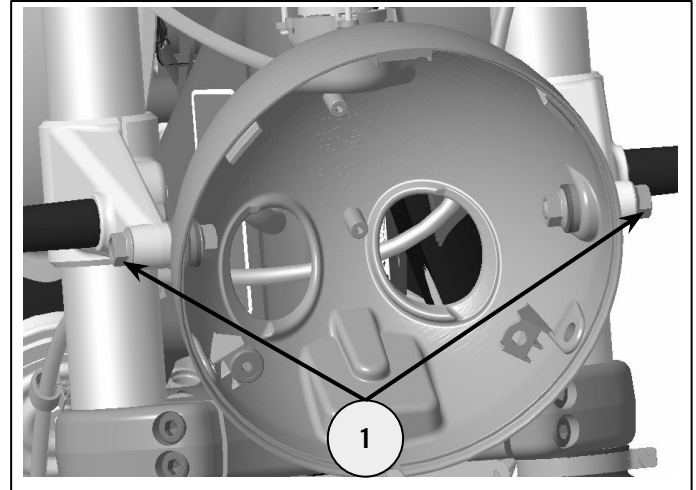

16 Remove nut (1) on both side to remove indicators (2) from vehicle as shown, Retain nut for reuse.



19mm socket and wrench / 19mm spanner.

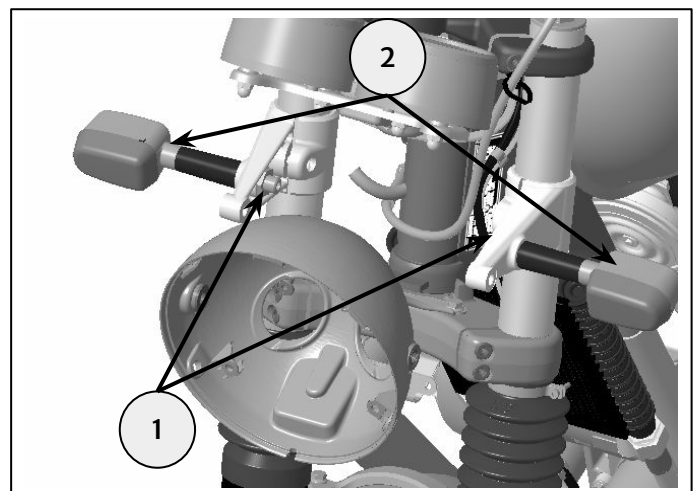

17 From kit use Front Indicator, Right (1) and Isolator, front Indicator, right (2), insert both as shown. A slot and projection is provided to ensure orientation.

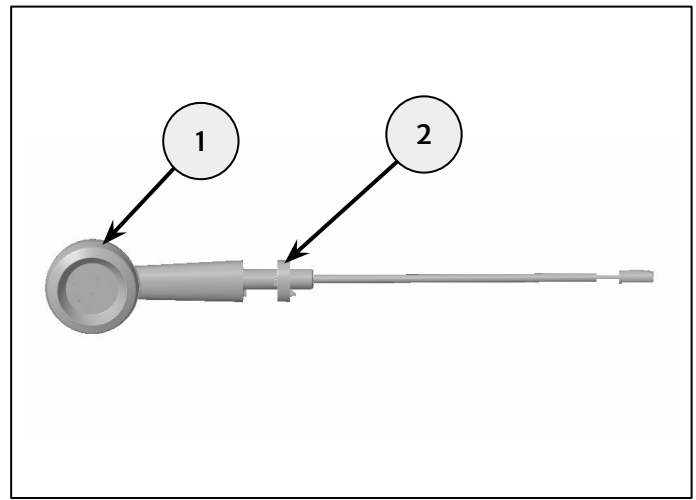

18 Repeat step 17 for Left side using left Indicator (1), and Isolator, front Indicator left (2) from the kit.

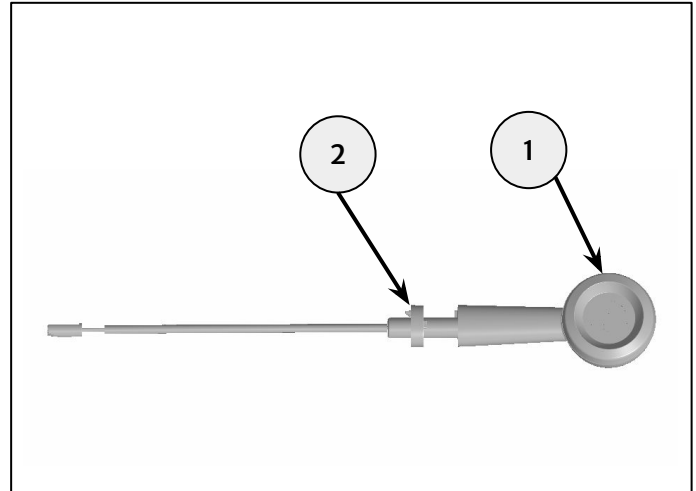

19 Use LED indicator assembly, right from step 17, re-use nut from step 16, position indicator using the anti rotate feature in the isolator as shown, and tighten to 6Nm.

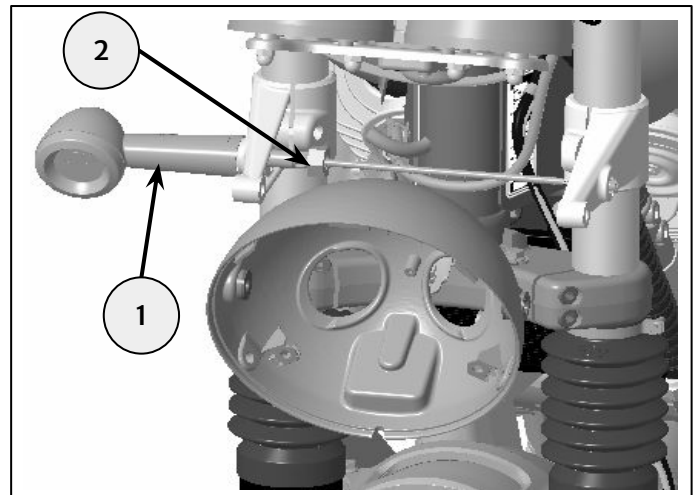
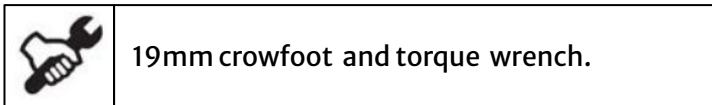

20 Repeat step 19 for left side, using LED indicator assembly, left from step 18 by reusing nut from step 15.

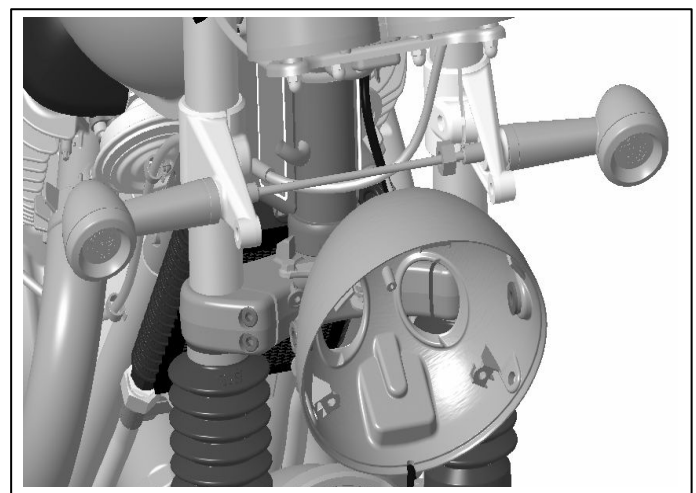

21 Reuse fixing (1) retained from step 15, to mount the headlamp housing (2) with headlamp holder(3) as shown. Tighten to 25 Nm.

Note : For Halogen lamp, refer Owner's Manual.



12mm socket and torque wrench.

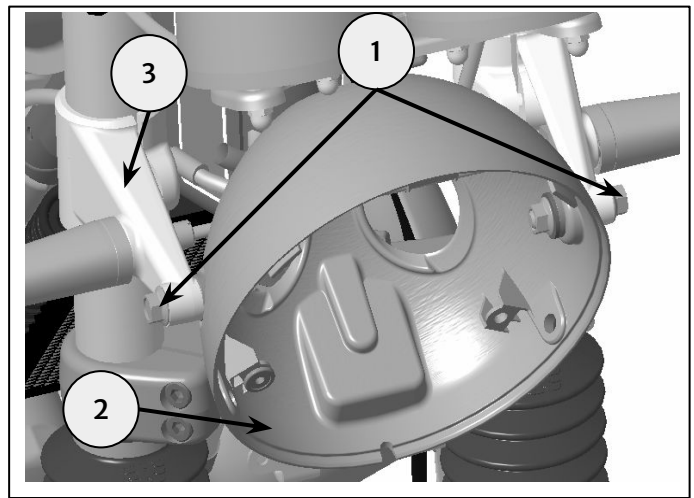

22 Connect the LED Indicator connectors with vehicle harness connector by matching the colour black to black and white to white. From step 14 reuse connector retention plate (1) and fixing (2), fix it with headlamp housing (3) as shown.

Note : For Halogen lamp, refer Owner's Manual.



Phillips screwdriver.

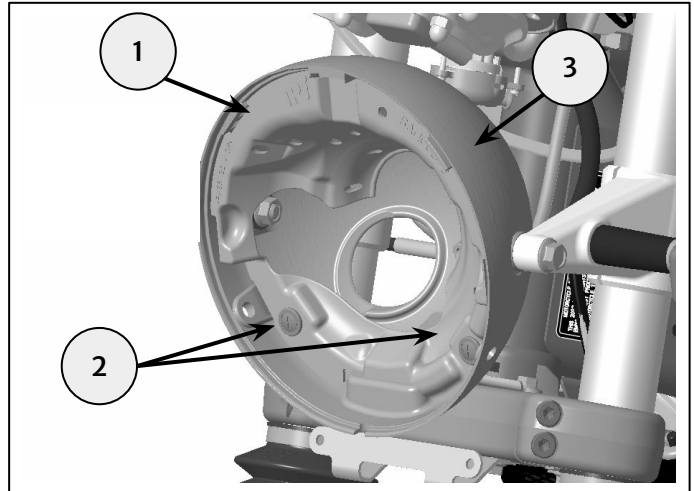

23 Insert headlamp assembly(1) to headlamp housing assembly (2) as shown, reuse the fixings (3) retained from step 13 and hand tighten plus one half turn of screwdriver.

Note : For Halogen lamp, refer Owner's Manual.



Phillips screwdriver.

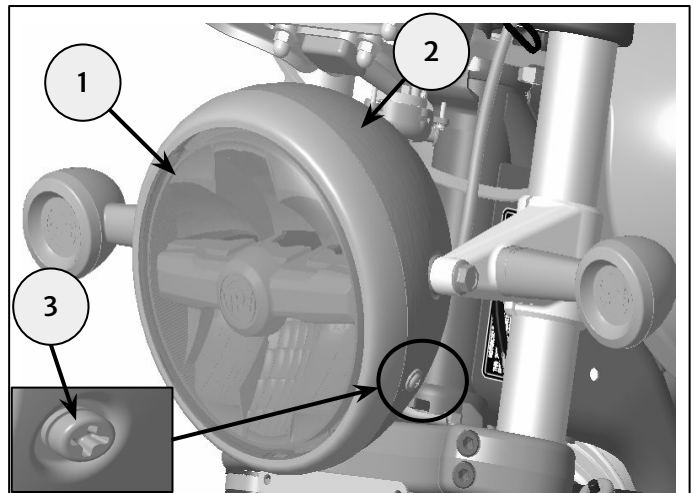

24 Replace the existing flasher unit (1) using the flasher unit from the kit, and connect the extension negative terminal to battery.



Phillips screwdriver / 10mm socket and ratchet.

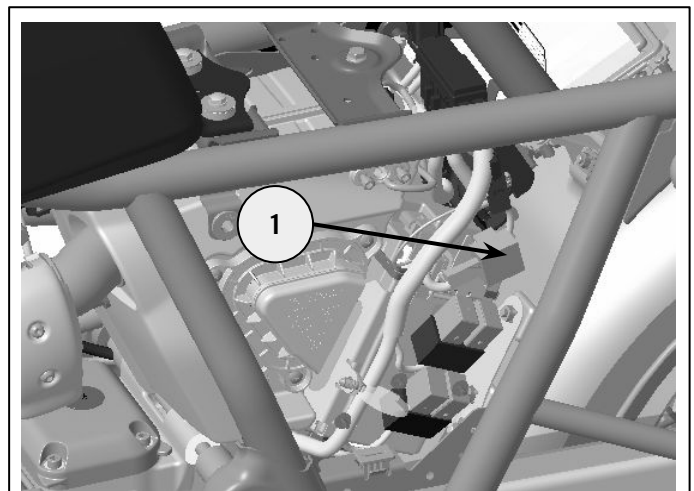

25 Reconnect negative terminal to battery. Insert and lock right and left side cover then assemble seat in position, as described in the Owner's Manual.

Note: Before closing side cover check the tail light, braking lights and indicators are functioning correctly.

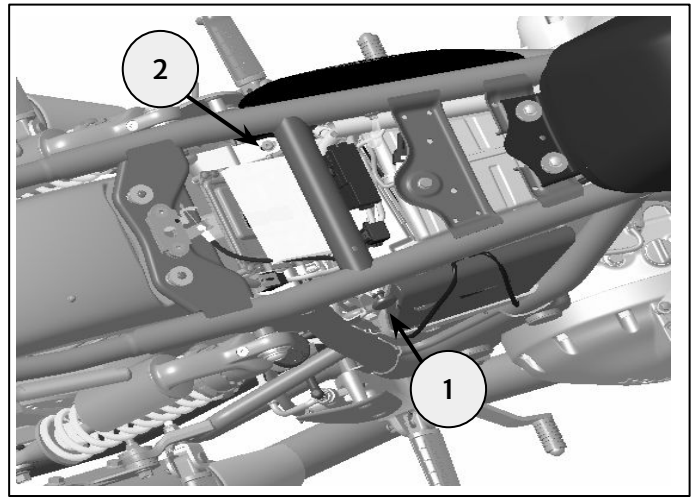

WARNING: After fitting any genuine Royal Enfield accessory always ride the motorcycle with caution and allow time to become familiar with any change in the motorcycle handling characteristics. Failure to become familiar with any change in the motorcycle handling characteristics may cause the motorcycle to become unstable and result in an accident.